







- **CILINDRI DA APPLICARE**
RIM CYLINDERS  P. 41
- **CILINDRI DA INFILARE**
MORTICE CYLINDERS  P. 42
- **CILINDRI DA INFILARE CON RINFORZO E
TAGLIO ANTITORSIONE BREVETTATO**
MORTICE CYLINDERS WITH PATENTED
REINFORCE AND CUT AGAINST BREAKING  P. 46
- **CILINDRI OVALI (SOLO 5 PERNI)**
OVAL CYLINDERS (ONLY 5 PINS)  P. 50
- **CILINDRI Ø 26 (15 PERNI)**
Ø 26 CYLINDERS (15 PINS)  P. 50
- **CILINDRI Ø 22 (SOLO 5 PERNI)**
Ø 22 CYLINDERS (ONLY 5 PINS)  P. 50
- **LUCCHETTO**
PADLOCK  P. 51

- ✓ **Sistema a 15 perni attivi**
System with 15 active pins
- ✓ **Corpo in ottone nichelato**
Nickel plated brass body
- ✓ **Perni in acciaio temprato**
Hardened steel pins
- ✓ **Controperni in acciaio inox**
Stainless steel top pins
- ✓ **Molle in acciaio inox**
Stainless steel springs
- ✓ **Camma DIN 30° (cilindri da infilare)**
DIN 30° cam (mortice cylinders)
- ✓ **3 chiavi reversibili in alpacca con impugnatura rivestita in plastica, collo lungo e numerazione a codice indiretto sulla testa**
3 reversible keys in nickel silver with plastic-coated grip, long neck numbered on key head
- ✓ **Code card**
Code card
- ✓ **Vite di fissaggio**
Fixing screw



H23

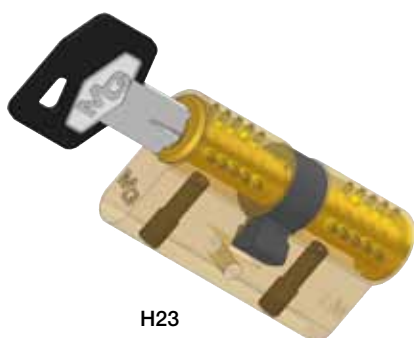
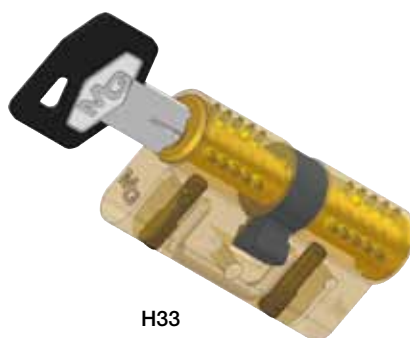

H33

Cilindro per art. 711
Cylinder for art. 711

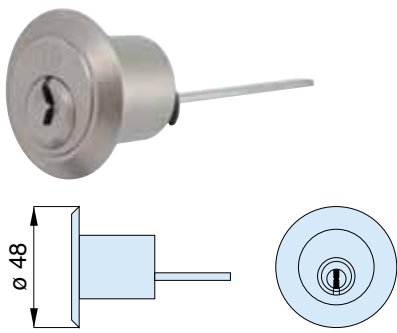

HS

↓	A	B	C	D	L	codice code	euro		
15						H11000 N00		1	
	con 5 chiavi with 5 keys					N50		

Cilindro per art. 712
Cylinder for art. 712

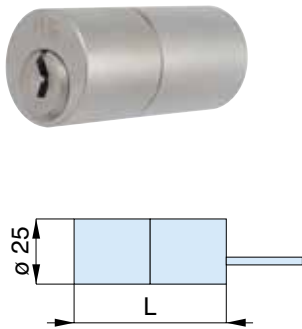

HS

↓	A	B	C	D	L	codice code	euro		
15					50	H12500 N00		1	
	con 5 chiavi with 5 keys					N50		

Coppia cilindri
Double rim cylinders

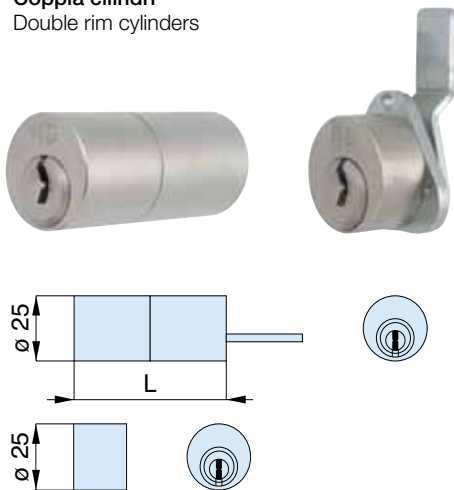

HS

↓	A	B	C	D	L	codice code	euro		
15					50	H14500 N00		1	
	con 5 chiavi with 5 keys					N50		

Coppia cilindri
Double rim cylinders

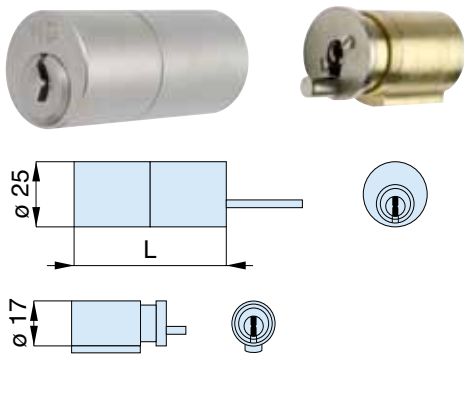

HS

↓	A	B	C	D	L	codice code	euro		
15					50	H14501 N00		1	
	con 5 chiavi with 5 keys					N50		



CILINDRI DI SICUREZZA DA APPLICARE
security rim cylinders



Doppio cilindro
Double cylinder



HS

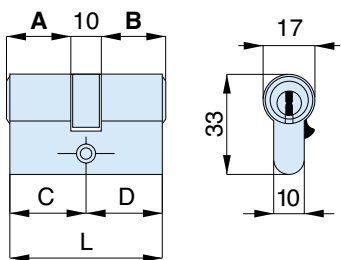

↓	A	B	C	D	L	codice code	euro	📄
15	27	10	27	31	31	62	H23640 N00	1
15	27	10	31	31	35	66	H23680 N00	1
15	31	10	31	35	35	70	H23720 N00	1
15	27	10	37	31	41	72	H23740 N00	1
15	27	10	41	31	45	76	H23781 N00	1
15	31	10	37	35	41	76	H23782 N00	1
15	31	10	41	35	45	80	H23820 N00	1
15	27	10	47	31	51	82	H23841 N00	1
15	37	10	37	41	41	82	H23842 N00	1
15	27	10	51	31	55	86	H23881 N00	1
15	31	10	47	35	51	86	H23882 N00	1
15	37	10	41	41	45	86	H23883 N00	1
15	31	10	51	35	55	90	H23921 N00	1
15	41	10	41	45	45	90	H23922 N00	1
15	27	10	57	31	61	92	H23941 N00	1
15	37	10	47	41	51	92	H23942 N00	1
15	37	10	51	41	55	96	H23981 N00	1
15	41	10	47	45	51	96	H23982 N00	1
15	31	10	57	35	61	96	H23983 N00	1
15	41	10	51	45	55	100	H23020 N00	1
15	27	10	67	31	71	102	H23041 N00	1
15	37	10	57	41	61	102	H23042 N00	1
15	47	10	47	51	51	102	H23043 N00	1
15	27	10	77	31	81	112	H23141 N00	1
15	37	10	67	41	71	112	H23142 N00	1
15	47	10	57	51	61	112	H23143 N00	1
15	47	10	67	51	71	122	H23243 N00	1

con 5 chiavi with 5 keys

..... N50

frizionato frictioned

..... NOX

CILINDRI DI SICUREZZA DA INFILARE
security mortice cylinders

Mezzo cilindro con camma regolabile in 8 posizioni
Half cylinder with adjustable cam in 8 positions



HS

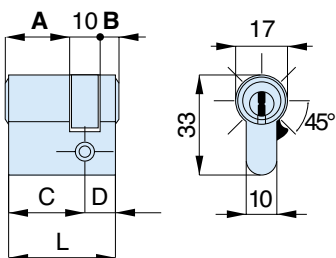

↓	A	B	C	D	L	codice code	euro	📄
15	27	10	5	31	10	41	H24420 N00	1
15	31	10	5	35	10	45	H24460 N00	1
15	37	10	5	41	10	51	H24520 N00	1
15	41	10	5	45	10	55	H24560 N00	1
15	47	10	5	51	10	61	H24620 N00	1
15	57	10	5	61	10	71	H24720 N00	1
15	67	10	5	71	10	81	H24820 N00	1
15	77	10	5	81	10	91	H24920 N00	1

con 5 chiavi with 5 keys

..... N50

Mezzo cilindro per lucchetto di sicurezza H92 - nickel opaco
 Half cylinder for security padlock H92 - matt nickel



HS

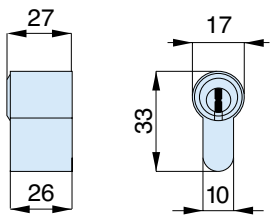

	A	B	C	D	L	codice code	euro	
15						H24270 N00		1
	con 5 chiavi with 5 keys					 N50	

Doppio cilindro con pomolo ottone nichelato opaco
 Double cylinder with matt nickel-plated brass knob



HS

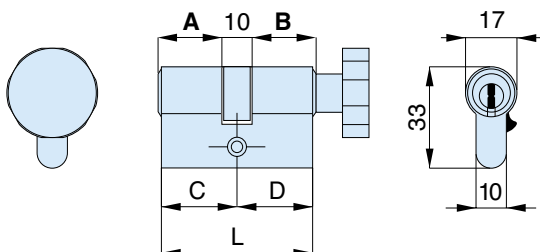

	A	B	C	D	L	codice code	euro	
15	27	10	27	31	31	62	H29640 NOR	1
15	27	10	31	31	35	66	H29681 NOR	1
15	31	10	27	35	31	66	H29682 NOR	1
15	31	10	31	35	35	70	H29720 NOR	1
15	27	10	37	31	41	72	H29741 NOR	1
15	37	10	27	41	31	72	H29742 NOR	1
15	27	10	41	31	45	76	H29781 NOR	1
15	41	10	27	45	31	76	H29782 NOR	1
15	31	10	37	35	41	76	H29783 NOR	1
15	37	10	31	41	35	76	H29784 NOR	1
15	31	10	41	35	45	80	H29821 NOR	1
15	41	10	31	45	35	80	H29822 NOR	1
15	27	10	47	31	51	82	H29841 NOR	1
15	47	10	27	51	31	82	H29842 NOR	1
15	37	10	37	41	41	82	H29843 NOR	1
15	27	10	51	31	55	86	H29881 NOR	1
15	31	10	47	35	51	86	H29882 NOR	1
15	37	10	41	41	45	86	H29883 NOR	1
15	41	10	37	45	41	86	H29884 NOR	1
15	31	10	51	35	55	90	H29921 NOR	1
15	41	10	41	45	45	90	H29922 NOR	1
15	27	10	57	31	61	92	H29941 NOR	1
15	37	10	47	41	51	92	H29942 NOR	1
15	37	10	51	41	55	96	H29981 NOR	1
15	41	10	47	45	51	96	H29982 NOR	1
15	41	10	51	45	55	100	H29020 NOR	1
15	27	10	67	31	71	102	H29041 NOR	1
15	37	10	57	41	61	102	H29042 NOR	1
15	47	10	47	51	51	102	H29043 NOR	1
15	27	10	77	31	81	112	H29141 NOR	1
15	37	10	67	41	71	112	H29142 NOR	1
15	47	10	57	51	61	112	H29143 NOR	1
	con 5 chiavi with 5 keys					 N5R	

CILINDRI DI SICUREZZA DA INFILARE
security mortice cylinders



Doppio cilindro con pomolo ottone nichelato opaco
 Double cylinder with matt nickel-plated brass knob



HS

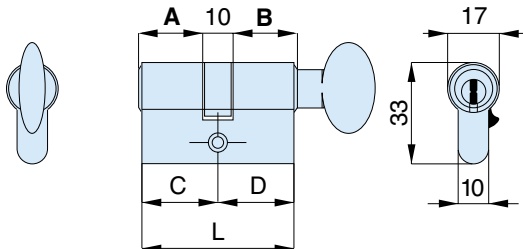

CILINDRI DI SICUREZZA DA INFILARE
security mortice cylinders

	A	B	C	D	L	codice code	euro		
15	27	10	27	31	31	62	H29640	N0F	1
15	27	10	31	31	35	66	H29681	N0F	1
15	31	10	27	35	31	66	H29682	N0F	1
15	31	10	31	35	35	70	H29720	N0F	1
15	27	10	37	31	41	72	H29741	N0F	1
15	37	10	27	41	31	72	H29742	N0F	1
15	27	10	41	31	45	76	H29781	N0F	1
15	41	10	27	45	31	76	H29782	N0F	1
15	31	10	37	35	41	76	H29783	N0F	1
15	37	10	31	41	35	76	H29784	N0F	1
15	31	10	41	35	45	80	H29821	N0F	1
15	41	10	31	45	35	80	H29822	N0F	1
15	27	10	47	31	51	82	H29841	N0F	1
15	47	10	27	51	31	82	H29842	N0F	1
15	37	10	37	41	41	82	H29843	N0F	1
15	27	10	51	31	55	86	H29881	N0F	1
15	31	10	47	35	51	86	H29882	N0F	1
15	37	10	41	41	45	86	H29883	N0F	1
15	41	10	37	45	41	86	H29884	N0F	1
15	31	10	51	35	55	90	H29921	N0F	1
15	41	10	41	45	45	90	H29922	N0F	1
15	27	10	57	31	61	92	H29941	N0F	1
15	37	10	47	41	51	92	H29942	N0F	1
15	37	10	51	41	55	96	H29981	N0F	1
15	41	10	47	45	51	96	H29982	N0F	1
15	41	10	51	45	55	100	H29020	N0F	1
15	27	10	67	31	71	102	H29041	N0F	1
15	37	10	57	41	61	102	H29042	N0F	1
15	47	10	47	51	51	102	H29043	N0F	1
15	27	10	77	31	81	112	H29141	N0F	1
15	37	10	67	41	71	112	H29142	N0F	1
15	47	10	57	51	61	112	H29143	N0F	1

con 5 chiavi with 5 keys

..... N5F

Doppio cilindro predisposto pomolo
Double cylinder with knob provision



HS

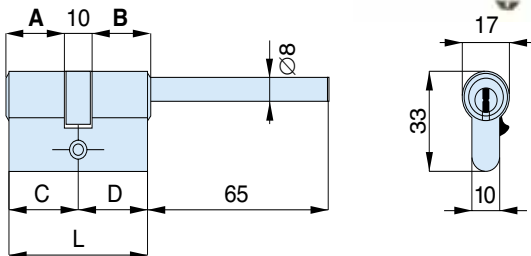

▽	A	B	C	D	L	codice code	euro	
15	27	10	27	31	31	62	H29640 NOL	1
15	31	10	27	35	31	66	H29680 NOL	1
15	37	10	27	41	31	72	H29740 NOL	1
15	41	10	27	45	31	76	H29780 NOL	1
15	47	10	27	51	31	82	H29840 NOL	1
15	51	10	27	55	31	86	H29880 NOL	1
15	57	10	27	61	31	92	H29940 NOL	1
15	67	10	27	71	31	102	H29040 NOL	1
15	77	10	27	81	31	112	H29140 NOL	1

con 5 chiavi with 5 keys

..... N5L

Doppio cilindro predisposto pomolo
Double cylinder with knob provision



HS

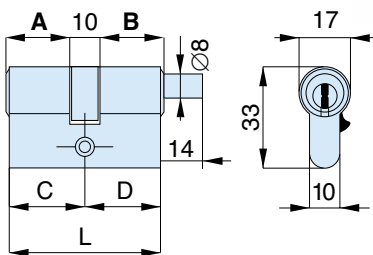

▽	A	B	C	D	L	codice code	euro	
15	27	10	27	31	31	62	H29640 NOC	1
15	27	10	31	31	35	66	H29681 NOC	1
15	31	10	27	35	31	66	H29682 NOC	1
15	31	10	31	35	35	70	H29720 NOC	1
15	27	10	37	31	41	72	H29741 NOC	1
15	37	10	27	41	31	72	H29742 NOC	1
15	27	10	41	31	45	76	H29781 NOC	1
15	41	10	27	45	31	76	H29782 NOC	1
15	31	10	37	35	41	76	H29783 NOC	1
15	37	10	31	41	35	76	H29784 NOC	1
15	31	10	41	35	45	80	H29821 NOC	1
15	41	10	31	45	35	80	H29822 NOC	1
15	27	10	47	31	51	82	H29841 NOC	1
15	47	10	27	51	31	82	H29842 NOC	1
15	37	10	37	41	41	82	H29843 NOC	1
15	27	10	51	31	55	86	H29881 NOC	1
15	31	10	47	35	51	86	H29882 NOC	1
15	37	10	41	41	45	86	H29883 NOC	1
15	41	10	37	45	41	86	H29884 NOC	1
15	31	10	51	35	55	90	H29921 NOC	1
15	41	10	41	45	45	90	H29922 NOC	1
15	27	10	57	31	61	92	H29941 NOC	1
15	37	10	47	41	51	92	H29942 NOC	1
15	37	10	51	41	55	96	H29981 NOC	1
15	41	10	47	45	51	96	H29982 NOC	1
15	41	10	51	45	55	100	H29020 NOC	1
15	27	10	67	31	71	102	H29041 NOC	1
15	37	10	57	41	61	102	H29042 NOC	1
15	47	10	47	51	51	102	H29043 NOC	1
15	27	10	77	31	81	112	H29141 NOC	1
15	37	10	67	41	71	112	H29142 NOC	1
15	47	10	57	51	61	112	H29143 NOC	1

con 5 chiavi with 5 keys

..... N5C





Doppio cilindro con rinforzo e taglio
Double cylinder with reinforce and cut



HS

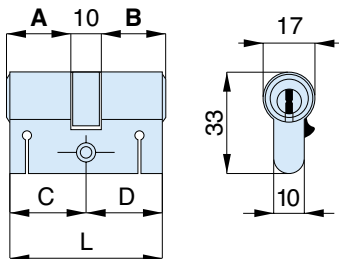

CILINDRI DI SICUREZZA DA INFILARE
security mortice cylinders

↓	A	B	C	D	L	codice code	euro	✎	📦
15	27	10	27	31	31	62	H33640 N00		1
15	27	10	31	31	35	66	H33680 N00		1
15	31	10	31	35	35	70	H33720 N00		1
15	27	10	37	31	41	72	H33740 N00		1
15	27	10	41	31	45	76	H33781 N00		1
15	31	10	37	35	41	76	H33782 N00		1
15	31	10	41	35	45	80	H33820 N00		1
15	27	10	47	31	51	82	H33841 N00		1
15	37	10	37	41	41	82	H33842 N00		1
15	27	10	51	31	55	86	H33881 N00		1
15	31	10	47	35	51	86	H33882 N00		1
15	37	10	41	41	45	86	H33883 N00		1
15	31	10	51	35	55	90	H33921 N00		1
15	41	10	41	45	45	90	H33922 N00		1
15	27	10	57	31	61	92	H33941 N00		1
15	37	10	47	41	51	92	H33942 N00		1
15	37	10	51	41	55	96	H33981 N00		1
15	41	10	47	45	51	96	H33982 N00		1
15	31	10	57	35	61	96	H33983 N00		1
15	41	10	51	45	55	100	H33020 N00		1
15	27	10	67	31	71	102	H33041 N00		1
15	37	10	57	41	61	102	H33042 N00		1
15	47	10	47	51	51	102	H33043 N00		1
15	27	10	77	31	81	112	H33141 N00		1
15	37	10	67	41	71	112	H33142 N00		1
15	47	10	57	51	61	112	H33143 N00		1
15	47	10	67	51	71	122	H33243 N00		1

con 5 chiavi with 5 keys

..... N50

frizionato frictioned

..... NOX

Mezzo cilindro con taglio e camma regolabile in 8 posizioni
Half cylinder with cut and adjustable cam in 8 position



HS

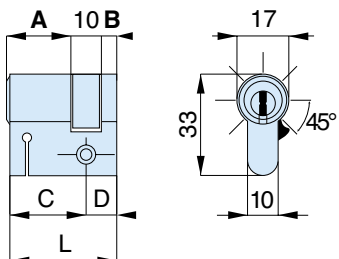

↓	A	B	C	D	L	codice code	euro	✎	📦
15	27	10	5	31	10	41	H34420 N00		1
15	31	10	5	35	10	45	H34460 N00		1
15	37	10	5	41	10	51	H34520 N00		1
15	41	10	5	45	10	55	H34560 N00		1
15	47	10	5	51	10	61	H34620 N00		1
15	57	10	5	61	10	71	H34720 N00		1
15	67	10	5	71	10	81	H34820 N00		1
15	77	10	5	81	10	91	H34920 N00		1

con 5 chiavi with 5 keys

..... N50

Doppio cilindro con pomolo ottone nichelato opaco con rinforzo e taglio
 Double cylinder with matt nickel-plated brass knob with reinforce and cut

HS

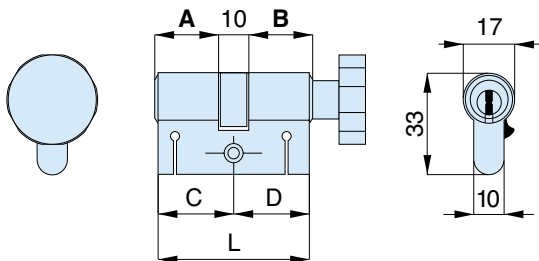

▽	A	B	C	D	L	codice code	euro	
15	27	10	27	31	31	62	H39640 NOR	1
15	27	10	31	31	35	66	H39681 NOR	1
15	31	10	27	35	31	66	H39682 NOR	1
15	31	10	31	35	35	70	H39720 NOR	1
15	27	10	37	31	41	72	H39741 NOR	1
15	37	10	27	41	31	72	H39742 NOR	1
15	27	10	41	31	45	76	H39781 NOR	1
15	41	10	27	45	31	76	H39782 NOR	1
15	31	10	37	35	41	76	H39783 NOR	1
15	37	10	31	41	35	76	H39784 NOR	1
15	31	10	41	35	45	80	H39821 NOR	1
15	41	10	31	45	35	80	H39822 NOR	1
15	27	10	47	31	51	82	H39841 NOR	1
15	47	10	27	51	31	82	H39842 NOR	1
15	37	10	37	41	41	82	H39843 NOR	1
15	27	10	51	31	55	86	H39881 NOR	1
15	31	10	47	35	51	86	H39882 NOR	1
15	37	10	41	41	45	86	H39883 NOR	1
15	41	10	37	45	41	86	H39884 NOR	1
15	31	10	51	35	55	90	H39921 NOR	1
15	41	10	41	45	45	90	H39922 NOR	1
15	27	10	57	31	61	92	H39941 NOR	1
15	37	10	47	41	51	92	H39942 NOR	1
15	37	10	51	41	55	96	H39981 NOR	1
15	41	10	47	45	51	96	H39982 NOR	1
15	41	10	51	45	55	100	H39020 NOR	1
15	27	10	67	31	71	102	H39041 NOR	1
15	37	10	57	41	61	102	H39042 NOR	1
15	47	10	47	51	51	102	H39043 NOR	1
15	27	10	77	31	81	112	H39141 NOR	1
15	37	10	67	41	71	112	H39142 NOR	1
15	47	10	57	51	61	112	H39143 NOR	1

con 5 chiavi with 5 keys

..... N5R

CILINDRI DI SICUREZZA DA INFILARE
security mortice cylinders





Doppio cilindro con pomolo ottone nichelato opaco con rinforzo e taglio
 Double cylinder with matt nickel-plated brass knob with reinforce and cut



HS

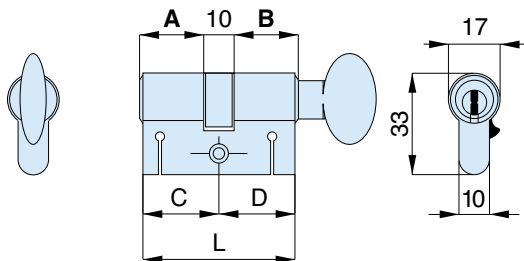

CILINDRI DI SICUREZZA DA INFILARE
security mortice cylinders

	A	B	C	D	L	codice code	euro		
15	27	10	27	31	31	62	H39640	N0F	1
15	27	10	31	31	35	66	H39681	N0F	1
15	31	10	27	35	31	66	H39682	N0F	1
15	31	10	31	35	35	70	H39720	N0F	1
15	27	10	37	31	41	72	H39741	N0F	1
15	37	10	27	41	31	72	H39742	N0F	1
15	27	10	41	31	45	76	H39781	N0F	1
15	41	10	27	45	31	76	H39782	N0F	1
15	31	10	37	35	41	76	H39783	N0F	1
15	37	10	31	41	35	76	H39784	N0F	1
15	31	10	41	35	45	80	H39821	N0F	1
15	41	10	31	45	35	80	H39822	N0F	1
15	27	10	47	31	51	82	H39841	N0F	1
15	47	10	27	51	31	82	H39842	N0F	1
15	37	10	37	41	41	82	H39843	N0F	1
15	27	10	51	31	55	86	H39881	N0F	1
15	31	10	47	35	51	86	H39882	N0F	1
15	37	10	41	41	45	86	H39883	N0F	1
15	41	10	37	45	41	86	H39884	N0F	1
15	31	10	51	35	55	90	H39921	N0F	1
15	41	10	41	45	45	90	H39922	N0F	1
15	27	10	57	31	61	92	H39941	N0F	1
15	37	10	47	41	51	92	H39942	N0F	1
15	37	10	51	41	55	96	H39981	N0F	1
15	41	10	47	45	51	96	H39982	N0F	1
15	41	10	51	45	55	100	H39020	N0F	1
15	27	10	67	31	71	102	H39041	N0F	1
15	37	10	57	41	61	102	H39042	N0F	1
15	47	10	47	51	51	102	H39043	N0F	1
15	27	10	77	31	81	112	H39141	N0F	1
15	37	10	67	41	71	112	H39142	N0F	1
15	47	10	57	51	61	112	H39143	N0F	1

con 5 chiavi with 5 keys

..... N5F

Doppio cilindro predisposto pomolo con rinforzo e taglio
 Double cylinder with knob provision with reinforce and cut



HS

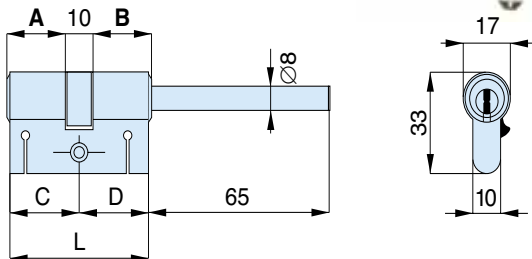

▽	A	B	C	D	L	codice code	euro	
15	27	10	27	31	31	62	H39640 NOL	1
15	31	10	27	35	31	66	H39680 NOL	1
15	37	10	27	41	31	72	H39740 NOL	1
15	41	10	27	45	31	76	H39780 NOL	1
15	47	10	27	51	31	82	H39840 NOL	1
15	51	10	27	55	31	86	H39880 NOL	1
15	57	10	27	61	31	92	H39940 NOL	1
15	67	10	27	71	31	102	H39040 NOL	1
15	77	10	27	81	31	112	H39140 NOL	1

con 5 chiavi with 5 keys

..... N5L

Doppio cilindro predisposto pomolo con rinforzo e taglio
 Double cylinder with knob provision with reinforce and cut



HS

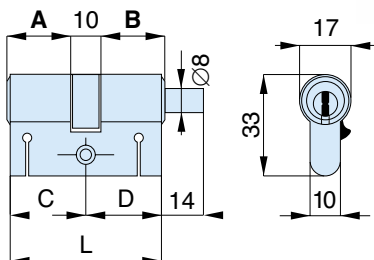

▽	A	B	C	D	L	codice code	euro	
15	27	10	27	31	31	62	H39640 NOC	1
15	27	10	31	31	35	66	H39681 NOC	1
15	31	10	27	35	31	66	H39682 NOC	1
15	31	10	31	35	35	70	H39720 NOC	1
15	27	10	37	31	41	72	H39741 NOC	1
15	37	10	27	41	31	72	H39742 NOC	1
15	27	10	41	31	45	76	H39781 NOC	1
15	41	10	27	45	31	76	H39782 NOC	1
15	31	10	37	35	41	76	H39783 NOC	1
15	37	10	31	41	35	76	H39784 NOC	1
15	31	10	41	35	45	80	H39821 NOC	1
15	41	10	31	45	35	80	H39822 NOC	1
15	27	10	47	31	51	82	H39841 NOC	1
15	47	10	27	51	31	82	H39842 NOC	1
15	37	10	37	41	41	82	H39843 NOC	1
15	27	10	51	31	55	86	H39881 NOC	1
15	31	10	47	35	51	86	H39882 NOC	1
15	37	10	41	41	45	86	H39883 NOC	1
15	41	10	37	45	41	86	H39884 NOC	1
15	31	10	51	35	55	90	H39921 NOC	1
15	41	10	41	45	45	90	H39922 NOC	1
15	27	10	57	31	61	92	H39941 NOC	1
15	37	10	47	41	51	92	H39942 NOC	1
15	37	10	51	41	55	96	H39981 NOC	1
15	41	10	47	45	51	96	H39982 NOC	1
15	41	10	51	45	55	100	H39020 NOC	1
15	27	10	67	31	71	102	H39041 NOC	1
15	37	10	57	41	61	102	H39042 NOC	1
15	47	10	47	51	51	102	H39043 NOC	1
15	27	10	77	31	81	112	H39141 NOC	1
15	37	10	67	41	71	112	H39142 NOC	1
15	47	10	57	51	61	112	H39143 NOC	1

con 5 chiavi with 5 keys

..... N5C





Doppio cilindro ovale
Double oval cylinder



HS

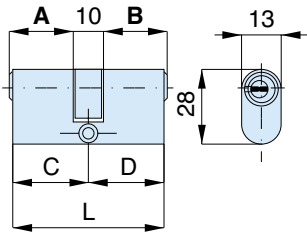

Per cilindri H18 sono previsti solo impianti a chiave uguale
For the cylinders H18 are foreseen just key alike systems

	A	B	C	D	L	codice code	euro	
5	27	10	27	31	31	H18640 N00		1

con 5 chiavi with 5 keys

..... N50

Doppio cilindro Ø 26
Double cylinder Ø 26



HS

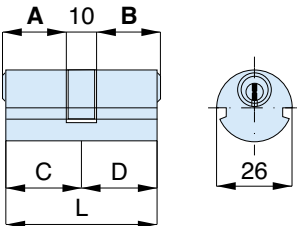

	A	B	C	D	L	codice code	euro	
15	27	10	27	31	31	H19640 N00		1
15	27	10	47	31	51	H19841 N00		1

con 5 chiavi with 5 keys

..... N50

Doppio cilindro Ø 22
Double cylinder Ø 22



HS

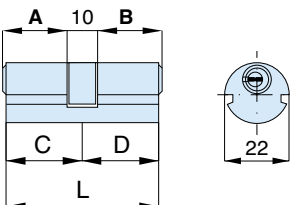

	A	B	C	D	L	codice code	euro	
5	27	10	27	31	31	H20640 N00		1

con 5 chiavi with 5 keys

..... N50

Per cilindri H20 sono previsti solo impianti a chiave uguale
For the cylinders H20 are foreseen just key alike systems

Lucchetto di sicurezza - nickel opaco
 Security padlock - matt nickel



HS

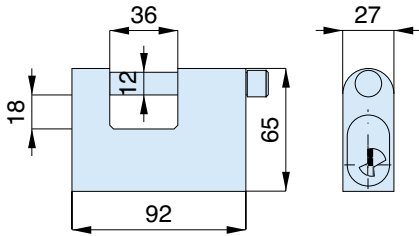

finiture
finishing

codice
code

euro



acciaio
steel

H92000 N00

con 5 chiavi with 5 keys

..... **N50**

CILINDRI DI SICUREZZA DA INFILARE
security mortice cylinders