

■ **CILINDRI DA APPLICARE**
RIM CYLINDERS



P. 19

■ **CILINDRI DA INFILARE**
MORTICE CYLINDERS



P. 21

■ **CILINDRI OVALI**
OVAL CYLINDERS



P. 26 - 29

■ **CILINDRI Ø 26**
Ø 26 CYLINDERS



P. 26 - 29

■ **CILINDRI Ø 22**
Ø 22 CYLINDERS



P. 26 - 29

■ **CILINDRI A GROCE**
CROSS KEY CYLINDERS



P. 29

- ✓ **Corpo in ottone**
Brass body
- ✓ **Perni e controperni in ottone**
Brass pins
- ✓ **Molle in bronzo fosforoso**
Bronze springs
- ✓ **Camma DIN (cilindri da infilare)**
DIN cam (mortice cylinders)
- ✓ **3 chiavi in ottone nichelato**
3 keys in nickel plated brass



Cilindro - per art. 435 - 602
 Cylinder - for art. 435 - 602

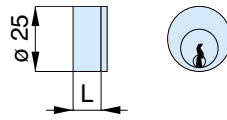

| | A | B | C | D | L | codice code | euro | |
|---|---|---|---|---|----|-------------------|------|----|
| 3 | | | | | 11 | 008110 000 | | 10 |

Cilindro - per art. 611
 Cylinder - for art. 611

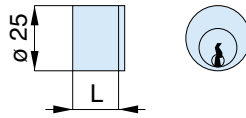

| | A | B | C | D | L | codice code | euro | |
|---|---|---|---|---|----|-------------------|------|----|
| 4 | | | | | 18 | 010180 000 | | 10 |
| 5 | | | | | 28 | 010280 000 | | 10 |

Cilindro - per art. 711
 Cylinder - for art. 711

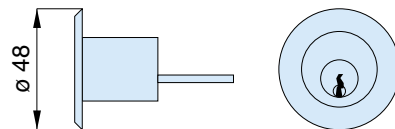

| | A | B | C | D | L | codice code | euro | |
|---|---|---|---|---|---|-------------------|------|----|
| 5 | | | | | | 011000 000 | | 10 |

Cilindro - per art. 712
Cylinder - for art. 712

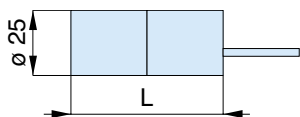

| | A | B | C | D | L | codice code | euro | | |
|---|---|---|---|---|----|----------------|------|--|--|
| 5 | | | | | 35 | 012350 000 | 10 | | |
| 5 | | | | | 40 | 012400 000 | 10 | | |
| 5 | | | | | 50 | 012500 000 | 10 | | |
| 5 | | | | | 60 | 012600 000 | 10 | | |
| 5 | | | | | 70 | 012700 000 | 10 | | |
| 5 | | | | | 80 | 012800 000 | 10 | | |

Coppia cilindri per art. 127-147-255-343-433
Double rim cylinder for art. 127-147-255-343-433

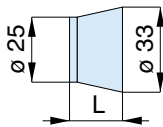
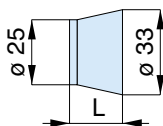

| | A | B | C | D | L | codice code | euro | | |
|---|---|---|---|---|----|----------------|------|--|--|
| 4 | | | | | 20 | 013200 000 | 10 | | |

Coppia cilindri per art. 436
Double rim cylinder for art. 436

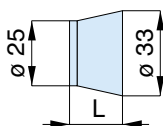
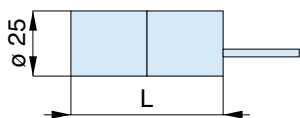

| | A | B | C | D | L | codice code | euro | | |
|---|---|---|---|---|----|----------------|------|--|--|
| 4 | | | | | 50 | 014500 000 | 10 | | |

Doppio cilindro
Double cylinder

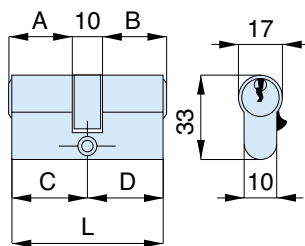

| ▽ | A | B | C | D | L | codice code | euro | | |
|---|----|----|----|----|-----|----------------|------------|--|----|
| 4 | 23 | 10 | 23 | 27 | 27 | 54 | 015560 000 | | 10 |
| 4 | 23 | 10 | 27 | 27 | 31 | 58 | 015600 000 | | 10 |
| 5 | 27 | 10 | 27 | 31 | 31 | 62 | 015640 000 | | 10 |
| 4 | 23 | 10 | 33 | 27 | 37 | 64 | 015660 000 | | 10 |
| 5 | 27 | 10 | 31 | 31 | 35 | 66 | 015680 000 | | 10 |
| 4 | 23 | 10 | 37 | 27 | 41 | 68 | 015701 000 | | 10 |
| 5 | 27 | 10 | 33 | 31 | 37 | 68 | 015702 000 | | 10 |
| 5 | 31 | 10 | 31 | 35 | 35 | 70 | 015720 000 | | 10 |
| 5 | 27 | 10 | 37 | 31 | 41 | 72 | 015740 000 | | 10 |
| 5 | 33 | 10 | 33 | 37 | 37 | 74 | 015760 000 | | 10 |
| 4 | 23 | 10 | 47 | 27 | 51 | 78 | 015801 000 | | 10 |
| 5 | 33 | 10 | 37 | 37 | 41 | 78 | 015802 000 | | 10 |
| 5 | 31 | 10 | 41 | 35 | 45 | 80 | 015820 000 | | 10 |
| 5 | 27 | 10 | 47 | 31 | 51 | 82 | 015841 000 | | 10 |
| 5 | 37 | 10 | 37 | 41 | 41 | 82 | 015842 000 | | 10 |
| 5 | 33 | 10 | 43 | 37 | 47 | 84 | 015860 000 | | 10 |
| 5 | 33 | 10 | 47 | 37 | 51 | 88 | 015901 000 | | 10 |
| 5 | 37 | 10 | 43 | 41 | 47 | 88 | 015902 000 | | 10 |
| 5 | 27 | 10 | 57 | 31 | 61 | 92 | 015941 000 | | 10 |
| 5 | 37 | 10 | 47 | 41 | 51 | 92 | 015942 000 | | 10 |
| 5 | 43 | 10 | 43 | 47 | 47 | 94 | 015960 000 | | 10 |
| 5 | 27 | 10 | 67 | 31 | 71 | 102 | 015041 000 | | 10 |
| 5 | 37 | 10 | 57 | 41 | 61 | 102 | 015042 000 | | 10 |
| 5 | 47 | 10 | 47 | 51 | 51 | 102 | 015043 000 | | 10 |
| 5 | 27 | 10 | 77 | 31 | 81 | 112 | 015141 000 | | 10 |
| 5 | 37 | 10 | 67 | 41 | 71 | 112 | 015142 000 | | 10 |
| 5 | 47 | 10 | 57 | 51 | 61 | 112 | 015143 000 | | 10 |
| 5 | 27 | 10 | 87 | 31 | 91 | 122 | 015241 000 | | 10 |
| 5 | 37 | 10 | 77 | 41 | 81 | 122 | 015242 000 | | 10 |
| 5 | 47 | 10 | 67 | 51 | 71 | 122 | 015243 000 | | 10 |
| 5 | 57 | 10 | 57 | 61 | 61 | 122 | 015244 000 | | 10 |
| 5 | 27 | 10 | 97 | 31 | 101 | 132 | 015341 000 | | 10 |
| 5 | 37 | 10 | 87 | 41 | 91 | 132 | 015342 000 | | 10 |
| 5 | 47 | 10 | 77 | 51 | 81 | 132 | 015343 000 | | 10 |
| 5 | 57 | 10 | 67 | 61 | 71 | 132 | 015344 000 | | 10 |

CILINDRI DA INFILARE IN OTTONE
brass mortice cylinders

Mezzo cilindro con camma regolabile in 8 posizioni
Half cylinder with adjustable cam in 8 positions

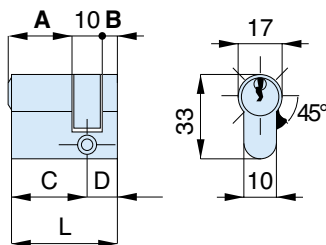

| ▽ | A | B | C | D | L | codice code | euro | | |
|---|----|----|---|-----|----|----------------|------------|--|----|
| 3 | 17 | 10 | 5 | 21 | 10 | 31 | 017320 000 | | 10 |
| 4 | 23 | 10 | 5 | 27 | 10 | 37 | 017380 000 | | 10 |
| 5 | 27 | 10 | 5 | 31 | 10 | 41 | 017420 000 | | 10 |
| 5 | 31 | 10 | 5 | 35 | 10 | 45 | 017460 000 | | 10 |
| 5 | 33 | 10 | 5 | 37 | 10 | 47 | 017480 000 | | 10 |
| 5 | 37 | 10 | 5 | 41 | 10 | 51 | 017520 000 | | 10 |
| 5 | 43 | 10 | 5 | 47 | 10 | 57 | 017580 000 | | 10 |
| 5 | 47 | 10 | 5 | 51 | 10 | 61 | 017620 000 | | 10 |
| 5 | 57 | 10 | 5 | 61 | 10 | 71 | 017720 000 | | 10 |
| 5 | 67 | 10 | 5 | 71 | 10 | 81 | 017820 000 | | 10 |
| 5 | 77 | 10 | 5 | 81 | 10 | 91 | 017920 000 | | 10 |
| 5 | 87 | 10 | 5 | 91 | 10 | 101 | 017020 000 | | 10 |
| 5 | 97 | 10 | 5 | 101 | 10 | 111 | 017120 000 | | 10 |



Doppio cilindro con pomolo ottone lucido
Double cylinder with polished brass knob

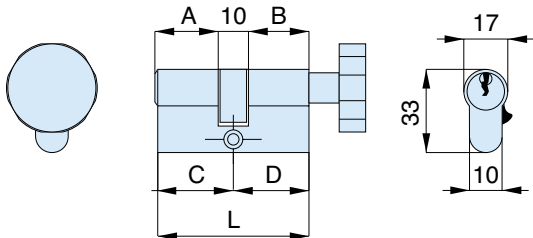

CILINDRI DA INFILARE IN OTTONE
brass mortice cylinders

| | A | B | C | D | L | codice code | euro | | |
|---|----|----|----|----|-----|-------------|--------|-----|----|
| 4 | 23 | 10 | 23 | 27 | 27 | 54 | 025560 | 00R | 10 |
| 4 | 23 | 10 | 27 | 27 | 31 | 58 | 025600 | 00R | 10 |
| 5 | 27 | 10 | 27 | 31 | 31 | 62 | 025640 | 00R | 10 |
| 4 | 23 | 10 | 33 | 27 | 37 | 64 | 025660 | 00R | 10 |
| 5 | 27 | 10 | 31 | 31 | 35 | 66 | 025681 | 00R | 10 |
| 5 | 31 | 10 | 27 | 35 | 31 | 66 | 025682 | 00R | 10 |
| 4 | 23 | 10 | 37 | 27 | 41 | 68 | 025701 | 00R | 10 |
| 5 | 27 | 10 | 33 | 31 | 37 | 68 | 025702 | 00R | 10 |
| 4 | 33 | 10 | 27 | 37 | 31 | 68 | 025705 | 00R | 10 |
| 5 | 31 | 10 | 31 | 35 | 35 | 70 | 025720 | 00R | 10 |
| 5 | 27 | 10 | 37 | 31 | 41 | 72 | 025741 | 00R | 10 |
| 5 | 37 | 10 | 27 | 41 | 31 | 72 | 025742 | 00R | 10 |
| 4 | 33 | 10 | 33 | 37 | 37 | 74 | 025760 | 00R | 10 |
| 4 | 23 | 10 | 47 | 27 | 51 | 78 | 025801 | 00R | 10 |
| 4 | 33 | 10 | 37 | 37 | 41 | 78 | 025802 | 00R | 10 |
| 5 | 31 | 10 | 41 | 35 | 45 | 80 | 025821 | 00R | 10 |
| 5 | 41 | 10 | 31 | 45 | 35 | 80 | 025822 | 00R | 10 |
| 5 | 27 | 10 | 47 | 31 | 51 | 82 | 025841 | 00R | 10 |
| 5 | 47 | 10 | 27 | 51 | 31 | 82 | 025842 | 00R | 10 |
| 5 | 37 | 10 | 37 | 41 | 41 | 82 | 025843 | 00R | 10 |
| 4 | 33 | 10 | 43 | 37 | 47 | 84 | 025860 | 00R | 10 |
| 4 | 33 | 10 | 47 | 37 | 51 | 88 | 025901 | 00R | 10 |
| 5 | 37 | 10 | 43 | 41 | 47 | 88 | 025902 | 00R | 10 |
| 5 | 27 | 10 | 57 | 31 | 61 | 92 | 025941 | 00R | 10 |
| 5 | 37 | 10 | 47 | 41 | 51 | 92 | 025942 | 00R | 10 |
| 5 | 47 | 10 | 37 | 51 | 41 | 92 | 025943 | 00R | 10 |
| 5 | 57 | 10 | 27 | 61 | 31 | 92 | 025945 | 00R | 10 |
| 4 | 43 | 10 | 43 | 47 | 47 | 94 | 025960 | 00R | 10 |
| 5 | 27 | 10 | 67 | 31 | 71 | 102 | 025041 | 00R | 10 |
| 5 | 37 | 10 | 57 | 41 | 61 | 102 | 025042 | 00R | 10 |
| 5 | 47 | 10 | 47 | 51 | 51 | 102 | 025043 | 00R | 10 |
| 5 | 57 | 10 | 37 | 61 | 41 | 102 | 025045 | 00R | 10 |
| 5 | 67 | 10 | 27 | 71 | 31 | 102 | 025046 | 00R | 10 |
| 5 | 27 | 10 | 77 | 31 | 81 | 112 | 025141 | 00R | 10 |
| 5 | 37 | 10 | 67 | 41 | 71 | 112 | 025142 | 00R | 10 |
| 5 | 47 | 10 | 57 | 51 | 61 | 112 | 025143 | 00R | 10 |
| 5 | 57 | 10 | 47 | 61 | 51 | 112 | 025145 | 00R | 10 |
| 5 | 67 | 10 | 37 | 71 | 41 | 112 | 025146 | 00R | 10 |
| 5 | 77 | 10 | 27 | 81 | 31 | 112 | 025147 | 00R | 10 |
| 5 | 27 | 10 | 87 | 31 | 91 | 122 | 025241 | 00R | 10 |
| 5 | 37 | 10 | 77 | 41 | 81 | 122 | 025242 | 00R | 10 |
| 5 | 47 | 10 | 67 | 51 | 71 | 122 | 025243 | 00R | 10 |
| 5 | 57 | 10 | 57 | 61 | 61 | 122 | 025244 | 00R | 10 |
| 5 | 67 | 10 | 47 | 71 | 51 | 122 | 025245 | 00R | 10 |
| 5 | 77 | 10 | 37 | 81 | 41 | 122 | 025246 | 00R | 10 |
| 5 | 27 | 10 | 97 | 31 | 101 | 132 | 025341 | 00R | 10 |
| 5 | 37 | 10 | 87 | 41 | 91 | 132 | 025342 | 00R | 10 |
| 5 | 47 | 10 | 77 | 51 | 81 | 132 | 025343 | 00R | 10 |
| 5 | 57 | 10 | 67 | 61 | 71 | 132 | 025344 | 00R | 10 |
| 5 | 67 | 10 | 57 | 71 | 61 | 132 | 025345 | 00R | 10 |

Doppio cilindro con pomolo ottone lucido
 Double cylinder with polished brass knob

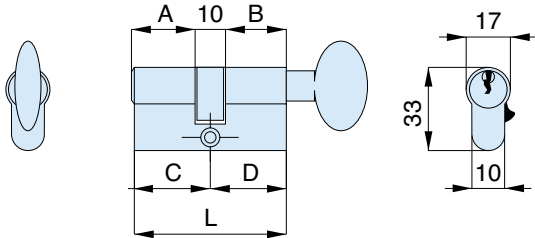

| ▽ | A | B | C | D | L | codice code | euro | |
|---|----|----|----|----|-----|-------------|------------|----|
| 4 | 23 | 10 | 23 | 27 | 27 | 54 | 025560 00F | 10 |
| 4 | 23 | 10 | 27 | 27 | 31 | 58 | 025600 00F | 10 |
| 5 | 27 | 10 | 27 | 31 | 31 | 62 | 025640 00F | 10 |
| 4 | 23 | 10 | 33 | 27 | 37 | 64 | 025660 00F | 10 |
| 5 | 27 | 10 | 31 | 31 | 35 | 66 | 025681 00F | 10 |
| 5 | 31 | 10 | 27 | 35 | 31 | 66 | 025682 00F | 10 |
| 4 | 23 | 10 | 37 | 27 | 41 | 68 | 025701 00F | 10 |
| 5 | 27 | 10 | 33 | 31 | 37 | 68 | 025702 00F | 10 |
| 4 | 33 | 10 | 27 | 37 | 31 | 68 | 025705 00F | 10 |
| 5 | 31 | 10 | 31 | 35 | 35 | 70 | 025720 00F | 10 |
| 5 | 27 | 10 | 37 | 31 | 41 | 72 | 025741 00F | 10 |
| 5 | 37 | 10 | 27 | 41 | 31 | 72 | 025742 00F | 10 |
| 4 | 33 | 10 | 33 | 37 | 37 | 74 | 025760 00F | 10 |
| 4 | 23 | 10 | 47 | 27 | 51 | 78 | 025801 00F | 10 |
| 4 | 33 | 10 | 37 | 37 | 41 | 78 | 025802 00F | 10 |
| 5 | 31 | 10 | 41 | 35 | 45 | 80 | 025821 00F | 10 |
| 5 | 41 | 10 | 31 | 45 | 35 | 80 | 025822 00F | 10 |
| 5 | 27 | 10 | 47 | 31 | 51 | 82 | 025841 00F | 10 |
| 5 | 47 | 10 | 27 | 51 | 31 | 82 | 025842 00F | 10 |
| 5 | 37 | 10 | 37 | 41 | 41 | 82 | 025843 00F | 10 |
| 4 | 33 | 10 | 43 | 37 | 47 | 84 | 025860 00F | 10 |
| 4 | 33 | 10 | 47 | 37 | 51 | 88 | 025901 00F | 10 |
| 5 | 37 | 10 | 43 | 41 | 47 | 88 | 025902 00F | 10 |
| 5 | 27 | 10 | 57 | 31 | 61 | 92 | 025941 00F | 10 |
| 5 | 37 | 10 | 47 | 41 | 51 | 92 | 025942 00F | 10 |
| 5 | 47 | 10 | 37 | 51 | 41 | 92 | 025943 00F | 10 |
| 5 | 57 | 10 | 27 | 61 | 31 | 92 | 025945 00F | 10 |
| 4 | 43 | 10 | 43 | 47 | 47 | 94 | 025960 00F | 10 |
| 5 | 27 | 10 | 67 | 31 | 71 | 102 | 025041 00F | 10 |
| 5 | 37 | 10 | 57 | 41 | 61 | 102 | 025042 00F | 10 |
| 5 | 47 | 10 | 47 | 51 | 51 | 102 | 025043 00F | 10 |
| 5 | 57 | 10 | 37 | 61 | 41 | 102 | 025045 00F | 10 |
| 5 | 67 | 10 | 27 | 71 | 31 | 102 | 025046 00F | 10 |
| 5 | 27 | 10 | 77 | 31 | 81 | 112 | 025141 00F | 10 |
| 5 | 37 | 10 | 67 | 41 | 71 | 112 | 025142 00F | 10 |
| 5 | 47 | 10 | 57 | 51 | 61 | 112 | 025143 00F | 10 |
| 5 | 57 | 10 | 47 | 61 | 51 | 112 | 025145 00F | 10 |
| 5 | 67 | 10 | 37 | 71 | 41 | 112 | 025146 00F | 10 |
| 5 | 77 | 10 | 27 | 81 | 31 | 112 | 025147 00F | 10 |
| 5 | 27 | 10 | 87 | 31 | 91 | 122 | 025241 00F | 10 |
| 5 | 37 | 10 | 77 | 41 | 81 | 122 | 025242 00F | 10 |
| 5 | 47 | 10 | 67 | 51 | 71 | 122 | 025243 00F | 10 |
| 5 | 57 | 10 | 57 | 61 | 61 | 122 | 025244 00F | 10 |
| 5 | 67 | 10 | 47 | 71 | 51 | 122 | 025245 00F | 10 |
| 5 | 77 | 10 | 37 | 81 | 41 | 122 | 025246 00F | 10 |
| 5 | 27 | 10 | 97 | 31 | 101 | 132 | 025341 00F | 10 |
| 5 | 37 | 10 | 87 | 41 | 91 | 132 | 025342 00F | 10 |
| 5 | 47 | 10 | 77 | 51 | 81 | 132 | 025343 00F | 10 |
| 5 | 57 | 10 | 67 | 61 | 71 | 132 | 025344 00F | 10 |
| 5 | 67 | 10 | 57 | 71 | 61 | 132 | 025345 00F | 10 |

CILINDRI DA INFILARE IN OTTONE
 brass mortice cylinders





Doppio cilindro predisposto pomolo
Double cylinder with knob provision

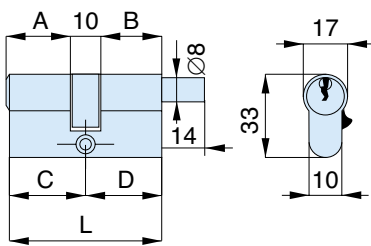

| | A | B | C | D | L | codice code | euro | |
|---|----|----|----|----|-----|----------------|------------|----|
| 4 | 23 | 10 | 23 | 27 | 27 | 54 | 025560 00C | 10 |
| 4 | 23 | 10 | 27 | 27 | 31 | 58 | 025600 00C | 10 |
| 5 | 27 | 10 | 27 | 31 | 31 | 62 | 025640 00C | 10 |
| 4 | 23 | 10 | 33 | 27 | 37 | 64 | 025660 00C | 10 |
| 5 | 27 | 10 | 31 | 31 | 35 | 66 | 025681 00C | 10 |
| 5 | 31 | 10 | 27 | 35 | 31 | 66 | 025682 00C | 10 |
| 4 | 23 | 10 | 37 | 27 | 41 | 68 | 025701 00C | 10 |
| 5 | 27 | 10 | 33 | 31 | 37 | 68 | 025702 00C | 10 |
| 4 | 33 | 10 | 27 | 37 | 31 | 68 | 025705 00C | 10 |
| 5 | 31 | 10 | 31 | 35 | 35 | 70 | 025720 00C | 10 |
| 5 | 27 | 10 | 37 | 31 | 41 | 72 | 025741 00C | 10 |
| 5 | 37 | 10 | 27 | 41 | 31 | 72 | 025742 00C | 10 |
| 4 | 33 | 10 | 33 | 37 | 37 | 74 | 025760 00C | 10 |
| 4 | 23 | 10 | 47 | 27 | 51 | 78 | 025801 00C | 10 |
| 4 | 33 | 10 | 37 | 37 | 41 | 78 | 025802 00C | 10 |
| 5 | 31 | 10 | 41 | 35 | 45 | 80 | 025821 00C | 10 |
| 5 | 41 | 10 | 31 | 45 | 35 | 80 | 025822 00C | 10 |
| 5 | 27 | 10 | 47 | 31 | 51 | 82 | 025841 00C | 10 |
| 5 | 47 | 10 | 27 | 51 | 31 | 82 | 025842 00C | 10 |
| 5 | 37 | 10 | 37 | 41 | 41 | 82 | 025843 00C | 10 |
| 4 | 33 | 10 | 43 | 37 | 47 | 84 | 025860 00C | 10 |
| 4 | 33 | 10 | 47 | 37 | 51 | 88 | 025901 00C | 10 |
| 5 | 37 | 10 | 43 | 41 | 47 | 88 | 025902 00C | 10 |
| 5 | 27 | 10 | 57 | 31 | 61 | 92 | 025941 00C | 10 |
| 5 | 37 | 10 | 47 | 41 | 51 | 92 | 025942 00C | 10 |
| 5 | 47 | 10 | 37 | 51 | 41 | 92 | 025943 00C | 10 |
| 5 | 57 | 10 | 27 | 61 | 31 | 92 | 025945 00C | 10 |
| 4 | 43 | 10 | 43 | 47 | 47 | 94 | 025960 00C | 10 |
| 5 | 27 | 10 | 67 | 31 | 71 | 102 | 025041 00C | 10 |
| 5 | 37 | 10 | 57 | 41 | 61 | 102 | 025042 00C | 10 |
| 5 | 47 | 10 | 47 | 51 | 51 | 102 | 025043 00C | 10 |
| 5 | 57 | 10 | 37 | 61 | 41 | 102 | 025045 00C | 10 |
| 5 | 67 | 10 | 27 | 71 | 31 | 102 | 025046 00C | 10 |
| 5 | 27 | 10 | 77 | 31 | 81 | 112 | 025141 00C | 10 |
| 5 | 37 | 10 | 67 | 41 | 71 | 112 | 025142 00C | 10 |
| 5 | 47 | 10 | 57 | 51 | 61 | 112 | 025143 00C | 10 |
| 5 | 57 | 10 | 47 | 61 | 51 | 112 | 025145 00C | 10 |
| 5 | 67 | 10 | 37 | 71 | 41 | 112 | 025146 00C | 10 |
| 5 | 77 | 10 | 27 | 81 | 31 | 112 | 025147 00C | 10 |
| 5 | 27 | 10 | 87 | 31 | 91 | 122 | 025241 00C | 10 |
| 5 | 37 | 10 | 77 | 41 | 81 | 122 | 025242 00C | 10 |
| 5 | 47 | 10 | 67 | 51 | 71 | 122 | 025243 00C | 10 |
| 5 | 57 | 10 | 57 | 61 | 61 | 122 | 025244 00C | 10 |
| 5 | 67 | 10 | 47 | 71 | 51 | 122 | 025245 00C | 10 |
| 5 | 77 | 10 | 37 | 81 | 41 | 122 | 025246 00C | 10 |
| 5 | 27 | 10 | 97 | 31 | 101 | 132 | 025341 00C | 10 |
| 5 | 37 | 10 | 87 | 41 | 91 | 132 | 025342 00C | 10 |
| 5 | 47 | 10 | 77 | 51 | 81 | 132 | 025343 00C | 10 |
| 5 | 57 | 10 | 67 | 61 | 71 | 132 | 025344 00C | 10 |

Doppio cilindro predisposto pomolo
Double cylinder with knob provision

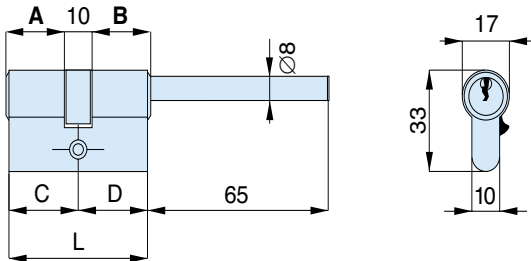

| ▽ | A | B | C | D | L | codice code | euro | |
|---|----|----|----|----|----|-------------|-------------------|----|
| 5 | 27 | 10 | 27 | 31 | 31 | 62 | 025640 00L | 10 |
| 5 | 31 | 10 | 27 | 35 | 31 | 66 | 025680 00L | 10 |
| 5 | 37 | 10 | 27 | 41 | 31 | 72 | 025740 00L | 10 |
| 5 | 47 | 10 | 27 | 51 | 31 | 82 | 025840 00L | 10 |
| 5 | 57 | 10 | 27 | 61 | 31 | 92 | 025940 00L | 10 |
| 5 | 67 | 10 | 27 | 71 | 31 | 102 | 025040 00L | 10 |

Doppio cilindro per porte di servizio
Double cylinder for toilet doors

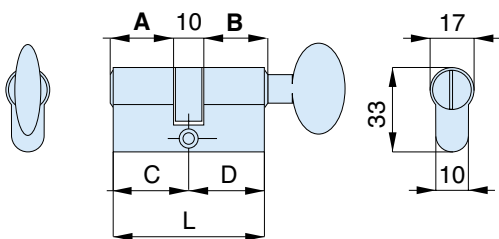

| ▽ | A | B | C | D | L | codice code | euro | |
|---|----|----|----|----|----|-------------|-------------------|----|
| | 23 | 10 | 23 | 27 | 27 | 54 | 025560 OWF | 10 |
| | 27 | 10 | 27 | 31 | 31 | 62 | 025640 OWF | 10 |
| | 31 | 10 | 31 | 35 | 35 | 70 | 025720 OWF | 10 |

Mezzo cilindro con pomolo piatto ottone lucido
Half cylinder with flat polished brass knob

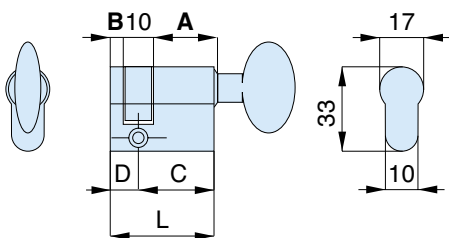

| ▽ | A | B | C | D | L | codice code | euro | |
|---|----|----|---|----|----|-------------|-------------------|----|
| | 23 | 10 | 5 | 27 | 10 | 37 | 025380 OMF | 10 |
| | 27 | 10 | 5 | 31 | 10 | 41 | 025420 OMF | 10 |
| | 31 | 10 | 5 | 35 | 10 | 45 | 025460 OMF | 10 |





Doppio cilindro ovale
Double oval cylinder

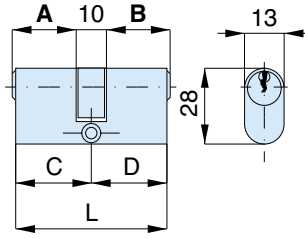

| | A | B | C | D | L | codice code | euro | |
|---|----|----|----|----|----|-------------|------------|----|
| 5 | 23 | 10 | 23 | 28 | 28 | 56 | 018560 000 | 10 |
| 5 | 25 | 10 | 25 | 30 | 30 | 60 | 018600 000 | 10 |
| 5 | 23 | 10 | 30 | 28 | 35 | 63 | 018630 000 | 10 |
| 5 | 23 | 10 | 37 | 28 | 42 | 70 | 018701 000 | 10 |
| 5 | 30 | 10 | 30 | 35 | 35 | 70 | 018702 000 | 10 |

Doppio cilindro Ø 26
Double cylinder Ø 26

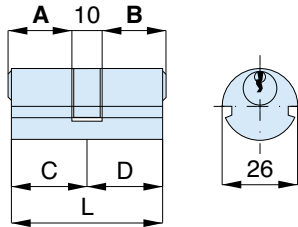

| | A | B | C | D | L | codice code | euro | |
|---|----|----|----|----|----|-------------|------------|----|
| 4 | 23 | 10 | 23 | 27 | 27 | 54 | 019560 000 | 10 |
| 4 | 23 | 10 | 27 | 27 | 31 | 58 | 019600 000 | 10 |
| 5 | 27 | 10 | 27 | 31 | 31 | 62 | 019640 000 | 10 |
| 4 | 23 | 10 | 37 | 27 | 41 | 68 | 019700 000 | 10 |
| 5 | 31 | 10 | 31 | 35 | 35 | 70 | 019720 000 | 10 |
| 4 | 23 | 10 | 47 | 27 | 51 | 78 | 019800 000 | 10 |
| 5 | 37 | 10 | 37 | 41 | 41 | 82 | 019840 000 | 10 |

Doppio cilindro Ø 22
Double cylinder Ø 22

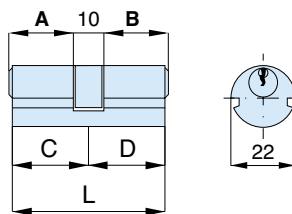

| | A | B | C | D | L | codice code | euro | |
|---|----|----|----|----|----|-------------|------------|----|
| 4 | 21 | 10 | 21 | 26 | 26 | 52 | 020520 000 | 10 |
| 5 | 23 | 10 | 23 | 28 | 28 | 56 | 020560 000 | 10 |
| 5 | 25 | 10 | 25 | 30 | 30 | 60 | 020600 000 | 10 |
| 5 | 23 | 10 | 30 | 28 | 35 | 63 | 020630 000 | 10 |
| 5 | 23 | 10 | 37 | 28 | 42 | 70 | 020701 000 | 10 |
| 5 | 30 | 10 | 30 | 35 | 35 | 70 | 020702 000 | 10 |

Metà cilindro ovale
Half oval cylinder

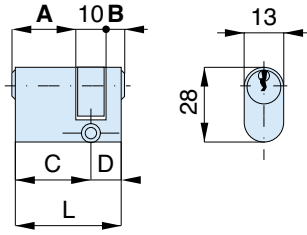

| ▼ | A | B | C | D | L | codice code | euro | |
|---|----|----|---|----|----|----------------|-------------------|----|
| 5 | 23 | 10 | 5 | 28 | 10 | 38 | 021380 000 | 10 |

Metà cilindro Ø 26 - Ø 22
Half cylinder Ø 26 - Ø 22

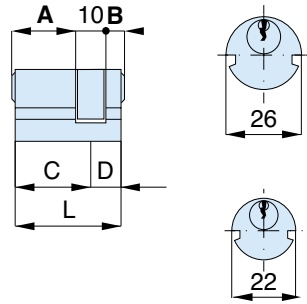

| ▼ | A | B | C | D | L | codice code | euro | |
|---|----|----|---|----|----|----------------|-------------------|----|
| 4 | 23 | 10 | 5 | 27 | 10 | 37 | 022381 000 | 10 |
| 5 | 23 | 10 | 5 | 28 | 10 | 38 | 022382 000 | 10 |

Doppio cilindro ovale con pomolo ottone lucido
Double oval cylinder with polished brass knob

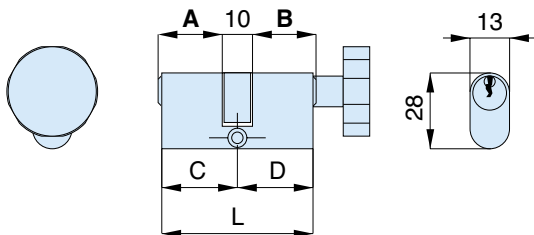

| ▼ | A | B | C | D | L | codice code | euro | |
|---|----|----|----|----|----|----------------|-------------------|----|
| 5 | 23 | 10 | 23 | 28 | 28 | 56 | 026560 00R | 10 |
| 5 | 30 | 10 | 23 | 35 | 28 | 63 | 026632 00R | 10 |





Doppio cilindro ovale con pomolo ottone lucido
Double oval cylinder with polished brass knob

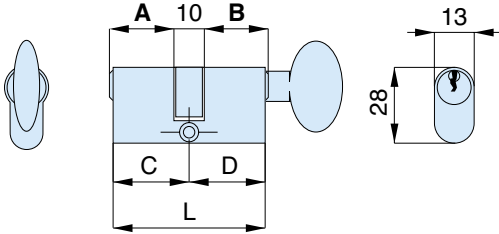

| | A | B | C | D | L | codice code | euro | |
|---|----|----|----|----|----|-------------|------|----|
| 5 | 23 | 10 | 23 | 28 | 28 | 026560 00F | | 10 |
| 5 | 30 | 10 | 23 | 35 | 28 | 026632 00F | | 10 |

Mezzo cilindro con pomolo ottone lucido
Half cylinder with polished brass knob

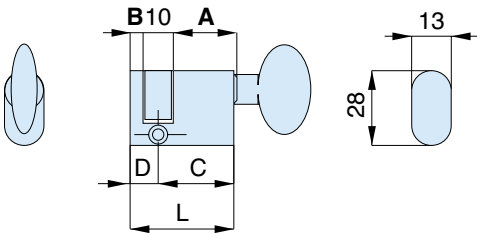

| | A | B | C | D | L | codice code | euro | |
|--|----|----|---|----|----|-------------|------|----|
| | 23 | 10 | 5 | 28 | 10 | 026380 0MF | | 10 |

Doppio cilindro Ø 26 con pomolo ottone lucido
Double cylinder Ø 26 with polished brass knob

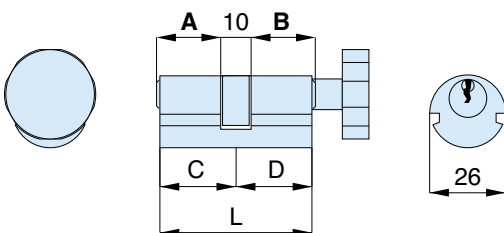

| | A | B | C | D | L | codice code | euro | |
|---|----|----|----|----|----|-------------|------|----|
| 4 | 23 | 10 | 23 | 27 | 27 | 027560 00R | | 10 |
| 4 | 23 | 10 | 27 | 27 | 31 | 027600 00R | | 10 |
| 5 | 27 | 10 | 27 | 31 | 31 | 027640 00R | | 10 |

Doppio cilindro Ø 22 con pomolo ottone lucido
 Double cylinder Ø 22 with polished brass knob

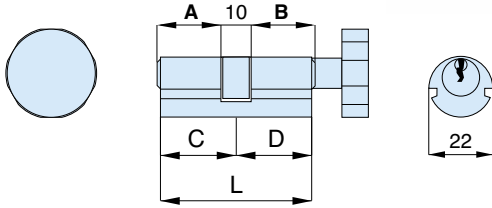

| | A | B | C | D | L | codice code | euro | |
|---|----|----|----|----|----|----------------|------|----|
| 5 | 23 | 10 | 23 | 28 | 28 | 028560 00R | | 10 |

Cilindro a croce per serie art. 930 - 950
 Cross key cylinder for series art. 930 - 950



| | A | B | C | D | L | codice code | euro | |
|--|---|---|---|---|---|----------------|------|----|
| | | | | | | 030000 000 | | 10 |