



LISTINO PREZZI_PRICELIST
FEBBRAIO_FEBRUARY

2016





2016

MG SERRATURE s.p.a.

Sede legale e sociale: Via Monte Rosa, 29/31
20824 - LAZZATE (MB)

telefono +39 02 96720008 - 96320160

fax +39 02 96329155

sito www.mgserrature.it

e-mail ufficio vendite italia vendite@mgserrature.it

ufficio vendite estero sales@mgserrature.it

P. I.V.A. 00837830967 - Capitale Sociale € 516.500,00 - Reg. Soc. N° 23696 - C.C.I.A.A. N° 1119303



MG è presente in Italia dal 1958, anno in cui, su iniziativa dell'imprenditore Monti Giovanni, viene fondata a Lazzate, specializzandosi nella produzione di cilindri e serrature per porte.

MG SERRATURE fa il suo ingresso nel settore della ferramenta, inizialmente a livello regionale, per espandersi nei successivi decenni a livello nazionale ed internazionale. Oggi MG SERRATURE è presente in diversi paesi tramite distributori o rivenditori specializzati. Le sinergie prodotte in un contesto internazionale hanno contribuito alla crescita della società: la costante attenzione alla qualità e all'innovazione tecnologica ha contribuito a creare, nel corso del tempo, una vasta gamma di prodotti, molti dei quali certificati secondo le normative europee.

La linea delle serrature per alluminio è stata ampliata con la produzione di serrature da montante e multipunto, per il settore legno è stata inserita una nuova gamma di serrature da infilare disponibile in varie dimensioni e finiture.

I cilindri della serie HSP, con chiave brevettata a duplicazione controllata, possono contare sulla versione "modulare" che garantisce un ulteriore grado di sicurezza ed un'ampia versatilità per gli specialisti.

Tutti gli articoli sono totalmente prodotti nella nostra sede operativa di Lazzate, avvalendoci unicamente di fornitori italiani per l'acquisto dei componenti e delle materie prime.

Certificazioni.

Fin dalla sua fondazione, MG SERRATURE si è ispirata ai principi basati sull'analisi ed il miglioramento continuo per garantire il massimo livello di soddisfazione dei propri clienti attraverso la qualità dei prodotti offerti e dei servizi ad essi associati.

Questo impegno ha portato MG SERRATURE a conseguire già dal 1998 la certificazione del proprio sistema di gestione per la qualità secondo la norma UNI EN ISO 9001 rilasciata da ICIM.

MG SERRATURE ha sempre posto grande attenzione all'ambiente, assumendo un impegno volto alla riduzione degli impatti ambientali, perseguendo e mantenendo la piena conformità alla legislazione applicabile.

Tale impegno, volto al miglioramento continuo, è confermato dalla certificazione del proprio sistema di gestione ambientale secondo la norma ISO 14001 rilasciata nel 2011 da ICIM.

MG SERRATURE, specialized in the production of cylinders and door locks, has been operating in Italy since 1958, on initiative of the entrepreneur Giovanni Monti.

Initially MG SERRATURE established itself in the regional market and at a later stage grew nationwide and worldwide. Today MG operates in several countries through distributors and specialized sellers.

The participation in the international market has been decisive for the development of the business: the quality attention and the technological innovation over the time promoted the realisation of a wide choice of specialized products, many of whom have been certified by the European normative.

The range of the locks for aluminium has been extended with the production of metal doors locks and multipoint locks, while a new selection of mortice locks has been introduced in the wood sector, available in several sizes and finishings.

The "HSP" Cylinders series, with patented keys and controlled key duplication, has been improved with the introduction of the "modular" version, ensuring a further safety grade to the costumers and a broad versatility to the specialists.

All MG items are entirely produced in its operative offices in Lazzate and the components and the raw material are bought from Italian suppliers only.

Certifications:

Since its foundation MG SERRATURE has constantly invested on the improvement of the quality of its products and given particular prominence to the customer assistance in order to offer the best service to its Clients. This led the company to the attainment of the certification UNI EN ISO 9001 issued by ICIM, for the professionalism of its quality management system.

MG SERRATURE has always paid serious attention to the environment, taking charge of reducing the environmental impact in accordance with the applicable regulation.

This constant commitment has been confirmed by the attainment of the certification ISO 14001 issued in 2011 by ICIM, for MG' s environment management system.





CHIAVI
keys

CILINDRI
cylinders

CILINDRI POMOLI LUCCHETTI
cylinders knobs padlocks

SERRATURE PER PORTE IN FERRO TAGLIAFUOCO E VETRO
locks for iron fire resistant and glass doors

| codice code | pagina page |
|-------------|-------------|
| K01 | 14 |
| K03 | 14 |
| K04 | 14 |
| K05 | 14 |
| K06 | 15 |
| K07 | 15 |
| K08 | 15 |
| A29 | 15 |

| codice code | pagina page |
|-------------|-------------|
| 008 | 19 |
| 010 | 19 |
| 011 | 19 |
| 012 | 20 |
| 013 | 20 |
| 014 | 20 |
| 015 | 21 |
| 017 | 21 |
| 025 R | 22 |
| 025 F | 23 |
| 025 C | 24 |
| 025 L | 25 |
| 025 WF | 25 |
| 018 | 26 |
| 019 | 26 |
| 020 | 26 |
| 021 | 27 |
| 022 | 27 |
| 026 R | 27 |
| 026 F | 28 |
| 026 MF | 28 |
| 027 R | 28 |
| 028 R | 29 |
| 030 | 29 |
| X12 | 33 |
| X80 | 33 |
| X81 | 33 |
| X81 | 34 |
| X85 R | 34 |
| X85 F | 35 |
| X85 L | 36 |
| X85 C | 36 |
| H11 | 39 |
| H12 | 39 |
| H14 | 39 |
| H23 | 40 |
| H24 | 40 |
| H24 | 41 |
| H29 R | 41 |
| H29 F | 42 |
| H29 L | 43 |
| H29 C | 43 |
| H33 | 44 |
| H34 | 44 |
| H39 R | 45 |
| H39 F | 46 |
| H39 L | 47 |
| H39 C | 47 |
| H18 | 48 |
| H19 | 48 |
| H20 | 48 |

| codice code | pagina page |
|-------------|-------------|
| P11 | 51 |
| P12 | 51 |
| P14 | 51 |
| P23 | 52 |
| P24 | 52 |
| P24 | 53 |
| P29 R | 53 |
| P29 F | 54 |
| P29 L | 55 |
| P29 C | 55 |
| P33 | 56 |
| P34 | 56 |
| P39 R | 57 |
| P39 F | 58 |
| P39 L | 59 |
| P39 C | 59 |
| P43 | 60 |
| P44 | 60 |
| P49 R | 61 |
| P49 F | 62 |
| P49 L | 63 |
| P49 C | 63 |
| P18 | 64 |
| P19 | 64 |
| P20 | 64 |
| OTS | 65 |
| 090 | 68 |
| X90 | 68 |
| H90 | 68 |
| P90 | 68 |
| X92 | 69 |
| H92 | 69 |
| P92 | 69 |

| codice code | pagina page |
|-------------|-------------|
| 124 | 72 |
| 127 | 72 |
| 128 | 72 |
| 129 | 72 |
| 132 | 73 |
| 133 | 73 |
| 134 | 73 |
| 135 | 74 |
| 136 | 74 |
| 138 | 74 |
| 139 | 74 |
| 145 | 75 |
| 147 | 75 |
| 148 | 75 |
| 149 | 75 |
| 255 | 76 |
| 271 | 76 |
| 273 | 76 |
| 282 | 77 |
| 283 | 77 |
| 288 | 77 |
| 312 | 78 |
| 313 | 78 |
| 316 | 78 |
| 317 | 78 |
| 343 | 79 |
| 344 | 79 |
| 345 | 79 |
| 423 | 80 |
| 424 | 80 |
| 425 | 80 |
| 426 | 80 |
| 427 | 81 |
| 429 | 81 |
| 433 | 81 |
| 434 | 81 |
| 435 | 82 |
| 436 | 82 |
| 437 | 82 |
| 461 | 83 |
| 480 | 83 |
| 482 | 83 |
| 485 | 83 |
| 486 | 84 |
| 489 | 84 |
| 502 | 85 |
| 544 | 86 |
| 545 | 86 |

SERRATURE PER SCORREVOLI E SERRANDE

locks for sliding and rolling gate

SERRATURE PER PORTE IN LEGNO

locks for wooden doors

SERRATURE PER PORTE IN ALLUMINIO

locks for aluminium doors

ACCESSORI E CONTROPIASTRE

accessories and striking plates



| codice code | pagina page |
|-------------|-------------|
| 551 | 88 |
| 552 | 88 |
| 552 | 89 |
| 553 | 89 |
| 554 | 90 |
| 555 | 91 |
| 558 | 91 |
| 561 | 92 |
| 562 | 92 |
| 566 | 93 |
| 568 | 93 |
| 571 | 94 |
| 572 | 94 |
| 573 | 95 |
| 574 | 95 |
| 601 | 96 |
| 602 | 96 |
| 610 | 97 |
| 611 | 97 |
| 612 | 97 |

| codice code | pagina page |
|-------------|-------------|
| 701 | 100 |
| 702 | 100 |
| 711 | 100 |
| 712 | 100 |
| 713 | 101 |
| 714 | 101 |
| 715 | 101 |
| 740 | 102 |
| 741 | 103 |
| 742 | 104 |
| 744 | 105 |
| 750 | 106 |
| 752 | 107 |

| codice code | pagina page |
|-------------|-------------|
| 797 | 110 |
| 800 | 110 |
| 801 | 110 |
| 802 | 111 |
| 803 | 111 |
| 804 | 112 |
| 805 | 112 |
| 806 | 112 |
| 809 | 113 |
| 812 | 113 |
| 830 | 113 |
| 901 | 114 |
| 902 | 114 |
| 904 | 114 |
| 906 | 114 |
| 908 | 115 |
| 911 | 115 |
| 913 | 115 |
| 921 | 116 |
| 922 | 116 |
| 923 | 116 |
| 925 | 117 |
| 926 | 117 |
| 927 | 118 |
| 928 | 119 |
| 929 | 119 |
| 930 | 120 |
| 931 | 120 |
| 932 | 121 |
| 933 | 121 |
| 934 | 122 |
| 935 | 122 |
| 936 | 123 |
| 937 | 123 |
| 938 | 124 |
| KIT RUL | 124 |
| 950 | 125 |
| 951 | 126 |
| 952 | 127 |
| 953 | 128 |
| 980 | 129 |

| codice code | pagina page |
|-------------|-------------|
| SPN | 132 |
| MOL | 132 |
| SPN | 133 |
| MOL | 133 |
| ATT | 134 |
| PNZ | 135 |
| A01 | 136 |
| A02 | 136 |
| A03 | 136 |
| A04 | 136 |
| A31 | 137 |
| A32 | 137 |
| A33 | 137 |
| A34 | 137 |
| A35 | 137 |
| A36 | 138 |
| A37 | 138 |
| A38 | 138 |
| A39 | 138 |
| A40 | 139 |
| A41 | 139 |
| A42 | 139 |
| A49 | 139 |
| A50 | 140 |
| A54 | 140 |
| A55 | 140 |
| A55 | 140 |
| A57 | 140 |
| A58 | 140 |
| A59 | 141 |
| A62 | 141 |
| A63 | 141 |
| A64 | 142 |
| A65 | 142 |
| A67 | 142 |
| A68 | 142 |
| A69 | 142 |
| A70 | 143 |
| A71 | 143 |
| A73 | 143 |
| A81 | 144 |
| A83 | 145 |
| A90 | 148 |
| A99 | 148 |



| esempio codice base base code example | finitura finishing | specialità chiave key speciality | variante variant | profilo chiave key profile | specialità montaggio assembling speciality |
|--|---|--|---|-------------------------------|--|
| H29640 | N | 0 | F | 0 | MK |
| | 0 = ottone naturale standard brass | 0 = standard 3 chiavi per cil. standard 3 key for cyl. | R = cilindro con pomolo rotondo cylinder with round knob | 0 | CA = impianto a chiave da cantiere construction key system |
| | N = nichelato opaco matt nickel | 1 = KA con 1 chiave per cil. KA with 1 key for cyl. | F = cilindro con pomolo piatto cylinder with flat knob | 1 | CM = impianto a chiave da cantiere maestra construction masterkey system |
| | L = ottone lucido verniciato polished brass | 3 = KA con 3 chiavi per cil. KA with 3 keys for cyl. | C = cilindro predisposto pomolo codolo corto cylinder knob provision short tang | 2 | MK = impianto a chiave maestra masterkey system |
| | C = cromo lucido polished chrome | 4 = chiave da cantiere 3+1 construction key 3+1 | L = cilindro predisposto pomolo codolo lungo cylinder knob provision long tang | 3 | GM = impianto a chiave maestra generale general masterkey system |
| | S = cromo satinato satin chrome | 5 = cilindro con 5 chiavi cylinder with 5 keys | X = cilindro frizionato clutching cylinder | 4 | VR = impianto vario 3 livelli vario 3 levels system |
| | B = bronzato bronze | 6 = chiave da cantiere 5+1 construction key 5+1 | | 5 | |
| | | W = cilindro per bagno cylinder for toilet | | 6 | |
| | | M = mezzo cil. con pomolo half cylinder with knob | | 7 | |
| | | 9 = cilindro smontato disassembled cylinder | | 8 | |
| | | | | 9 | |

| esempio codice base base code example | finitura frontale forend finishing | variante confezione packaging variant |
|---|---------------------------------------|---|
| 740502 | AL | 1 |
| 00 = acciaio zincato zinc plated steel | | 0 = confezionata con cilindro packed with cylinder |
| AL = acciaio ottonato verniciato brass plated steel | | 1 = confezionata senza cilindro packed without cylinder |
| AN = acciaio nichelato nickel plated steel | | 2 = industriale con cilindro industrial with cylinder |
| AC = acciaio cromo lucido polished chrome steel | | 3 = industriale senza cilindro industrial without cylinder |
| AS = acciaio cromo satinato satin chrome steel | | |
| AB = acciaio bronzato bronze steel | | 4 = confezionata senza incontro (solo per 702-712) packed without striking plate (only for 702-712) |
| AV = acciaio verniciato nero black painted steel | | 5 = industriale con incontro (solo per 702-712) industrial with striking plate (only for 702-712) |
| AX = acciaio inox stainless steel | | 6 = industriale senza incontro (solo per 702-712) industrial without striking plate (only for 702-712) |
| LV = ottone lucido verniciato polished brass | | |
| LN = ottone nichelato nickel plated brass | | |
| CL = ottone cromo lucido polished chrome brass | | |
| CS = ottone cromo satinato satin chrome brass | | |
| LB = ottone bronzato bronze brass | | |

Per evitare di avere un numero eccessivo di chiavi, è possibile realizzare dei “sistemi ammaestrati” che permettono di aprire con una sola chiave diverse porte e cancelli della stessa abitazione.

To avoid having an excessive number of keys, it's possible to carry out some “master key systems” that allow you to open different doors and gates of the same building with a single key.

KA= impianto con cilindri della stessa cifratura che funzionano con la stessa chiave.

KA= plant of cylinders having the same code that operate with the same key.



MK= impianto con cilindri a chiave maestra. In questo caso, ogni porta di un sistema ha la propria chiave specifica, ma è possibile aprire ciascuna porta con un'unica chiave in aggiunta, detta “chiave maestra”, con innegabili vantaggi in termini di comodità. È inoltre possibile gestire entrate comuni grazie al sistema a cilindro centrale. (Es: tutte le chiavi degli appartamenti privati di un condominio, ovviamente diverse tra loro, possono contemporaneamente aprire lo stesso portone condominiale).

MK= plant with master key cylinders. In this case, every door in a system has got its specific key, but in addition it's possible to open any door with the same key, called “master key”, with undeniable advantages of convenience. Moreover, it is possible to manage communal access by means of the central cylinder system. (For example: the keys to every private apartment of a building, which are obviously all different, can at the same time open the main building entrance).



GMK=è un impianto a più livelli, in cui, oltre alle chiavi di ogni singola porta e alle chiavi maestre che aprono gruppi di cilindri, esiste una chiave maestra superiore a cui fa riferimento tutto il sistema. Questo impianto è particolarmente indicato per le strutture ad apertura gerarchica, dove per esempio il direttore può accedere a tutti i locali, mentre i dipendenti ai locali prestabiliti.

GMK= it's a plant with different levels, where, in addition to the keys of the individual doors and to the master key opening groups of cylinders, there's a superior master key that manages the whole system. This plant is particularly suitable for hierarchical access structures, where for example the manager can access every room and the subordinates only pre-established rooms.

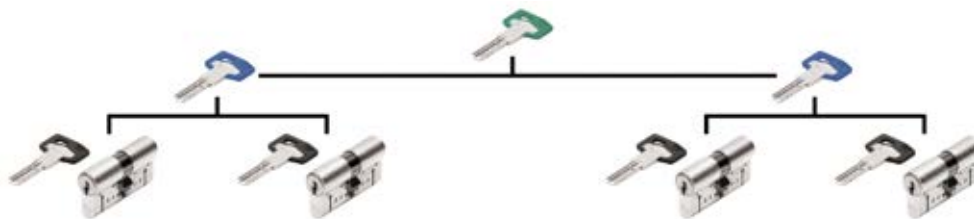

CA= chiave cantiere. Il cilindro funziona con una chiave provvisoria, detta “cantiere”, fino alla consegna dell’abitazione al proprietario, il quale, al primo utilizzo della propria chiave personale, modifica in modo irreversibile la cifratura del cilindro escludendo il funzionamento della chiave cantiere.

CM=il sistema è del tutto identico a CA con la sola differenza che la chiave “cantiere” inizialmente apre un gruppo di diversi cilindri.

CA= building key. The cylinder operates with a provisional key, called “building key”, until the delivery of the habitation to the owner, who, after using his personal key the first time, changes the cylinder's code irreversibly to invalidate the builder's key.

CM= this system is exactly like CA. The only difference is that the “builder's key” opens a group of different cylinders.



VR=è un impianto vario a 3 livelli. Il sistema è corredato di 3 diversi tipi di chiavi: il cilindro inizialmente funziona con la chiave contrassegnata dal colore rosso (1 livello). In un secondo momento, la chiave contrassegnata dal colore verde (2 livello) permette di ricodificare il cilindro annullando l'efficacia della prima chiave (quella rossa). Con il terzo tipo di chiave, quella contrassegnata dal colore nero, è possibile eseguire un'ulteriore ricodificazione che invalida le chiavi usate in precedenza.

VR= is a varied plant with 3 levels. The system is equipped with 3 different kinds of keys: at the beginning the cylinder operates with the key that is countermarked in red (1 level). Afterwards, the green countermarked key (2 level) allows you to codify the cylinder annulling the efficacy of the first key (red). With the third kind of key, that is countermarked by black, it's possible to effect a further codification to invalidate the keys used before.



| | | |
|--|---|--------------|
| <p>■ IMPIANTI E FINITURE SPECIALI SPECIAL ARRANGEMENTS AND FINISHINGS</p> | <p>P. 10</p> | |
| <p>■ CHIAVI KEYS</p> |  | <p>P. 14</p> |
| <p>■ CILINDRI STANDARD STANDARD CYLINDERS</p> |  | <p>P. 17</p> |
| <p>■ CILINDRI X8 X8 CYLINDERS</p> |  | <p>P. 31</p> |
| <p>■ CILINDRI HS HS CYLINDERS</p> |  | <p>P. 37</p> |
| <p>■ CILINDRI HSP HSP CYLINDERS</p> |  | <p>P. 49</p> |
| <p>■ POMOLI KNOBS</p> |  | <p>P. 65</p> |
| <p>■ LUCCHETTI PADLOCKS</p> |  | <p>P. 67</p> |



| | | STANDARD | X8 | HS | HSP |
|-----------------|---|----------|----|----|-----|
| H29640N 1 FO | impianto chiave uguale 1 chiave per cilindro key alike system with 1 key for cylinder | | | | |
| H29640N 3 FO | impianto chiave uguale 3 chiavi per cilindro key alike system with 3 keys for cylinder | | | | |
| H29640N 0 FO MK | impianto a chiave maestra con 3 chiavi per cilindro masterkey system with 3 keys for cylinder mezzo cilindro e cil. con pomolo half cylinder and cyl. with knob doppio cilindro double cylinder | | | | |
| H29640N 0 FO GM | impianto a chiave maestra generale con 3 chiavi per cil. general masterkey system with 3 keys for cylinder mezzo cilindro e cil. con pomolo half cylinder and cyl. with knob doppio cilindro double cylinder | | | | |
| H29640N 4 FO CA | impianto a chiave cantiere 1+3 construction key system 1+3 mezzo cilindro e cil. con pomolo half cylinder and cyl. with knob doppio cilindro double cylinder | | | | |
| H29640N 4 FO CM | impianto a chiave cantiere maestra 1+3 construction masterkey system 1+3 mezzo cilindro e cil. con pomolo half cylinder and cyl. with knob doppio cilindro double cylinder | | | | |
| H29640N 0 FO VR | impianto vario 3 livelli "ROSSA" (1° liv.) "VERDE" (2° liv.) "NERA" (3° liv.) la chiave "VERDE" consente di ricodificare il cilindro, escludendo automaticamente la chiave "ROSSA" la chiave "NERA" consente una nuova ricodificazione del cilindro, escludendo tutte le chiavi usate in precedenza prezzo dell'impianto con 3 chiavi per cilindro vario 3 levels system "RED" (1° level) "GREEN" (2° level) "BLACK" (3° level) the "GREEN" key is used to recode the cylinder and to automatically exclude the "RED" key the "BLACK" key is used to recode the cylinder again and to exclude all previously used keys price for the system with 3 keys for cylinder mezzo cilindro e cil. con pomolo half cylinder and cyl. with knob doppio cilindro double cylinder | | | | |
| K06000 C | chiave cifrata in aggiunta o chiave MK-GMK additional coded key or MK-GMK key | | | | |
| K06000 D | uplicazione chiave key duplication | | | | |
| | cilindro smontato disassembled cylinder | | | | |

Per cilindri H18, H20, P18, P20 sono previsti solo impianti a chiave uguale
For the cylinders H18, H20, P18, P20 are foreseen just key alike systems

| | STANDARD | X8 | HS | HSP |
|---|--|----|----|-----|
| <p>... N ottone nichelato opaco matt nickel plated brass</p> | <p>mezzo cilindro e doppio cilindro half cylinder and double cylinder cilindri con pomolo cylinder with knob</p> | | | |
| <p>... L ottone lucido verniciato polished brass</p> | <p>mezzo cilindro e doppio cilindro half cylinder and double cylinder cilindri con pomolo cylinder with knob</p> | | | |
| <p>... C ottone cromo lucido * polished chrome plated brass</p> | <p>mezzo cilindro e doppio cilindro half cylinder and double cylinder cilindri con pomolo cylinder with knob</p> | | | |
| <p>... S ottone cromo satinato * satin chrome plated brass</p> | <p>mezzo cilindro e doppio cilindro half cylinder and double cylinder cilindri con pomolo cylinder with knob</p> | | | |
| <p>... B ottone bronzato * bronzed brass</p> | <p>mezzo cilindro e doppio cilindro half cylinder and double cylinder cilindri con pomolo cylinder with knob</p> | | | |

* minimo pz. 100 per articolo
minimum pcs. 100 for item

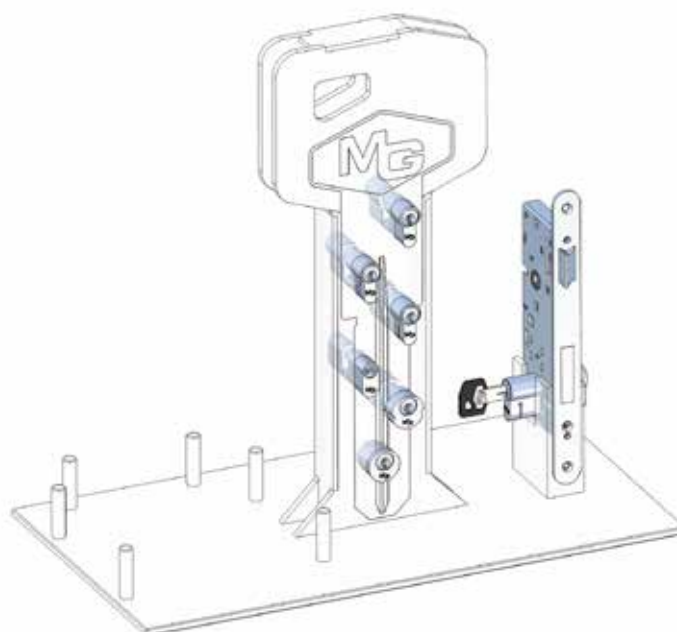

Espositore
Display stand

DATA: inserire la data corrente nel formato GG/MM/AAAA

DATE: enter the current date in format DD/MM/YYYY

CLIENTE: inserire i dati del cliente

CUSTOMER: enter the customer information

IMPIANTO: inserire il nome dell'impianto

CHART: enter the project name

CILINDRI: inserire i cilindri dell'impianto indicando la denominazione della porta (PORTE), il codice del cilindro (COD.ART.), la finitura (FINITURA), il tipo (TIPO), la quantità di cilindri (Q.tà) e la quantità di chiavi che aprano il singolo cilindro (N°CHIAVI).

CYLINDERS: enter the cylinder of system indicating the designation of door (DOORS), the cylinder's code (ARTICLE CODE), the finishing (FINISHING), the type (TYPE), the quantity of cylinders (Q.ty) and the quantity of keys that open the cylinder in question (N°KEYS).

CHIAVI: Inserire le chiavi maestre indicando la denominazione della chiave (NOME CHIAVE) e la quantità desiderata (Q.tà).

KEYS: enter the master key indicating the designation of key (KEY NAME) and the desired quantity (Q.ty).

IMPORTANTE: indicare con una "X", nella casella corrispondente tra la riga del cilindro e la colonna della chiave, quali cilindri dovrà aprire ogni chiave. Guardare l'esempio sottostante.

IMPORTANT: indicate by an "X", in the box at the intersection of the cylinder row and the key column, what cylinder must open for each key. Look the sample below.

| | | | | | | | | | | | | | | |
|--|-------------------|---|------------------------|--|---------------|--|---|---|---|--------------------|----------------------|--------------------|--------------------|--------------------|
| <p>MG SERRATURE s.p.a. Via Monte Rosa, 29/31 - 20824 - LAZZATE (MB) tel. +39 02 96720008 - 96320160 - fax+39 02 96329155 www.mgserrature.it</p> | | <p>SVILUPPO IMPIANTO CON CHIAVI MAESTRE <i>CHART FOR MASTER-KEY SYSTEM</i></p> | | <p style="writing-mode: vertical-rl; transform: rotate(180deg);">CHIAVI / KEYS Q.TY / Q.TY</p> | | 3 | 3 | 3 | 3 | 3 | | | | |
| | | | | | | 3 | 3 | 3 | 3 | 3 | | | | |
| <p>DATA/DATE: 02/08/2001 COD.CLIENTE: _____ N°ORD. _____</p> | | <p>CLIENTE/CUSTOMER Ferramenta Chiodino S.r.l.</p> | | <p>COMPILATORE/AUTHOR Sig. Chiodino Antonio</p> | | <p>IMPIANTO/CHART Nuovi Uffici Dott. Bianchi</p> | | <p style="writing-mode: vertical-rl; transform: rotate(180deg);">NOME CHIAVE / KEY NAME</p> | | <p>1 DIREZIONE</p> | <p>2 MANUTENTORE</p> | <p>3 UFFICIO A</p> | <p>4 UFFICIO B</p> | <p>5 UFFICIO C</p> |
| <p style="text-align: center;">CILINDRI / CYLINDERS</p> | | | | | | | | | | | | | | |
| N | PORTE/DOORS | COD.ART/ ARTICLE CODE | FINITURA/ FINISHING | TIPO/ TYPE | Q.tà/ Q.ty | N°CHIAVI /N°KEYS | 1 | 2 | 3 | 4 | 5 | | | |
| 1 | Ingresso generale | 015640 | NKO | | 1 | 3 | X | X | | | | | | |
| 2 | Locale caldaia | 015640 | NKO | | 1 | 3 | X | X | | | | | | |
| 3 | Sala riunioni | 015842 | NKO | KA | 2 | 3 | X | | | | | | | |
| 4 | Ufficio A | 015842 | NKO | | 1 | 3 | X | | X | | | | | |
| 5 | Ufficio B | 015842 | NKO | | 1 | 3 | X | | | X | | | | |
| 6 | Ufficio C | 015842 | NKO | | 1 | 3 | X | | | | X | | | |
| 7 | Ufficio direzione | 015842 | NKO | | 1 | 3 | X | | | | | | | |

N.B.: Il campo "COD.CLIENTE" e "N°ORD." non devono essere compilati; al momento dell'ordine occorre specificare se si prevedono ampliamenti. In caso contrario potrebbe essere difficile farli. Per ogni dubbio contattare MG Serrature S.p.A.

N.B.: the fields "COD.CLIENTE" and "N°ORD." must not be completed; when ordering, specify the possibility of eventual increase. If not specified it will be difficult do it. For every doubt contact MG Serrature S.p.A.



MG SERRATURE s.p.a.
 Via Monte Rosa, 29/31 - 20824 - LAZZATE (MB)
 tel. +39 02 96720008 - fax+39 02 96329155
 www.mgserrature.it

SVILUPPO IMPIANTO CON CHIAVI MAESTRE
 CHART FOR MASTER-KEY SYSTEM

DATA/DATE: ___/___/___ COD. CLIENTE: _____ N° ORD. _____
 CLIENTE/CUSTOMER _____
 COMPILATORE/AUTHOR _____
 IMPIANTO/CHART _____

CILINDRI/CYLINDERS
 PORTE/DOORS
 COD. ART. / ARTICLE CODE
 FINITURA / FINISHING TYPE
 N° CHIAVI / N° KEYS
 Q.TA / Q.TY

| N | PORTE/DOORS | COD. ART. / ARTICLE CODE | FINITURA / FINISHING TYPE | Q.TA / Q.TY | N° CHIAVI / N° KEYS |
|----|-------------|--------------------------|---------------------------|-------------|---------------------|
| 1 | | | | | |
| 2 | | | | | |
| 3 | | | | | |
| 4 | | | | | |
| 5 | | | | | |
| 6 | | | | | |
| 7 | | | | | |
| 8 | | | | | |
| 9 | | | | | |
| 10 | | | | | |
| 11 | | | | | |
| 12 | | | | | |
| 13 | | | | | |
| 14 | | | | | |
| 15 | | | | | |
| 16 | | | | | |
| 17 | | | | | |
| 18 | | | | | |
| 19 | | | | | |
| 20 | | | | | |
| 21 | | | | | |
| 22 | | | | | |
| 23 | | | | | |
| 24 | | | | | |
| 25 | | | | | |
| 26 | | | | | |
| 27 | | | | | |
| 28 | | | | | |
| 29 | | | | | |

| N | CHIAVI/KEYS | NOME CHIAVE/KEY NAME | Q.TA/Q.TY |
|----|-------------|----------------------|-----------|
| 1 | | | |
| 2 | | | |
| 3 | | | |
| 4 | | | |
| 5 | | | |
| 6 | | | |
| 7 | | | |
| 8 | | | |
| 9 | | | |
| 10 | | | |
| 11 | | | |
| 12 | | | |
| 13 | | | |
| 14 | | | |
| 15 | | | |
| 16 | | | |
| 17 | | | |
| 18 | | | |
| 19 | | | |
| 20 | | | |
| 21 | | | |
| 22 | | | |
| 23 | | | |
| 24 | | | |
| 25 | | | |
| 26 | | | |
| 27 | | | |
| 28 | | | |
| 29 | | | |
| 30 | | | |
| 31 | | | |
| 32 | | | |
| 33 | | | |
| 34 | | | |

Ottone nichelato per art. 145-551

Nickel-plated brass for art. 145-551



K011300

K012400



K013500

K014600

| | L | codice code | euro | | |
|--|---|-----------------|------|----|--|
| | | K0113 00 | | 50 | |
| | | K0124 00 | | 50 | |
| | | K0135 00 | | 50 | |
| | | K0146 00 | | 50 | |

Ottone nichelato - normale per art. 010-011-012-013-014-015-017-019-025-027

Nickel-plated brass for art. 010-011-012-013-014-015-017-019-025-027



| | | L | codice code | euro | | |
|---|----------------------|------|-----------------|------|-----|--|
| 4 | destra right | 24 | K0304 10 | | 100 | |
| 4 | sinistra left | 24 | K0304 20 | | 100 | |
| 5 | destra right | 27,8 | K0305 10 | | 100 | |
| 5 | sinistra left | 27,8 | K0305 20 | | 100 | |

Ottone nichelato - piccola per art. 018-020-021-026-028

Nickel-plated brass - small for art. 018-020-021-026-028



| | | L | codice code | euro | | |
|---|----------------------|------|-----------------|------|-----|--|
| 4 | destra right | 22 | K0404 10 | | 100 | |
| 4 | sinistra left | 22 | K0404 20 | | 100 | |
| 5 | destra right | 23,7 | K0405 10 | | 100 | |
| 5 | sinistra left | 23,7 | K0405 20 | | 100 | |

Ottone nichelato - simmetrica per art. 008

Nickel-plated brass - symmetric for art. 008



| | L | codice code | euro | | |
|---|------|-----------------|------|-----|--|
| 5 | 27,8 | K0500 00 | | 100 | |

Chiave rev. in alpacca con impugnatura riv. in plastica e collo lungo per cil. HS
 Rev. nickel silver key with plastic-coated grip and long neck for cyl. HS



HS

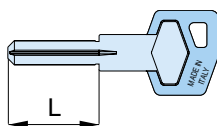

| | | L | codice code | euro | |
|----|------------------|------|-----------------|------|----|
| 15 | grezza key-black | 27,8 | K0600 00 | | 50 |

Chiave rev. in alpacca con impugnatura riv. in plastica e collo lungo per cil. HSP
 Rev. nickel silver key with plastic-coated grip and long neck for cyl. HSP



HSP

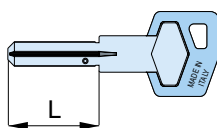

| | | L | codice code | euro | |
|----|------------------|------|-----------------|------|----|
| 15 | grezza key-black | 27,8 | K0700 00 | | 50 |

Riservata agli "MG POINT"
 Reserved to "MG POINT"

SISTEMA BREVETTATO: CHIAVE CON ELEMENTO MOBILE
 PATENTED SYSTEM: KEY WITH MOBILE ELEMENT

Chiave reversibile in ottone nichelato per cil. X8
 Reversible nickel plated brass key for cyl. X8



X8

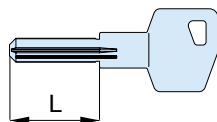

| | | L | codice code | euro | |
|---|--|------|-----------------|------|----|
| 8 | | 27,8 | K0800 00 | | 50 |

Impugnatura per chiavi K06 - K07 - K08
 Cover for keys K06 - K07 - K08



Colori: blu, verde, rosso
 Colors: blue, green, red

| | | | codice code | euro | |
|--|--|--|-----------------|------|----|
| | | | A2900 00 | | 50 |



**CHIAVI
keys**



■ **CILINDRI DA APPLICARE**
RIM CYLINDERS



P. 19

■ **CILINDRI DA INFILARE**
MORTICE CYLINDERS



P. 21

■ **CILINDRI OVALI**
OVAL CYLINDERS



P. 26 - 29

■ **CILINDRI Ø 26**
Ø 26 CYLINDERS



P. 26 - 29

■ **CILINDRI Ø 22**
Ø 22 CYLINDERS



P. 26 - 29

■ **CILINDRI A GROCE**
CROSS KEY CYLINDERS



P. 29

- ✓ **Corpo in ottone**
Brass body
- ✓ **Perni e controperni in ottone**
Brass pins
- ✓ **Molle in acciaio inox**
Stainless steel springs
- ✓ **Camma DIN (cilindri da infilare)**
DIN cam (mortice cylinders)
- ✓ **3 chiavi in ottone nichelato**
3 keys in nickel plated brass



Cilindro - per art. 435 - 602
 Cylinder - for art. 435 - 602

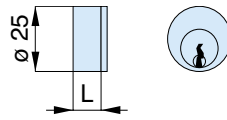

| | A | B | C | D | L | codice code | euro | |
|---|---|---|---|---|----|-------------------|------|----|
| 3 | | | | | 11 | 008110 000 | | 10 |

Cilindro - per art. 611
 Cylinder - for art. 611

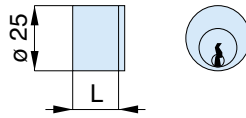

| | A | B | C | D | L | codice code | euro | |
|---|---|---|---|---|----|-------------------|------|----|
| 4 | | | | | 18 | 010180 000 | | 10 |
| 5 | | | | | 28 | 010280 000 | | 10 |

Cilindro - per art. 711
 Cylinder - for art. 711

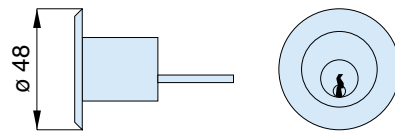

| | A | B | C | D | L | codice code | euro | |
|---|---|---|---|---|---|-------------------|------|----|
| 5 | | | | | | 011000 000 | | 10 |



Cilindro - per art. 712
Cylinder - for art. 712

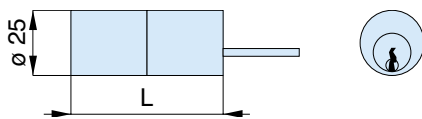

| | A | B | C | D | L | codice code | euro | | |
|---|---|---|---|---|----|----------------|------|--|--|
| 5 | | | | | 35 | 012350 000 | 10 | | |
| 5 | | | | | 40 | 012400 000 | 10 | | |
| 5 | | | | | 50 | 012500 000 | 10 | | |
| 5 | | | | | 60 | 012600 000 | 10 | | |
| 5 | | | | | 70 | 012700 000 | 10 | | |
| 5 | | | | | 80 | 012800 000 | 10 | | |

Coppia cilindri per art. 127-147-255-343-433
Double rim cylinder for art. 127-147-255-343-433

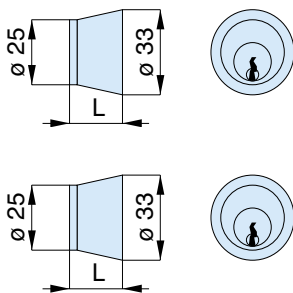

| | A | B | C | D | L | codice code | euro | | |
|---|---|---|---|---|----|----------------|------|--|--|
| 4 | | | | | 20 | 013200 000 | 10 | | |

Coppia cilindri per art. 436
Double rim cylinder for art. 436

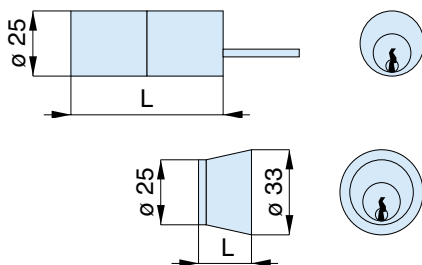

| | A | B | C | D | L | codice code | euro | | |
|---|---|---|---|---|----|----------------|------|--|--|
| 4 | | | | | 50 | 014500 000 | 10 | | |

Doppio cilindro
Double cylinder

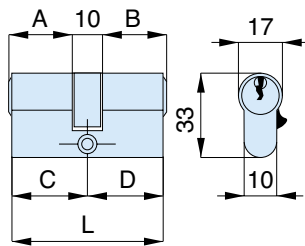

| ▽ | A | B | C | D | L | codice code | euro | | |
|---|----|----|----|----|-----|----------------|--------|-----|----|
| 4 | 23 | 10 | 23 | 27 | 27 | 54 | 015560 | 000 | 10 |
| 4 | 23 | 10 | 27 | 27 | 31 | 58 | 015600 | 000 | 10 |
| 5 | 27 | 10 | 27 | 31 | 31 | 62 | 015640 | 000 | 10 |
| 4 | 23 | 10 | 33 | 27 | 37 | 64 | 015660 | 000 | 10 |
| 5 | 27 | 10 | 31 | 31 | 35 | 66 | 015680 | 000 | 10 |
| 4 | 23 | 10 | 37 | 27 | 41 | 68 | 015701 | 000 | 10 |
| 5 | 27 | 10 | 33 | 31 | 37 | 68 | 015702 | 000 | 10 |
| 5 | 31 | 10 | 31 | 35 | 35 | 70 | 015720 | 000 | 10 |
| 5 | 27 | 10 | 37 | 31 | 41 | 72 | 015740 | 000 | 10 |
| 5 | 33 | 10 | 33 | 37 | 37 | 74 | 015760 | 000 | 10 |
| 4 | 23 | 10 | 47 | 27 | 51 | 78 | 015801 | 000 | 10 |
| 5 | 33 | 10 | 37 | 37 | 41 | 78 | 015802 | 000 | 10 |
| 5 | 31 | 10 | 41 | 35 | 45 | 80 | 015820 | 000 | 10 |
| 5 | 27 | 10 | 47 | 31 | 51 | 82 | 015841 | 000 | 10 |
| 5 | 37 | 10 | 37 | 41 | 41 | 82 | 015842 | 000 | 10 |
| 5 | 33 | 10 | 43 | 37 | 47 | 84 | 015860 | 000 | 10 |
| 5 | 33 | 10 | 47 | 37 | 51 | 88 | 015901 | 000 | 10 |
| 5 | 37 | 10 | 43 | 41 | 47 | 88 | 015902 | 000 | 10 |
| 5 | 27 | 10 | 57 | 31 | 61 | 92 | 015941 | 000 | 10 |
| 5 | 37 | 10 | 47 | 41 | 51 | 92 | 015942 | 000 | 10 |
| 5 | 43 | 10 | 43 | 47 | 47 | 94 | 015960 | 000 | 10 |
| 5 | 27 | 10 | 67 | 31 | 71 | 102 | 015041 | 000 | 10 |
| 5 | 37 | 10 | 57 | 41 | 61 | 102 | 015042 | 000 | 10 |
| 5 | 47 | 10 | 47 | 51 | 51 | 102 | 015043 | 000 | 10 |
| 5 | 27 | 10 | 77 | 31 | 81 | 112 | 015141 | 000 | 10 |
| 5 | 37 | 10 | 67 | 41 | 71 | 112 | 015142 | 000 | 10 |
| 5 | 47 | 10 | 57 | 51 | 61 | 112 | 015143 | 000 | 10 |
| 5 | 27 | 10 | 87 | 31 | 91 | 122 | 015241 | 000 | 10 |
| 5 | 37 | 10 | 77 | 41 | 81 | 122 | 015242 | 000 | 10 |
| 5 | 47 | 10 | 67 | 51 | 71 | 122 | 015243 | 000 | 10 |
| 5 | 57 | 10 | 57 | 61 | 61 | 122 | 015244 | 000 | 10 |
| 5 | 27 | 10 | 97 | 31 | 101 | 132 | 015341 | 000 | 10 |
| 5 | 37 | 10 | 87 | 41 | 91 | 132 | 015342 | 000 | 10 |
| 5 | 47 | 10 | 77 | 51 | 81 | 132 | 015343 | 000 | 10 |
| 5 | 57 | 10 | 67 | 61 | 71 | 132 | 015344 | 000 | 10 |

Mezzo cilindro con camma regolabile in 8 posizioni
Half cylinder with adjustable cam in 8 positions

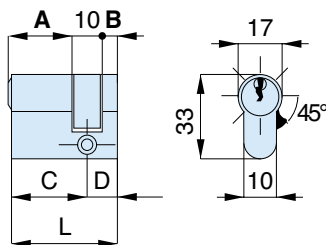

| ▽ | A | B | C | D | L | codice code | euro | | |
|---|----|----|---|-----|----|----------------|--------|-----|----|
| 3 | 17 | 10 | 5 | 21 | 10 | 31 | 017320 | 000 | 10 |
| 4 | 23 | 10 | 5 | 27 | 10 | 37 | 017380 | 000 | 10 |
| 5 | 27 | 10 | 5 | 31 | 10 | 41 | 017420 | 000 | 10 |
| 5 | 31 | 10 | 5 | 35 | 10 | 45 | 017460 | 000 | 10 |
| 5 | 33 | 10 | 5 | 37 | 10 | 47 | 017480 | 000 | 10 |
| 5 | 37 | 10 | 5 | 41 | 10 | 51 | 017520 | 000 | 10 |
| 5 | 43 | 10 | 5 | 47 | 10 | 57 | 017580 | 000 | 10 |
| 5 | 47 | 10 | 5 | 51 | 10 | 61 | 017620 | 000 | 10 |
| 5 | 57 | 10 | 5 | 61 | 10 | 71 | 017720 | 000 | 10 |
| 5 | 67 | 10 | 5 | 71 | 10 | 81 | 017820 | 000 | 10 |
| 5 | 77 | 10 | 5 | 81 | 10 | 91 | 017920 | 000 | 10 |
| 5 | 87 | 10 | 5 | 91 | 10 | 101 | 017020 | 000 | 10 |
| 5 | 97 | 10 | 5 | 101 | 10 | 111 | 017120 | 000 | 10 |



Doppio cilindro con pomolo ottone lucido
Double cylinder with polished brass knob

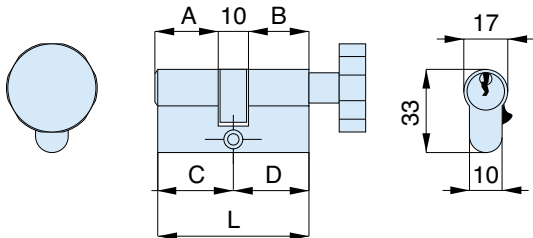

CILINDRI DA INFILARE IN OTTONE
brass mortice cylinders

| | A | B | C | D | L | codice code | euro | | |
|---|----|----|----|----|-----|----------------|--------|-----|----|
| 4 | 23 | 10 | 23 | 27 | 27 | 54 | 025560 | 00R | 10 |
| 4 | 23 | 10 | 27 | 27 | 31 | 58 | 025600 | 00R | 10 |
| 5 | 27 | 10 | 27 | 31 | 31 | 62 | 025640 | 00R | 10 |
| 4 | 23 | 10 | 33 | 27 | 37 | 64 | 025660 | 00R | 10 |
| 5 | 27 | 10 | 31 | 31 | 35 | 66 | 025681 | 00R | 10 |
| 5 | 31 | 10 | 27 | 35 | 31 | 66 | 025682 | 00R | 10 |
| 4 | 23 | 10 | 37 | 27 | 41 | 68 | 025701 | 00R | 10 |
| 5 | 27 | 10 | 33 | 31 | 37 | 68 | 025702 | 00R | 10 |
| 4 | 33 | 10 | 27 | 37 | 31 | 68 | 025705 | 00R | 10 |
| 5 | 31 | 10 | 31 | 35 | 35 | 70 | 025720 | 00R | 10 |
| 5 | 27 | 10 | 37 | 31 | 41 | 72 | 025741 | 00R | 10 |
| 5 | 37 | 10 | 27 | 41 | 31 | 72 | 025742 | 00R | 10 |
| 4 | 33 | 10 | 33 | 37 | 37 | 74 | 025760 | 00R | 10 |
| 4 | 23 | 10 | 47 | 27 | 51 | 78 | 025801 | 00R | 10 |
| 4 | 33 | 10 | 37 | 37 | 41 | 78 | 025802 | 00R | 10 |
| 5 | 31 | 10 | 41 | 35 | 45 | 80 | 025821 | 00R | 10 |
| 5 | 41 | 10 | 31 | 45 | 35 | 80 | 025822 | 00R | 10 |
| 5 | 27 | 10 | 47 | 31 | 51 | 82 | 025841 | 00R | 10 |
| 5 | 47 | 10 | 27 | 51 | 31 | 82 | 025842 | 00R | 10 |
| 5 | 37 | 10 | 37 | 41 | 41 | 82 | 025843 | 00R | 10 |
| 4 | 33 | 10 | 43 | 37 | 47 | 84 | 025860 | 00R | 10 |
| 4 | 33 | 10 | 47 | 37 | 51 | 88 | 025901 | 00R | 10 |
| 5 | 37 | 10 | 43 | 41 | 47 | 88 | 025902 | 00R | 10 |
| 5 | 27 | 10 | 57 | 31 | 61 | 92 | 025941 | 00R | 10 |
| 5 | 37 | 10 | 47 | 41 | 51 | 92 | 025942 | 00R | 10 |
| 5 | 47 | 10 | 37 | 51 | 41 | 92 | 025943 | 00R | 10 |
| 5 | 57 | 10 | 27 | 61 | 31 | 92 | 025945 | 00R | 10 |
| 4 | 43 | 10 | 43 | 47 | 47 | 94 | 025960 | 00R | 10 |
| 5 | 27 | 10 | 67 | 31 | 71 | 102 | 025041 | 00R | 10 |
| 5 | 37 | 10 | 57 | 41 | 61 | 102 | 025042 | 00R | 10 |
| 5 | 47 | 10 | 47 | 51 | 51 | 102 | 025043 | 00R | 10 |
| 5 | 57 | 10 | 37 | 61 | 41 | 102 | 025045 | 00R | 10 |
| 5 | 67 | 10 | 27 | 71 | 31 | 102 | 025046 | 00R | 10 |
| 5 | 27 | 10 | 77 | 31 | 81 | 112 | 025141 | 00R | 10 |
| 5 | 37 | 10 | 67 | 41 | 71 | 112 | 025142 | 00R | 10 |
| 5 | 47 | 10 | 57 | 51 | 61 | 112 | 025143 | 00R | 10 |
| 5 | 57 | 10 | 47 | 61 | 51 | 112 | 025145 | 00R | 10 |
| 5 | 67 | 10 | 37 | 71 | 41 | 112 | 025146 | 00R | 10 |
| 5 | 77 | 10 | 27 | 81 | 31 | 112 | 025147 | 00R | 10 |
| 5 | 27 | 10 | 87 | 31 | 91 | 122 | 025241 | 00R | 10 |
| 5 | 37 | 10 | 77 | 41 | 81 | 122 | 025242 | 00R | 10 |
| 5 | 47 | 10 | 67 | 51 | 71 | 122 | 025243 | 00R | 10 |
| 5 | 57 | 10 | 57 | 61 | 61 | 122 | 025244 | 00R | 10 |
| 5 | 67 | 10 | 47 | 71 | 51 | 122 | 025245 | 00R | 10 |
| 5 | 77 | 10 | 37 | 81 | 41 | 122 | 025246 | 00R | 10 |
| 5 | 27 | 10 | 97 | 31 | 101 | 132 | 025341 | 00R | 10 |
| 5 | 37 | 10 | 87 | 41 | 91 | 132 | 025342 | 00R | 10 |
| 5 | 47 | 10 | 77 | 51 | 81 | 132 | 025343 | 00R | 10 |
| 5 | 57 | 10 | 67 | 61 | 71 | 132 | 025344 | 00R | 10 |
| 5 | 67 | 10 | 57 | 71 | 61 | 132 | 025345 | 00R | 10 |

Doppio cilindro con pomolo ottone lucido
 Double cylinder with polished brass knob

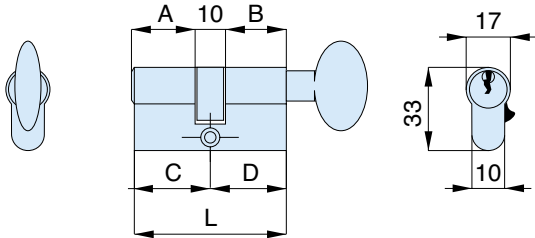
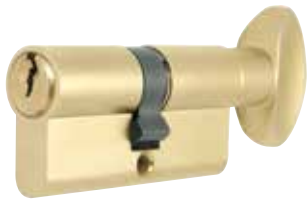

| ▽ | A | B | C | D | L | codice code | euro | | |
|---|----|----|----|----|-----|----------------|--------|-----|----|
| 4 | 23 | 10 | 23 | 27 | 27 | 54 | 025560 | 00F | 10 |
| 4 | 23 | 10 | 27 | 27 | 31 | 58 | 025600 | 00F | 10 |
| 5 | 27 | 10 | 27 | 31 | 31 | 62 | 025640 | 00F | 10 |
| 4 | 23 | 10 | 33 | 27 | 37 | 64 | 025660 | 00F | 10 |
| 5 | 27 | 10 | 31 | 31 | 35 | 66 | 025681 | 00F | 10 |
| 5 | 31 | 10 | 27 | 35 | 31 | 66 | 025682 | 00F | 10 |
| 4 | 23 | 10 | 37 | 27 | 41 | 68 | 025701 | 00F | 10 |
| 5 | 27 | 10 | 33 | 31 | 37 | 68 | 025702 | 00F | 10 |
| 4 | 33 | 10 | 27 | 37 | 31 | 68 | 025705 | 00F | 10 |
| 5 | 31 | 10 | 31 | 35 | 35 | 70 | 025720 | 00F | 10 |
| 5 | 27 | 10 | 37 | 31 | 41 | 72 | 025741 | 00F | 10 |
| 5 | 37 | 10 | 27 | 41 | 31 | 72 | 025742 | 00F | 10 |
| 4 | 33 | 10 | 33 | 37 | 37 | 74 | 025760 | 00F | 10 |
| 4 | 23 | 10 | 47 | 27 | 51 | 78 | 025801 | 00F | 10 |
| 4 | 33 | 10 | 37 | 37 | 41 | 78 | 025802 | 00F | 10 |
| 5 | 31 | 10 | 41 | 35 | 45 | 80 | 025821 | 00F | 10 |
| 5 | 41 | 10 | 31 | 45 | 35 | 80 | 025822 | 00F | 10 |
| 5 | 27 | 10 | 47 | 31 | 51 | 82 | 025841 | 00F | 10 |
| 5 | 47 | 10 | 27 | 51 | 31 | 82 | 025842 | 00F | 10 |
| 5 | 37 | 10 | 37 | 41 | 41 | 82 | 025843 | 00F | 10 |
| 4 | 33 | 10 | 43 | 37 | 47 | 84 | 025860 | 00F | 10 |
| 4 | 33 | 10 | 47 | 37 | 51 | 88 | 025901 | 00F | 10 |
| 5 | 37 | 10 | 43 | 41 | 47 | 88 | 025902 | 00F | 10 |
| 5 | 27 | 10 | 57 | 31 | 61 | 92 | 025941 | 00F | 10 |
| 5 | 37 | 10 | 47 | 41 | 51 | 92 | 025942 | 00F | 10 |
| 5 | 47 | 10 | 37 | 51 | 41 | 92 | 025943 | 00F | 10 |
| 5 | 57 | 10 | 27 | 61 | 31 | 92 | 025945 | 00F | 10 |
| 4 | 43 | 10 | 43 | 47 | 47 | 94 | 025960 | 00F | 10 |
| 5 | 27 | 10 | 67 | 31 | 71 | 102 | 025041 | 00F | 10 |
| 5 | 37 | 10 | 57 | 41 | 61 | 102 | 025042 | 00F | 10 |
| 5 | 47 | 10 | 47 | 51 | 51 | 102 | 025043 | 00F | 10 |
| 5 | 57 | 10 | 37 | 61 | 41 | 102 | 025045 | 00F | 10 |
| 5 | 67 | 10 | 27 | 71 | 31 | 102 | 025046 | 00F | 10 |
| 5 | 27 | 10 | 77 | 31 | 81 | 112 | 025141 | 00F | 10 |
| 5 | 37 | 10 | 67 | 41 | 71 | 112 | 025142 | 00F | 10 |
| 5 | 47 | 10 | 57 | 51 | 61 | 112 | 025143 | 00F | 10 |
| 5 | 57 | 10 | 47 | 61 | 51 | 112 | 025145 | 00F | 10 |
| 5 | 67 | 10 | 37 | 71 | 41 | 112 | 025146 | 00F | 10 |
| 5 | 77 | 10 | 27 | 81 | 31 | 112 | 025147 | 00F | 10 |
| 5 | 27 | 10 | 87 | 31 | 91 | 122 | 025241 | 00F | 10 |
| 5 | 37 | 10 | 77 | 41 | 81 | 122 | 025242 | 00F | 10 |
| 5 | 47 | 10 | 67 | 51 | 71 | 122 | 025243 | 00F | 10 |
| 5 | 57 | 10 | 57 | 61 | 61 | 122 | 025244 | 00F | 10 |
| 5 | 67 | 10 | 47 | 71 | 51 | 122 | 025245 | 00F | 10 |
| 5 | 77 | 10 | 37 | 81 | 41 | 122 | 025246 | 00F | 10 |
| 5 | 27 | 10 | 97 | 31 | 101 | 132 | 025341 | 00F | 10 |
| 5 | 37 | 10 | 87 | 41 | 91 | 132 | 025342 | 00F | 10 |
| 5 | 47 | 10 | 77 | 51 | 81 | 132 | 025343 | 00F | 10 |
| 5 | 57 | 10 | 67 | 61 | 71 | 132 | 025344 | 00F | 10 |
| 5 | 67 | 10 | 57 | 71 | 61 | 132 | 025345 | 00F | 10 |

CILINDRI DA INFILARE IN OTTONE
 brass mortice cylinders





Doppio cilindro predisposto pomolo
Double cylinder with knob provision

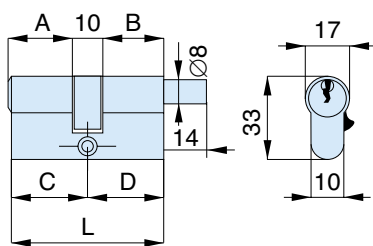

| | A | B | C | D | L | codice code | euro | |
|---|----|----|----|----|-----|----------------|------------|----|
| 4 | 23 | 10 | 23 | 27 | 27 | 54 | 025560 00C | 10 |
| 4 | 23 | 10 | 27 | 27 | 31 | 58 | 025600 00C | 10 |
| 5 | 27 | 10 | 27 | 31 | 31 | 62 | 025640 00C | 10 |
| 4 | 23 | 10 | 33 | 27 | 37 | 64 | 025660 00C | 10 |
| 5 | 27 | 10 | 31 | 31 | 35 | 66 | 025681 00C | 10 |
| 5 | 31 | 10 | 27 | 35 | 31 | 66 | 025682 00C | 10 |
| 4 | 23 | 10 | 37 | 27 | 41 | 68 | 025701 00C | 10 |
| 5 | 27 | 10 | 33 | 31 | 37 | 68 | 025702 00C | 10 |
| 4 | 33 | 10 | 27 | 37 | 31 | 68 | 025705 00C | 10 |
| 5 | 31 | 10 | 31 | 35 | 35 | 70 | 025720 00C | 10 |
| 5 | 27 | 10 | 37 | 31 | 41 | 72 | 025741 00C | 10 |
| 5 | 37 | 10 | 27 | 41 | 31 | 72 | 025742 00C | 10 |
| 4 | 33 | 10 | 33 | 37 | 37 | 74 | 025760 00C | 10 |
| 4 | 23 | 10 | 47 | 27 | 51 | 78 | 025801 00C | 10 |
| 4 | 33 | 10 | 37 | 37 | 41 | 78 | 025802 00C | 10 |
| 5 | 31 | 10 | 41 | 35 | 45 | 80 | 025821 00C | 10 |
| 5 | 41 | 10 | 31 | 45 | 35 | 80 | 025822 00C | 10 |
| 5 | 27 | 10 | 47 | 31 | 51 | 82 | 025841 00C | 10 |
| 5 | 47 | 10 | 27 | 51 | 31 | 82 | 025842 00C | 10 |
| 5 | 37 | 10 | 37 | 41 | 41 | 82 | 025843 00C | 10 |
| 4 | 33 | 10 | 43 | 37 | 47 | 84 | 025860 00C | 10 |
| 4 | 33 | 10 | 47 | 37 | 51 | 88 | 025901 00C | 10 |
| 5 | 37 | 10 | 43 | 41 | 47 | 88 | 025902 00C | 10 |
| 5 | 27 | 10 | 57 | 31 | 61 | 92 | 025941 00C | 10 |
| 5 | 37 | 10 | 47 | 41 | 51 | 92 | 025942 00C | 10 |
| 5 | 47 | 10 | 37 | 51 | 41 | 92 | 025943 00C | 10 |
| 5 | 57 | 10 | 27 | 61 | 31 | 92 | 025945 00C | 10 |
| 4 | 43 | 10 | 43 | 47 | 47 | 94 | 025960 00C | 10 |
| 5 | 27 | 10 | 67 | 31 | 71 | 102 | 025041 00C | 10 |
| 5 | 37 | 10 | 57 | 41 | 61 | 102 | 025042 00C | 10 |
| 5 | 47 | 10 | 47 | 51 | 51 | 102 | 025043 00C | 10 |
| 5 | 57 | 10 | 37 | 61 | 41 | 102 | 025045 00C | 10 |
| 5 | 67 | 10 | 27 | 71 | 31 | 102 | 025046 00C | 10 |
| 5 | 27 | 10 | 77 | 31 | 81 | 112 | 025141 00C | 10 |
| 5 | 37 | 10 | 67 | 41 | 71 | 112 | 025142 00C | 10 |
| 5 | 47 | 10 | 57 | 51 | 61 | 112 | 025143 00C | 10 |
| 5 | 57 | 10 | 47 | 61 | 51 | 112 | 025145 00C | 10 |
| 5 | 67 | 10 | 37 | 71 | 41 | 112 | 025146 00C | 10 |
| 5 | 77 | 10 | 27 | 81 | 31 | 112 | 025147 00C | 10 |
| 5 | 27 | 10 | 87 | 31 | 91 | 122 | 025241 00C | 10 |
| 5 | 37 | 10 | 77 | 41 | 81 | 122 | 025242 00C | 10 |
| 5 | 47 | 10 | 67 | 51 | 71 | 122 | 025243 00C | 10 |
| 5 | 57 | 10 | 57 | 61 | 61 | 122 | 025244 00C | 10 |
| 5 | 67 | 10 | 47 | 71 | 51 | 122 | 025245 00C | 10 |
| 5 | 77 | 10 | 37 | 81 | 41 | 122 | 025246 00C | 10 |
| 5 | 27 | 10 | 97 | 31 | 101 | 132 | 025341 00C | 10 |
| 5 | 37 | 10 | 87 | 41 | 91 | 132 | 025342 00C | 10 |
| 5 | 47 | 10 | 77 | 51 | 81 | 132 | 025343 00C | 10 |
| 5 | 57 | 10 | 67 | 61 | 71 | 132 | 025344 00C | 10 |

Doppio cilindro predisposto pomolo
Double cylinder with knob provision

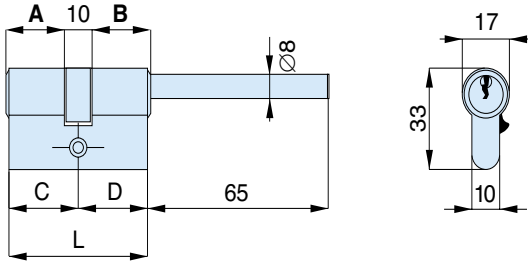

| | A | B | C | D | L | codice code | euro | |
|---|----|----|----|----|----|-------------|-------------------|----|
| 5 | 27 | 10 | 27 | 31 | 31 | 62 | 025640 00L | 10 |
| 5 | 31 | 10 | 27 | 35 | 31 | 66 | 025680 00L | 10 |
| 5 | 37 | 10 | 27 | 41 | 31 | 72 | 025740 00L | 10 |
| 5 | 47 | 10 | 27 | 51 | 31 | 82 | 025840 00L | 10 |
| 5 | 57 | 10 | 27 | 61 | 31 | 92 | 025940 00L | 10 |
| 5 | 67 | 10 | 27 | 71 | 31 | 102 | 025040 00L | 10 |

Doppio cilindro per porte di servizio
Double cylinder for toilet doors

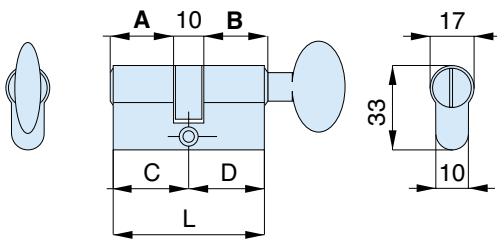
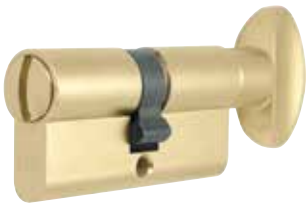

| | A | B | C | D | L | codice code | euro | |
|--|----|----|----|----|----|-------------|-------------------|----|
| | 23 | 10 | 23 | 27 | 27 | 54 | 025560 OWF | 10 |
| | 27 | 10 | 27 | 31 | 31 | 62 | 025640 OWF | 10 |
| | 31 | 10 | 31 | 35 | 35 | 70 | 025720 OWF | 10 |

Mezzo cilindro con pomolo piatto ottone lucido
Half cylinder with flat polished brass knob

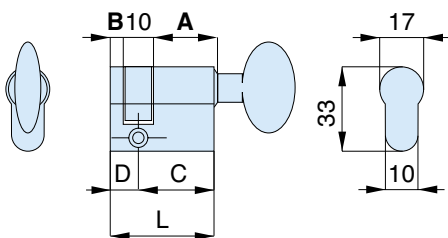

| | A | B | C | D | L | codice code | euro | |
|--|----|----|---|----|----|-------------|-------------------|----|
| | 23 | 10 | 5 | 27 | 10 | 37 | 025380 OMF | 10 |
| | 27 | 10 | 5 | 31 | 10 | 41 | 025420 OMF | 10 |
| | 31 | 10 | 5 | 35 | 10 | 45 | 025460 OMF | 10 |





Doppio cilindro ovale
Double oval cylinder

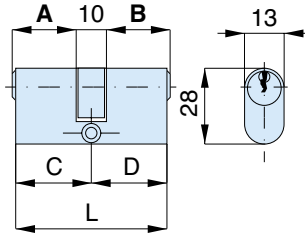

| ▽ | A | B | C | D | L | codice code | euro | | |
|---|----|----|----|----|----|----------------|------------|----|--|
| 5 | 23 | 10 | 23 | 28 | 28 | 56 | 018560 000 | 10 | |
| 5 | 25 | 10 | 25 | 30 | 30 | 60 | 018600 000 | 10 | |
| 5 | 23 | 10 | 30 | 28 | 35 | 63 | 018630 000 | 10 | |
| 5 | 23 | 10 | 37 | 28 | 42 | 70 | 018701 000 | 10 | |
| 5 | 30 | 10 | 30 | 35 | 35 | 70 | 018702 000 | 10 | |

Doppio cilindro Ø 26
Double cylinder Ø 26

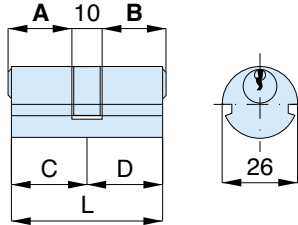

| ▽ | A | B | C | D | L | codice code | euro | | |
|---|----|----|----|----|----|----------------|------------|----|--|
| 4 | 23 | 10 | 23 | 27 | 27 | 54 | 019560 000 | 10 | |
| 4 | 23 | 10 | 27 | 27 | 31 | 58 | 019600 000 | 10 | |
| 5 | 27 | 10 | 27 | 31 | 31 | 62 | 019640 000 | 10 | |
| 4 | 23 | 10 | 37 | 27 | 41 | 68 | 019700 000 | 10 | |
| 5 | 31 | 10 | 31 | 35 | 35 | 70 | 019720 000 | 10 | |
| 4 | 23 | 10 | 47 | 27 | 51 | 78 | 019800 000 | 10 | |
| 5 | 37 | 10 | 37 | 41 | 41 | 82 | 019840 000 | 10 | |

Doppio cilindro Ø 22
Double cylinder Ø 22

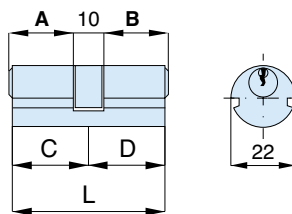

| ▽ | A | B | C | D | L | codice code | euro | | |
|---|----|----|----|----|----|----------------|------------|----|--|
| 4 | 21 | 10 | 21 | 26 | 26 | 52 | 020520 000 | 10 | |
| 5 | 23 | 10 | 23 | 28 | 28 | 56 | 020560 000 | 10 | |
| 5 | 25 | 10 | 25 | 30 | 30 | 60 | 020600 000 | 10 | |
| 5 | 23 | 10 | 30 | 28 | 35 | 63 | 020630 000 | 10 | |
| 5 | 23 | 10 | 37 | 28 | 42 | 70 | 020701 000 | 10 | |
| 5 | 30 | 10 | 30 | 35 | 35 | 70 | 020702 000 | 10 | |

Metà cilindro ovale
Half oval cylinder

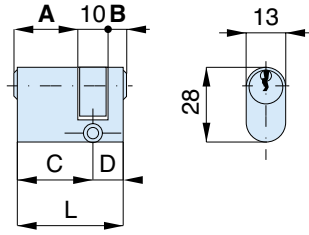

| ▼ | A | B | C | D | L | codice code | euro | |
|---|----|----|---|----|----|----------------|-------------------|----|
| 5 | 23 | 10 | 5 | 28 | 10 | 38 | 021380 000 | 10 |

Metà cilindro Ø 26 - Ø 22
Half cylinder Ø 26 - Ø 22

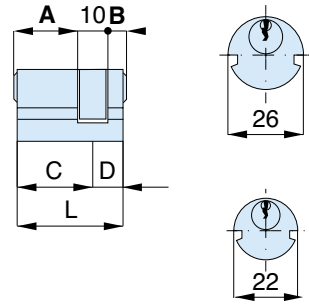

| ▼ | A | B | C | D | L | codice code | euro | |
|---|----|----|---|----|----|----------------|-------------------|----|
| 4 | 23 | 10 | 5 | 27 | 10 | 37 | 022381 000 | 10 |
| 5 | 23 | 10 | 5 | 28 | 10 | 38 | 022382 000 | 10 |

Doppio cilindro ovale con pomolo ottone lucido
Double oval cylinder with polished brass knob

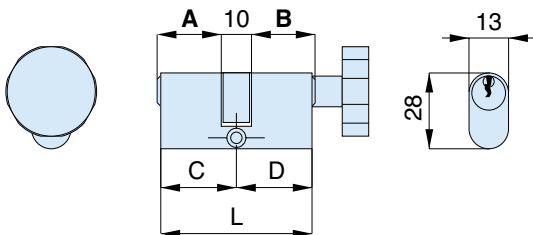

| ▼ | A | B | C | D | L | codice code | euro | |
|---|----|----|----|----|----|----------------|-------------------|----|
| 5 | 23 | 10 | 23 | 28 | 28 | 56 | 026560 00R | 10 |
| 5 | 30 | 10 | 23 | 35 | 28 | 63 | 026632 00R | 10 |





Doppio cilindro ovale con pomolo ottone lucido
Double oval cylinder with polished brass knob

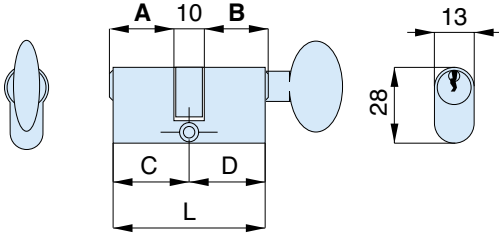

| | A | B | C | D | L | codice code | euro | |
|---|----|----|----|----|----|-------------|------|----|
| 5 | 23 | 10 | 23 | 28 | 28 | 026560 00F | | 10 |
| 5 | 30 | 10 | 23 | 35 | 28 | 026632 00F | | 10 |

Mezzo cilindro con pomolo ottone lucido
Half cylinder with polished brass knob

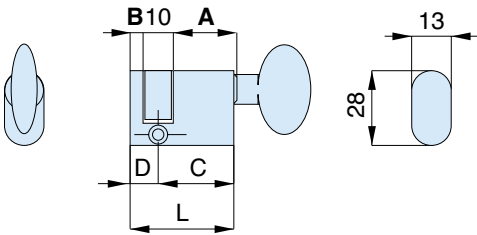

| | A | B | C | D | L | codice code | euro | |
|--|----|----|---|----|----|-------------|------|----|
| | 23 | 10 | 5 | 28 | 10 | 026380 0MF | | 10 |

Doppio cilindro Ø 26 con pomolo ottone lucido
Double cylinder Ø 26 with polished brass knob

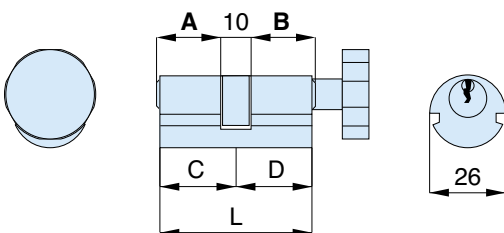

| | A | B | C | D | L | codice code | euro | |
|---|----|----|----|----|----|-------------|------|----|
| 4 | 23 | 10 | 23 | 27 | 27 | 027560 00R | | 10 |
| 4 | 23 | 10 | 27 | 27 | 31 | 027600 00R | | 10 |
| 5 | 27 | 10 | 27 | 31 | 31 | 027640 00R | | 10 |

Doppio cilindro Ø 22 con pomolo ottone lucido
 Double cylinder Ø 22 with polished brass knob

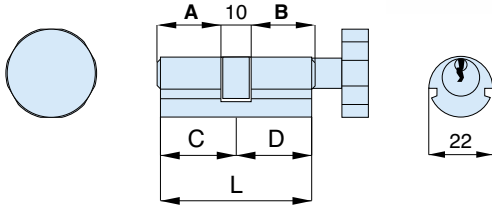

| | A | B | C | D | L | codice code | euro | |
|---|----|----|----|----|----|----------------|------|----|
| 5 | 23 | 10 | 23 | 28 | 28 | 028560 00R | | 10 |

Cilindro a croce per serie art. 930 - 950
 Cross key cylinder for series art. 930 - 950



| | A | B | C | D | L | codice code | euro | |
|--|---|---|---|---|---|----------------|------|----|
| | | | | | | 030000 000 | | 10 |



■ **CILINDRI DA APPLICARE**
RIM CYLINDERS



P. 33

■ **CILINDRI DA INFILARE**
MORTICE CYLINDERS



P. 33

- ✓ **Corpo in ottone**
Brass body
- ✓ **Perni e controperni in ottone**
Brass pins
- ✓ **Perni antitrapano**
Antidrilling steel pins
- ✓ **Molle in acciaio inox**
Stainless steel springs
- ✓ **Camma DIN (cilindri da infilare)**
DIN cam (mortice cylinders)
- ✓ **3 chiavi reversibili in ottone nichelato**
3 reversible nickel plated brass keys
- ✓ **Card**
Card
- ✓ **Vite di fissaggio**
Fixing screw

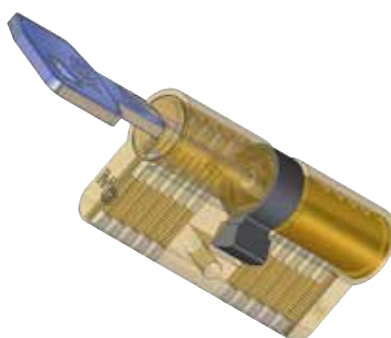

Cilindro per art. 712
Cylinder for art. 712



X8

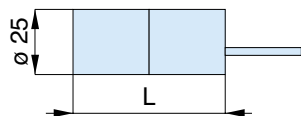

| ▽ | A | B | C | D | L | codice code | euro | |
|---|---|---|---|---|----|-------------------|------|---|
| 8 | | | | | 50 | X12500 000 | | 1 |
| | | | | | | 050 | | |
| | | | | | | N00 | | |

con 5 chiavi with 5 keys

nichel opaco matt nickel

Doppio cilindro
Double cylinder



X8

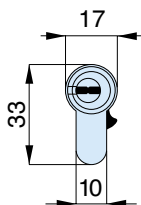
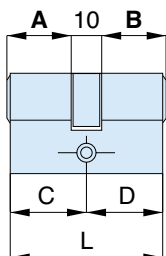

| ▽ | A | B | C | D | L | codice code | euro | |
|---|----|----|----|----|----|-------------|-------------------|---|
| 8 | 27 | 10 | 27 | 31 | 31 | 62 | X80640 000 | 1 |
| 8 | 27 | 10 | 31 | 31 | 35 | 66 | X80680 000 | 1 |
| 8 | 31 | 10 | 31 | 35 | 35 | 70 | X80720 000 | 1 |
| 8 | 27 | 10 | 37 | 31 | 41 | 72 | X80740 000 | 1 |
| 8 | 27 | 10 | 41 | 31 | 45 | 76 | X80781 000 | 1 |
| 8 | 31 | 10 | 37 | 35 | 41 | 76 | X80782 000 | 1 |
| 8 | 31 | 10 | 41 | 35 | 45 | 80 | X80820 000 | 1 |
| 8 | 27 | 10 | 47 | 31 | 51 | 82 | X80841 000 | 1 |
| 8 | 37 | 10 | 37 | 41 | 41 | 82 | X80842 000 | 1 |
| 8 | 27 | 10 | 51 | 31 | 55 | 86 | X80881 000 | 1 |
| 8 | 31 | 10 | 47 | 35 | 51 | 86 | X80882 000 | 1 |
| 8 | 37 | 10 | 41 | 41 | 45 | 86 | X80883 000 | 1 |
| 8 | 31 | 10 | 51 | 35 | 55 | 90 | X80921 000 | 1 |
| 8 | 41 | 10 | 41 | 45 | 45 | 90 | X80922 000 | 1 |
| 8 | 27 | 10 | 57 | 31 | 61 | 92 | X80941 000 | 1 |
| 8 | 37 | 10 | 47 | 41 | 51 | 92 | X80942 000 | 1 |
| 8 | 37 | 10 | 51 | 41 | 55 | 96 | X80981 000 | 1 |
| 8 | 41 | 10 | 47 | 45 | 51 | 96 | X80982 000 | 1 |
| 8 | 31 | 10 | 57 | 35 | 61 | 96 | X80983 000 | 1 |
| 8 | 41 | 10 | 51 | 45 | 55 | 100 | X80020 000 | 1 |
| 8 | 27 | 10 | 67 | 31 | 71 | 102 | X80041 000 | 1 |
| 8 | 37 | 10 | 57 | 41 | 61 | 102 | X80042 000 | 1 |
| 8 | 47 | 10 | 47 | 51 | 51 | 102 | X80043 000 | 1 |
| 8 | 37 | 10 | 67 | 41 | 71 | 112 | X80142 000 | 1 |
| 8 | 47 | 10 | 57 | 51 | 61 | 112 | X80143 000 | 1 |
| 8 | 47 | 10 | 67 | 51 | 71 | 122 | X80243 000 | 1 |

con 5 chiavi with 5 keys

nichel opaco matt nickel

frizionato frictioned



Mezzo cilindro con camma regolabile in 8 posizioni
Half cylinder with adjustable cam in 8 positions



X8

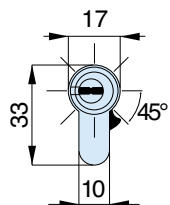
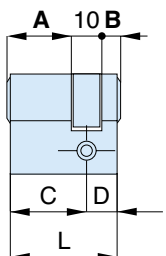

| ▽ | A | B | C | D | L | codice code | euro | |
|---|----|----|---|----|----|-------------|-------------------|---|
| 7 | 21 | 10 | 5 | 25 | 10 | 35 | X81360 000 | 1 |
| 8 | 27 | 10 | 5 | 31 | 10 | 41 | X81420 000 | 1 |
| 8 | 31 | 10 | 5 | 35 | 10 | 45 | X81460 000 | 1 |
| 8 | 37 | 10 | 5 | 41 | 10 | 51 | X81520 000 | 1 |
| 8 | 41 | 10 | 5 | 45 | 10 | 55 | X81560 000 | 1 |
| 8 | 47 | 10 | 5 | 51 | 10 | 61 | X81620 000 | 1 |
| 8 | 57 | 10 | 5 | 61 | 10 | 71 | X81720 000 | 1 |
| 8 | 67 | 10 | 5 | 71 | 10 | 81 | X81820 000 | 1 |

con 5 chiavi with 5 keys

nichel opaco matt nickel

CILINDRI DI SICUREZZA DA INFILARE
security mortice cylinders



Mezzo cilindro per lucchetto di sicurezza X92
 Half cylinder for security padlock X92

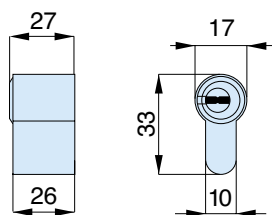

X8

| ↓ | A | B | C | D | L | codice code | euro | | |
|---|---|---|---|---|---|-------------------|------|--|---|
| | | | | | | X81270 000 | | | 1 |
| | | | | | | 050 | | | |
| | | | | | | N00 | | | |

con 5 chiavi with 5 keys

nichel opaco matt nickel

Doppio cilindro con pomolo ottone
 Double cylinder with brass knob

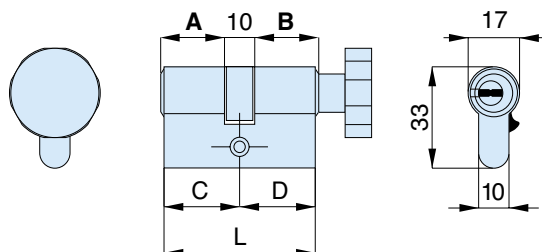

X8

| ↓ | A | B | C | D | L | codice code | euro | | |
|---|----|----|----|----|----|----------------|-------------------|--|---|
| 8 | 27 | 10 | 27 | 31 | 31 | 62 | X85640 00R | | 1 |
| 8 | 27 | 10 | 31 | 31 | 35 | 66 | X85681 00R | | 1 |
| 8 | 31 | 10 | 27 | 35 | 31 | 66 | X85682 00R | | 1 |
| 8 | 31 | 10 | 31 | 35 | 35 | 70 | X85720 00R | | 1 |
| 8 | 27 | 10 | 37 | 31 | 41 | 72 | X85741 00R | | 1 |
| 8 | 37 | 10 | 27 | 41 | 31 | 72 | X85742 00R | | 1 |
| 8 | 27 | 10 | 41 | 31 | 45 | 76 | X85781 00R | | 1 |
| 8 | 41 | 10 | 27 | 45 | 31 | 76 | X85782 00R | | 1 |
| 8 | 31 | 10 | 37 | 35 | 41 | 76 | X85783 00R | | 1 |
| 8 | 37 | 10 | 31 | 41 | 35 | 76 | X85784 00R | | 1 |
| 8 | 31 | 10 | 41 | 35 | 45 | 80 | X85821 00R | | 1 |
| 8 | 41 | 10 | 31 | 45 | 35 | 80 | X85822 00R | | 1 |
| 8 | 27 | 10 | 47 | 31 | 51 | 82 | X85841 00R | | 1 |
| 8 | 47 | 10 | 27 | 51 | 31 | 82 | X85842 00R | | 1 |
| 8 | 37 | 10 | 37 | 41 | 41 | 82 | X85843 00R | | 1 |
| 8 | 27 | 10 | 51 | 31 | 55 | 86 | X85881 00R | | 1 |
| 8 | 31 | 10 | 47 | 35 | 51 | 86 | X85882 00R | | 1 |
| 8 | 37 | 10 | 41 | 41 | 45 | 86 | X85883 00R | | 1 |
| 8 | 41 | 10 | 37 | 45 | 41 | 86 | X85884 00R | | 1 |
| 8 | 31 | 10 | 51 | 35 | 55 | 90 | X85921 00R | | 1 |
| 8 | 41 | 10 | 41 | 45 | 45 | 90 | X85922 00R | | 1 |
| 8 | 27 | 10 | 57 | 31 | 61 | 92 | X85941 00R | | 1 |
| 8 | 37 | 10 | 47 | 41 | 51 | 92 | X85942 00R | | 1 |
| 8 | 37 | 10 | 51 | 41 | 55 | 96 | X85981 00R | | 1 |
| 8 | 41 | 10 | 47 | 45 | 51 | 96 | X85982 00R | | 1 |
| 8 | 41 | 10 | 51 | 45 | 55 | 100 | X85020 00R | | 1 |
| 8 | 27 | 10 | 67 | 31 | 71 | 102 | X85041 00R | | 1 |
| 8 | 37 | 10 | 57 | 41 | 61 | 102 | X85042 00R | | 1 |
| 8 | 47 | 10 | 47 | 51 | 51 | 102 | X85043 00R | | 1 |
| 8 | 37 | 10 | 67 | 41 | 71 | 112 | X85142 00R | | 1 |
| 8 | 47 | 10 | 57 | 51 | 61 | 112 | X85143 00R | | 1 |
| 8 | 47 | 10 | 67 | 51 | 71 | 122 | X85243 00R | | 1 |
| 8 | 67 | 10 | 47 | 71 | 51 | 122 | X85245 00R | | 1 |
| | | | | | | 05R | | | |
| | | | | | | NOR | | | |

con 5 chiavi with 5 keys

nichel opaco matt nickel

Doppio cilindro con pomolo ottone
Double cylinder with brass knob



X8

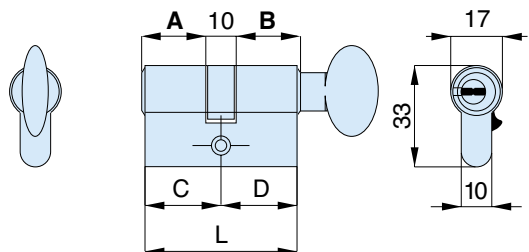

| ▽ | A | B | C | D | L | codice code | euro | | | |
|--------------------------|----|----|----|----|----|----------------|--------|-----|---|--|
| 8 | 27 | 10 | 27 | 31 | 31 | 62 | X85640 | 00F | 1 | |
| 8 | 27 | 10 | 31 | 31 | 35 | 66 | X85681 | 00F | 1 | |
| 8 | 31 | 10 | 27 | 35 | 31 | 66 | X85682 | 00F | 1 | |
| 8 | 31 | 10 | 31 | 35 | 35 | 70 | X85720 | 00F | 1 | |
| 8 | 27 | 10 | 37 | 31 | 41 | 72 | X85741 | 00F | 1 | |
| 8 | 37 | 10 | 27 | 41 | 31 | 72 | X85742 | 00F | 1 | |
| 8 | 27 | 10 | 41 | 31 | 45 | 76 | X85781 | 00F | 1 | |
| 8 | 41 | 10 | 27 | 45 | 31 | 76 | X85782 | 00F | 1 | |
| 8 | 31 | 10 | 37 | 35 | 41 | 76 | X85783 | 00F | 1 | |
| 8 | 37 | 10 | 31 | 41 | 35 | 76 | X85784 | 00F | 1 | |
| 8 | 31 | 10 | 41 | 35 | 45 | 80 | X85821 | 00F | 1 | |
| 8 | 41 | 10 | 31 | 45 | 35 | 80 | X85822 | 00F | 1 | |
| 8 | 27 | 10 | 47 | 31 | 51 | 82 | X85841 | 00F | 1 | |
| 8 | 47 | 10 | 27 | 51 | 31 | 82 | X85842 | 00F | 1 | |
| 8 | 37 | 10 | 37 | 41 | 41 | 82 | X85843 | 00F | 1 | |
| 8 | 27 | 10 | 51 | 31 | 55 | 86 | X85881 | 00F | 1 | |
| 8 | 31 | 10 | 47 | 35 | 51 | 86 | X85882 | 00F | 1 | |
| 8 | 37 | 10 | 41 | 41 | 45 | 86 | X85883 | 00F | 1 | |
| 8 | 41 | 10 | 37 | 45 | 41 | 86 | X85884 | 00F | 1 | |
| 8 | 31 | 10 | 51 | 35 | 55 | 90 | X85921 | 00F | 1 | |
| 8 | 41 | 10 | 41 | 45 | 45 | 90 | X85922 | 00F | 1 | |
| 8 | 27 | 10 | 57 | 31 | 61 | 92 | X85941 | 00F | 1 | |
| 8 | 37 | 10 | 47 | 41 | 51 | 92 | X85942 | 00F | 1 | |
| 8 | 37 | 10 | 51 | 41 | 55 | 96 | X85981 | 00F | 1 | |
| 8 | 41 | 10 | 47 | 45 | 51 | 96 | X85982 | 00F | 1 | |
| 8 | 41 | 10 | 51 | 45 | 55 | 100 | X85020 | 00F | 1 | |
| 8 | 27 | 10 | 67 | 31 | 71 | 102 | X85041 | 00F | 1 | |
| 8 | 37 | 10 | 57 | 41 | 61 | 102 | X85042 | 00F | 1 | |
| 8 | 47 | 10 | 47 | 51 | 51 | 102 | X85043 | 00F | 1 | |
| 8 | 37 | 10 | 67 | 41 | 71 | 112 | X85142 | 00F | 1 | |
| 8 | 47 | 10 | 57 | 51 | 61 | 112 | X85143 | 00F | 1 | |
| 8 | 47 | 10 | 67 | 51 | 71 | 122 | X85243 | 00F | 1 | |
| 8 | 67 | 10 | 47 | 71 | 51 | 122 | X85245 | 00F | 1 | |
| con 5 chiavi with 5 keys | | | | | | | | 05F | | |
| nichel opaco matt nickel | | | | | | | | NOF | | |

CILINDRI DI SICUREZZA DA INFILARE
security mortice cylinders





Doppio cilindro predisposto pomolo
Double cylinder with knob provision



X8

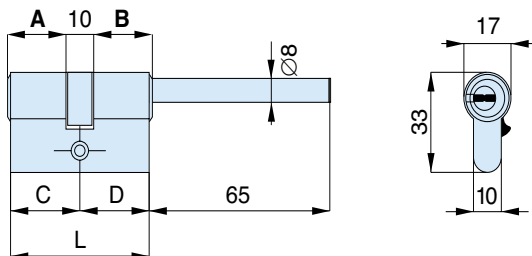

Doppio cilindro predisposto pomolo
Double cylinder with knob provision



X8

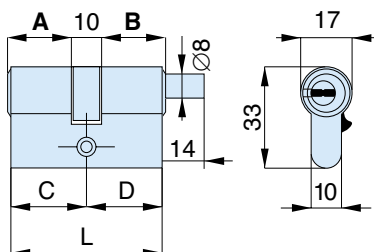

| 8 | A | B | C | D | L | codice code | euro | | |
|---|----|----|----|----|----|-------------|------------|--|---|
| 8 | 27 | 10 | 27 | 31 | 31 | 62 | X85640 00L | | 1 |
| 8 | 31 | 10 | 27 | 35 | 31 | 66 | X85680 00L | | 1 |
| 8 | 37 | 10 | 27 | 41 | 31 | 72 | X85740 00L | | 1 |
| 8 | 41 | 10 | 27 | 45 | 31 | 76 | X85780 00L | | 1 |
| 8 | 47 | 10 | 27 | 51 | 31 | 82 | X85840 00L | | 1 |
| 8 | 51 | 10 | 27 | 55 | 31 | 86 | X85880 00L | | 1 |
| 8 | 57 | 10 | 27 | 61 | 31 | 92 | X85940 00L | | 1 |
| 8 | 67 | 10 | 27 | 71 | 31 | 102 | X85040 00L | | 1 |

con 5 chiavi with 5 keys

..... 05L

nichel opaco matt nickel

..... NOL

| 8 | A | B | C | D | L | codice code | euro | | |
|---|----|----|----|----|----|-------------|------------|--|---|
| 8 | 27 | 10 | 27 | 31 | 31 | 62 | X85640 00C | | 1 |
| 8 | 27 | 10 | 31 | 31 | 35 | 66 | X85681 00C | | 1 |
| 8 | 31 | 10 | 27 | 35 | 31 | 66 | X85682 00C | | 1 |
| 8 | 31 | 10 | 31 | 35 | 35 | 70 | X85720 00C | | 1 |
| 8 | 27 | 10 | 37 | 31 | 41 | 72 | X85741 00C | | 1 |
| 8 | 37 | 10 | 27 | 41 | 31 | 72 | X85742 00C | | 1 |
| 8 | 27 | 10 | 41 | 31 | 45 | 76 | X85781 00C | | 1 |
| 8 | 41 | 10 | 27 | 45 | 31 | 76 | X85782 00C | | 1 |
| 8 | 31 | 10 | 37 | 35 | 41 | 76 | X85783 00C | | 1 |
| 8 | 37 | 10 | 31 | 41 | 35 | 76 | X85784 00C | | 1 |
| 8 | 31 | 10 | 41 | 35 | 45 | 80 | X85821 00C | | 1 |
| 8 | 41 | 10 | 31 | 45 | 35 | 80 | X85822 00C | | 1 |
| 8 | 27 | 10 | 47 | 31 | 51 | 82 | X85841 00C | | 1 |
| 8 | 47 | 10 | 27 | 51 | 31 | 82 | X85842 00C | | 1 |
| 8 | 37 | 10 | 37 | 41 | 41 | 82 | X85843 00C | | 1 |
| 8 | 27 | 10 | 51 | 31 | 55 | 86 | X85881 00C | | 1 |
| 8 | 31 | 10 | 47 | 35 | 51 | 86 | X85882 00C | | 1 |
| 8 | 37 | 10 | 41 | 41 | 45 | 86 | X85883 00C | | 1 |
| 8 | 41 | 10 | 37 | 45 | 41 | 86 | X85884 00C | | 1 |
| 8 | 31 | 10 | 51 | 35 | 55 | 90 | X85921 00C | | 1 |
| 8 | 41 | 10 | 41 | 45 | 45 | 90 | X85922 00C | | 1 |
| 8 | 27 | 10 | 57 | 31 | 61 | 92 | X85941 00C | | 1 |
| 8 | 37 | 10 | 47 | 41 | 51 | 92 | X85942 00C | | 1 |
| 8 | 37 | 10 | 51 | 41 | 55 | 96 | X85981 00C | | 1 |
| 8 | 41 | 10 | 47 | 45 | 51 | 96 | X85982 00C | | 1 |
| 8 | 41 | 10 | 51 | 45 | 55 | 100 | X85020 00C | | 1 |
| 8 | 27 | 10 | 67 | 31 | 71 | 102 | X85041 00C | | 1 |
| 8 | 37 | 10 | 57 | 41 | 61 | 102 | X85042 00C | | 1 |
| 8 | 47 | 10 | 47 | 51 | 51 | 102 | X85043 00C | | 1 |
| 8 | 37 | 10 | 67 | 41 | 71 | 112 | X85142 00C | | 1 |
| 8 | 47 | 10 | 57 | 51 | 61 | 112 | X85143 00C | | 1 |

con 5 chiavi with 5 keys

..... 05C

nichel opaco matt nickel

..... NOC

■ **CILINDRI DA APPLICARE**
RIM CYLINDERS



P. 39

■ **CILINDRI DA INFILARE**
MORTICE CYLINDERS



P. 40

■ **CILINDRI DA INFILARE CON RINFORZO E
TAGLIO ANTITORSIONE BREVETTATO**
MORTICE CYLINDERS WITH PATENTED
REINFORCE AND CUT AGAINST BREAKING



P. 44

■ **CILINDRI OVALI (SOLO 5 PERNI)**
OVAL CYLINDERS (ONLY 5 PINS)



P. 48

■ **CILINDRI Ø 26 (15 PERNI)**
Ø 26 CYLINDERS (15 PINS)



P. 48

■ **CILINDRI Ø 22 (SOLO 5 PERNI)**
Ø 22 CYLINDERS (ONLY 5 PINS)



P. 48

- ✓ **Sistema a 15 perni attivi**
System with 15 active pins
- ✓ **Corpo in ottone nichelato**
Nickel plated brass body
- ✓ **Perni in acciaio temprato**
Hardened steel pins
- ✓ **Controperni in acciaio inox**
Stainless steel top pins
- ✓ **Molle in acciaio inox**
Stainless steel springs
- ✓ **Camma DIN 30° (cilindri da infilare)**
DIN 30° cam (mortice cylinders)
- ✓ **3 chiavi reversibili in alpacca con impugnatura rivestita in plastica, collo lungo e numerazione a codice indiretto sulla testa**
3 reversible keys in nickel silver with plastic-coated grip, long neck numbered on key head
- ✓ **Code card**
Code card
- ✓ **Vite di fissaggio**
Fixing screw

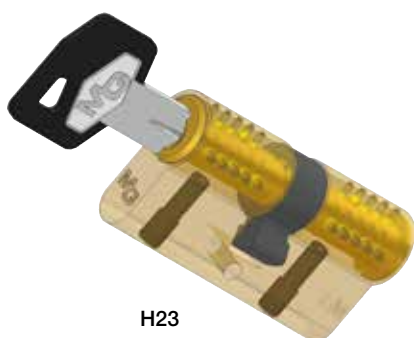

H23

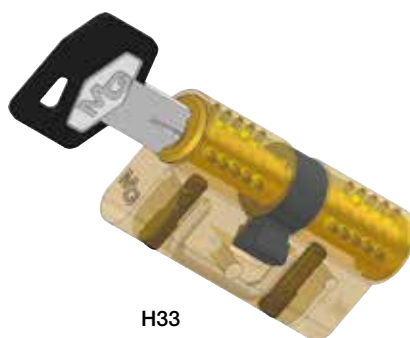

H33

Cilindro per art. 711
Cylinder for art. 711

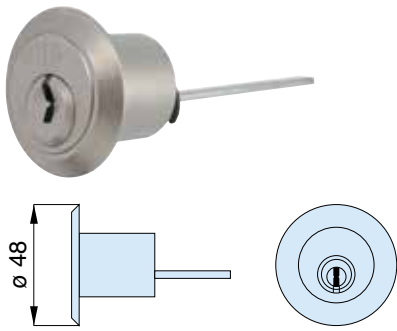

HS

| ↓ | A | B | C | D | L | codice code | euro | |
|----|--------------------------|---|---|---|---|-------------------|------|---|
| 15 | | | | | | H11000 N00 | | 1 |
| | con 5 chiavi with 5 keys | | | | | | N50 | |

Cilindro per art. 712
Cylinder for art. 712

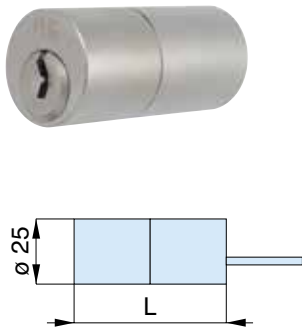

HS

| ↓ | A | B | C | D | L | codice code | euro | |
|----|--------------------------|---|---|---|----|-------------------|------|---|
| 15 | | | | | 50 | H12500 N00 | | 1 |
| | con 5 chiavi with 5 keys | | | | | | N50 | |

Coppia cilindri
Double rim cylinders

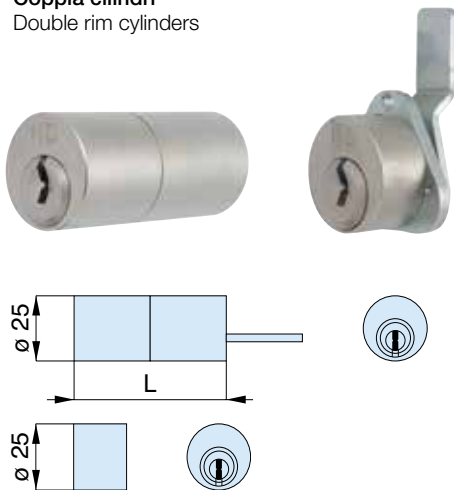

HS

| ↓ | A | B | C | D | L | codice code | euro | |
|----|--------------------------|---|---|---|----|-------------------|------|---|
| 15 | | | | | 50 | H14500 N00 | | 1 |
| | con 5 chiavi with 5 keys | | | | | | N50 | |

Coppia cilindri
Double rim cylinders

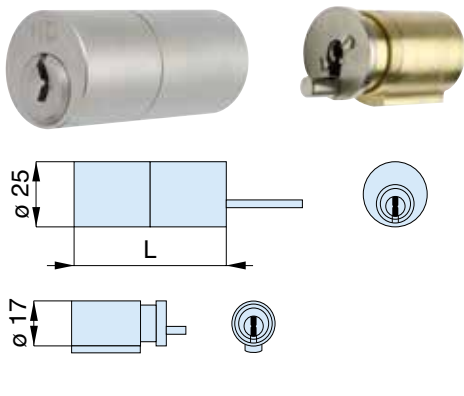

HS

| ↓ | A | B | C | D | L | codice code | euro | |
|----|--------------------------|---|---|---|----|-------------------|------|---|
| 15 | | | | | 50 | H14501 N00 | | 1 |
| | con 5 chiavi with 5 keys | | | | | | N50 | |



CILINDRI DI SICUREZZA DA APPLICARE
security rim cylinders



Doppio cilindro
Double cylinder



HS

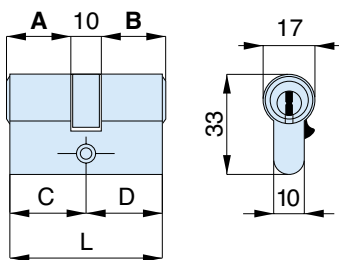

| ↓ | A | B | C | D | L | codice code | euro | ✎ | 📦 |
|----|----|----|----|----|----|----------------|------------|---|---|
| 15 | 27 | 10 | 27 | 31 | 31 | 62 | H23640 N00 | | 1 |
| 15 | 27 | 10 | 31 | 31 | 35 | 66 | H23680 N00 | | 1 |
| 15 | 31 | 10 | 31 | 35 | 35 | 70 | H23720 N00 | | 1 |
| 15 | 27 | 10 | 37 | 31 | 41 | 72 | H23740 N00 | | 1 |
| 15 | 27 | 10 | 41 | 31 | 45 | 76 | H23781 N00 | | 1 |
| 15 | 31 | 10 | 37 | 35 | 41 | 76 | H23782 N00 | | 1 |
| 15 | 31 | 10 | 41 | 35 | 45 | 80 | H23820 N00 | | 1 |
| 15 | 27 | 10 | 47 | 31 | 51 | 82 | H23841 N00 | | 1 |
| 15 | 37 | 10 | 37 | 41 | 41 | 82 | H23842 N00 | | 1 |
| 15 | 27 | 10 | 51 | 31 | 55 | 86 | H23881 N00 | | 1 |
| 15 | 31 | 10 | 47 | 35 | 51 | 86 | H23882 N00 | | 1 |
| 15 | 37 | 10 | 41 | 41 | 45 | 86 | H23883 N00 | | 1 |
| 15 | 31 | 10 | 51 | 35 | 55 | 90 | H23921 N00 | | 1 |
| 15 | 41 | 10 | 41 | 45 | 45 | 90 | H23922 N00 | | 1 |
| 15 | 27 | 10 | 57 | 31 | 61 | 92 | H23941 N00 | | 1 |
| 15 | 37 | 10 | 47 | 41 | 51 | 92 | H23942 N00 | | 1 |
| 15 | 37 | 10 | 51 | 41 | 55 | 96 | H23981 N00 | | 1 |
| 15 | 41 | 10 | 47 | 45 | 51 | 96 | H23982 N00 | | 1 |
| 15 | 31 | 10 | 57 | 35 | 61 | 96 | H23983 N00 | | 1 |
| 15 | 41 | 10 | 51 | 45 | 55 | 100 | H23020 N00 | | 1 |
| 15 | 27 | 10 | 67 | 31 | 71 | 102 | H23041 N00 | | 1 |
| 15 | 37 | 10 | 57 | 41 | 61 | 102 | H23042 N00 | | 1 |
| 15 | 47 | 10 | 47 | 51 | 51 | 102 | H23043 N00 | | 1 |
| 15 | 27 | 10 | 77 | 31 | 81 | 112 | H23141 N00 | | 1 |
| 15 | 37 | 10 | 67 | 41 | 71 | 112 | H23142 N00 | | 1 |
| 15 | 47 | 10 | 57 | 51 | 61 | 112 | H23143 N00 | | 1 |
| 15 | 47 | 10 | 67 | 51 | 71 | 122 | H23243 N00 | | 1 |

con 5 chiavi with 5 keys

..... N50

frizionato frictioned

..... NOX

Mezzo cilindro con camma regolabile in 8 posizioni
Half cylinder with adjustable cam in 8 positions



HS

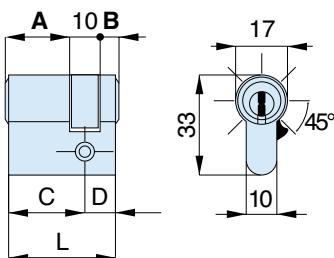

| ↓ | A | B | C | D | L | codice code | euro | ✎ | 📦 |
|----|----|----|---|----|----|----------------|------------|---|---|
| 15 | 27 | 10 | 5 | 31 | 10 | 41 | H24420 N00 | | 1 |
| 15 | 31 | 10 | 5 | 35 | 10 | 45 | H24460 N00 | | 1 |
| 15 | 37 | 10 | 5 | 41 | 10 | 51 | H24520 N00 | | 1 |
| 15 | 41 | 10 | 5 | 45 | 10 | 55 | H24560 N00 | | 1 |
| 15 | 47 | 10 | 5 | 51 | 10 | 61 | H24620 N00 | | 1 |
| 15 | 57 | 10 | 5 | 61 | 10 | 71 | H24720 N00 | | 1 |
| 15 | 67 | 10 | 5 | 71 | 10 | 81 | H24820 N00 | | 1 |
| 15 | 77 | 10 | 5 | 81 | 10 | 91 | H24920 N00 | | 1 |

con 5 chiavi with 5 keys

..... N50

Mezzo cilindro per lucchetto di sicurezza H92 - nickel opaco
 Half cylinder for security padlock H92 - matt nickel



HS

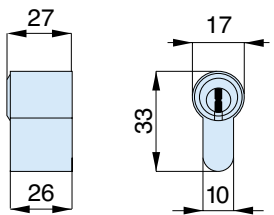

| | A | B | C | D | L | codice code | euro | |
|----|--------------------------|---|---|---|---|-------------------|-----------|---|
| 15 | | | | | | H24270 N00 | | 1 |
| | con 5 chiavi with 5 keys | | | | | | N50 | |

Doppio cilindro con pomolo ottone nichelato opaco
 Double cylinder with matt nickel-plated brass knob



HS

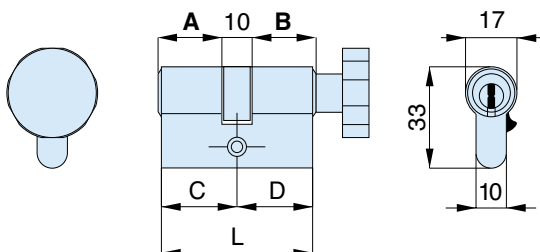

| | A | B | C | D | L | codice code | euro | |
|----|--------------------------|----|----|----|----|----------------|-------------------|---|
| 15 | 27 | 10 | 27 | 31 | 31 | 62 | H29640 NOR | 1 |
| 15 | 27 | 10 | 31 | 31 | 35 | 66 | H29681 NOR | 1 |
| 15 | 31 | 10 | 27 | 35 | 31 | 66 | H29682 NOR | 1 |
| 15 | 31 | 10 | 31 | 35 | 35 | 70 | H29720 NOR | 1 |
| 15 | 27 | 10 | 37 | 31 | 41 | 72 | H29741 NOR | 1 |
| 15 | 37 | 10 | 27 | 41 | 31 | 72 | H29742 NOR | 1 |
| 15 | 27 | 10 | 41 | 31 | 45 | 76 | H29781 NOR | 1 |
| 15 | 41 | 10 | 27 | 45 | 31 | 76 | H29782 NOR | 1 |
| 15 | 31 | 10 | 37 | 35 | 41 | 76 | H29783 NOR | 1 |
| 15 | 37 | 10 | 31 | 41 | 35 | 76 | H29784 NOR | 1 |
| 15 | 31 | 10 | 41 | 35 | 45 | 80 | H29821 NOR | 1 |
| 15 | 41 | 10 | 31 | 45 | 35 | 80 | H29822 NOR | 1 |
| 15 | 27 | 10 | 47 | 31 | 51 | 82 | H29841 NOR | 1 |
| 15 | 47 | 10 | 27 | 51 | 31 | 82 | H29842 NOR | 1 |
| 15 | 37 | 10 | 37 | 41 | 41 | 82 | H29843 NOR | 1 |
| 15 | 27 | 10 | 51 | 31 | 55 | 86 | H29881 NOR | 1 |
| 15 | 31 | 10 | 47 | 35 | 51 | 86 | H29882 NOR | 1 |
| 15 | 37 | 10 | 41 | 41 | 45 | 86 | H29883 NOR | 1 |
| 15 | 41 | 10 | 37 | 45 | 41 | 86 | H29884 NOR | 1 |
| 15 | 31 | 10 | 51 | 35 | 55 | 90 | H29921 NOR | 1 |
| 15 | 41 | 10 | 41 | 45 | 45 | 90 | H29922 NOR | 1 |
| 15 | 27 | 10 | 57 | 31 | 61 | 92 | H29941 NOR | 1 |
| 15 | 37 | 10 | 47 | 41 | 51 | 92 | H29942 NOR | 1 |
| 15 | 37 | 10 | 51 | 41 | 55 | 96 | H29981 NOR | 1 |
| 15 | 41 | 10 | 47 | 45 | 51 | 96 | H29982 NOR | 1 |
| 15 | 41 | 10 | 51 | 45 | 55 | 100 | H29020 NOR | 1 |
| 15 | 27 | 10 | 67 | 31 | 71 | 102 | H29041 NOR | 1 |
| 15 | 37 | 10 | 57 | 41 | 61 | 102 | H29042 NOR | 1 |
| 15 | 47 | 10 | 47 | 51 | 51 | 102 | H29043 NOR | 1 |
| 15 | 27 | 10 | 77 | 31 | 81 | 112 | H29141 NOR | 1 |
| 15 | 37 | 10 | 67 | 41 | 71 | 112 | H29142 NOR | 1 |
| 15 | 47 | 10 | 57 | 51 | 61 | 112 | H29143 NOR | 1 |
| | con 5 chiavi with 5 keys | | | | | | N5R | |

CILINDRI DI SICUREZZA DA INFILARE
 security mortice cylinders



Doppio cilindro con pomolo ottone nichelato opaco
 Double cylinder with matt nickel-plated brass knob



HS

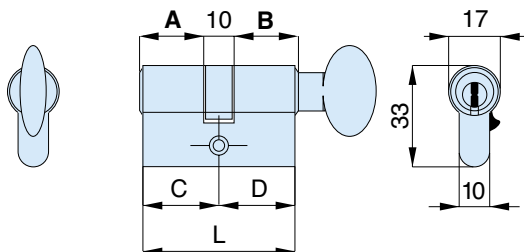

CILINDRI DI SICUREZZA DA INFILARE
 security mortice cylinders

| | A | B | C | D | L | codice code | euro | | |
|----|----|----|----|----|----|----------------|--------|-----|---|
| 15 | 27 | 10 | 27 | 31 | 31 | 62 | H29640 | N0F | 1 |
| 15 | 27 | 10 | 31 | 31 | 35 | 66 | H29681 | N0F | 1 |
| 15 | 31 | 10 | 27 | 35 | 31 | 66 | H29682 | N0F | 1 |
| 15 | 31 | 10 | 31 | 35 | 35 | 70 | H29720 | N0F | 1 |
| 15 | 27 | 10 | 37 | 31 | 41 | 72 | H29741 | N0F | 1 |
| 15 | 37 | 10 | 27 | 41 | 31 | 72 | H29742 | N0F | 1 |
| 15 | 27 | 10 | 41 | 31 | 45 | 76 | H29781 | N0F | 1 |
| 15 | 41 | 10 | 27 | 45 | 31 | 76 | H29782 | N0F | 1 |
| 15 | 31 | 10 | 37 | 35 | 41 | 76 | H29783 | N0F | 1 |
| 15 | 37 | 10 | 31 | 41 | 35 | 76 | H29784 | N0F | 1 |
| 15 | 31 | 10 | 41 | 35 | 45 | 80 | H29821 | N0F | 1 |
| 15 | 41 | 10 | 31 | 45 | 35 | 80 | H29822 | N0F | 1 |
| 15 | 27 | 10 | 47 | 31 | 51 | 82 | H29841 | N0F | 1 |
| 15 | 47 | 10 | 27 | 51 | 31 | 82 | H29842 | N0F | 1 |
| 15 | 37 | 10 | 37 | 41 | 41 | 82 | H29843 | N0F | 1 |
| 15 | 27 | 10 | 51 | 31 | 55 | 86 | H29881 | N0F | 1 |
| 15 | 31 | 10 | 47 | 35 | 51 | 86 | H29882 | N0F | 1 |
| 15 | 37 | 10 | 41 | 41 | 45 | 86 | H29883 | N0F | 1 |
| 15 | 41 | 10 | 37 | 45 | 41 | 86 | H29884 | N0F | 1 |
| 15 | 31 | 10 | 51 | 35 | 55 | 90 | H29921 | N0F | 1 |
| 15 | 41 | 10 | 41 | 45 | 45 | 90 | H29922 | N0F | 1 |
| 15 | 27 | 10 | 57 | 31 | 61 | 92 | H29941 | N0F | 1 |
| 15 | 37 | 10 | 47 | 41 | 51 | 92 | H29942 | N0F | 1 |
| 15 | 37 | 10 | 51 | 41 | 55 | 96 | H29981 | N0F | 1 |
| 15 | 41 | 10 | 47 | 45 | 51 | 96 | H29982 | N0F | 1 |
| 15 | 41 | 10 | 51 | 45 | 55 | 100 | H29020 | N0F | 1 |
| 15 | 27 | 10 | 67 | 31 | 71 | 102 | H29041 | N0F | 1 |
| 15 | 37 | 10 | 57 | 41 | 61 | 102 | H29042 | N0F | 1 |
| 15 | 47 | 10 | 47 | 51 | 51 | 102 | H29043 | N0F | 1 |
| 15 | 27 | 10 | 77 | 31 | 81 | 112 | H29141 | N0F | 1 |
| 15 | 37 | 10 | 67 | 41 | 71 | 112 | H29142 | N0F | 1 |
| 15 | 47 | 10 | 57 | 51 | 61 | 112 | H29143 | N0F | 1 |

con 5 chiavi with 5 keys

..... N5F

Doppio cilindro predisposto pomolo
Double cylinder with knob provision



HS

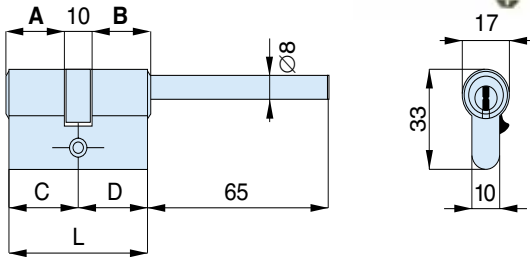

| ▽ | A | B | C | D | L | codice code | euro | |
|----|----|----|----|----|----|-------------|------------|---|
| 15 | 27 | 10 | 27 | 31 | 31 | 62 | H29640 NOL | 1 |
| 15 | 31 | 10 | 27 | 35 | 31 | 66 | H29680 NOL | 1 |
| 15 | 37 | 10 | 27 | 41 | 31 | 72 | H29740 NOL | 1 |
| 15 | 41 | 10 | 27 | 45 | 31 | 76 | H29780 NOL | 1 |
| 15 | 47 | 10 | 27 | 51 | 31 | 82 | H29840 NOL | 1 |
| 15 | 51 | 10 | 27 | 55 | 31 | 86 | H29880 NOL | 1 |
| 15 | 57 | 10 | 27 | 61 | 31 | 92 | H29940 NOL | 1 |
| 15 | 67 | 10 | 27 | 71 | 31 | 102 | H29040 NOL | 1 |
| 15 | 77 | 10 | 27 | 81 | 31 | 112 | H29140 NOL | 1 |

con 5 chiavi with 5 keys

..... N5L

Doppio cilindro predisposto pomolo
Double cylinder with knob provision



HS

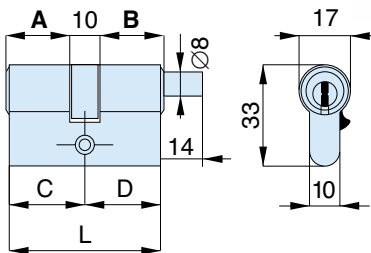

| ▽ | A | B | C | D | L | codice code | euro | |
|----|----|----|----|----|----|-------------|------------|---|
| 15 | 27 | 10 | 27 | 31 | 31 | 62 | H29640 NOC | 1 |
| 15 | 27 | 10 | 31 | 31 | 35 | 66 | H29681 NOC | 1 |
| 15 | 31 | 10 | 27 | 35 | 31 | 66 | H29682 NOC | 1 |
| 15 | 31 | 10 | 31 | 35 | 35 | 70 | H29720 NOC | 1 |
| 15 | 27 | 10 | 37 | 31 | 41 | 72 | H29741 NOC | 1 |
| 15 | 37 | 10 | 27 | 41 | 31 | 72 | H29742 NOC | 1 |
| 15 | 27 | 10 | 41 | 31 | 45 | 76 | H29781 NOC | 1 |
| 15 | 41 | 10 | 27 | 45 | 31 | 76 | H29782 NOC | 1 |
| 15 | 31 | 10 | 37 | 35 | 41 | 76 | H29783 NOC | 1 |
| 15 | 37 | 10 | 31 | 41 | 35 | 76 | H29784 NOC | 1 |
| 15 | 31 | 10 | 41 | 35 | 45 | 80 | H29821 NOC | 1 |
| 15 | 41 | 10 | 31 | 45 | 35 | 80 | H29822 NOC | 1 |
| 15 | 27 | 10 | 47 | 31 | 51 | 82 | H29841 NOC | 1 |
| 15 | 47 | 10 | 27 | 51 | 31 | 82 | H29842 NOC | 1 |
| 15 | 37 | 10 | 37 | 41 | 41 | 82 | H29843 NOC | 1 |
| 15 | 27 | 10 | 51 | 31 | 55 | 86 | H29881 NOC | 1 |
| 15 | 31 | 10 | 47 | 35 | 51 | 86 | H29882 NOC | 1 |
| 15 | 37 | 10 | 41 | 41 | 45 | 86 | H29883 NOC | 1 |
| 15 | 41 | 10 | 37 | 45 | 41 | 86 | H29884 NOC | 1 |
| 15 | 31 | 10 | 51 | 35 | 55 | 90 | H29921 NOC | 1 |
| 15 | 41 | 10 | 41 | 45 | 45 | 90 | H29922 NOC | 1 |
| 15 | 27 | 10 | 57 | 31 | 61 | 92 | H29941 NOC | 1 |
| 15 | 37 | 10 | 47 | 41 | 51 | 92 | H29942 NOC | 1 |
| 15 | 37 | 10 | 51 | 41 | 55 | 96 | H29981 NOC | 1 |
| 15 | 41 | 10 | 47 | 45 | 51 | 96 | H29982 NOC | 1 |
| 15 | 41 | 10 | 51 | 45 | 55 | 100 | H29020 NOC | 1 |
| 15 | 27 | 10 | 67 | 31 | 71 | 102 | H29041 NOC | 1 |
| 15 | 37 | 10 | 57 | 41 | 61 | 102 | H29042 NOC | 1 |
| 15 | 47 | 10 | 47 | 51 | 51 | 102 | H29043 NOC | 1 |
| 15 | 27 | 10 | 77 | 31 | 81 | 112 | H29141 NOC | 1 |
| 15 | 37 | 10 | 67 | 41 | 71 | 112 | H29142 NOC | 1 |
| 15 | 47 | 10 | 57 | 51 | 61 | 112 | H29143 NOC | 1 |

con 5 chiavi with 5 keys

..... N5C



Doppio cilindro con rinforzo e taglio
Double cylinder with reinforce and cut



HS

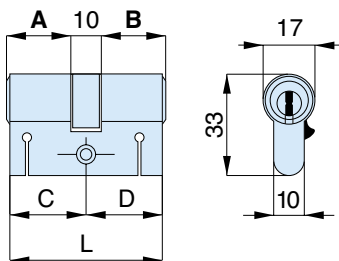

| ↓ | A | B | C | D | L | codice code | euro | ✎ | 📦 |
|----|----|----|----|----|----|----------------|------------|---|---|
| 15 | 27 | 10 | 27 | 31 | 31 | 62 | H33640 N00 | | 1 |
| 15 | 27 | 10 | 31 | 31 | 35 | 66 | H33680 N00 | | 1 |
| 15 | 31 | 10 | 31 | 35 | 35 | 70 | H33720 N00 | | 1 |
| 15 | 27 | 10 | 37 | 31 | 41 | 72 | H33740 N00 | | 1 |
| 15 | 27 | 10 | 41 | 31 | 45 | 76 | H33781 N00 | | 1 |
| 15 | 31 | 10 | 37 | 35 | 41 | 76 | H33782 N00 | | 1 |
| 15 | 31 | 10 | 41 | 35 | 45 | 80 | H33820 N00 | | 1 |
| 15 | 27 | 10 | 47 | 31 | 51 | 82 | H33841 N00 | | 1 |
| 15 | 37 | 10 | 37 | 41 | 41 | 82 | H33842 N00 | | 1 |
| 15 | 27 | 10 | 51 | 31 | 55 | 86 | H33881 N00 | | 1 |
| 15 | 31 | 10 | 47 | 35 | 51 | 86 | H33882 N00 | | 1 |
| 15 | 37 | 10 | 41 | 41 | 45 | 86 | H33883 N00 | | 1 |
| 15 | 31 | 10 | 51 | 35 | 55 | 90 | H33921 N00 | | 1 |
| 15 | 41 | 10 | 41 | 45 | 45 | 90 | H33922 N00 | | 1 |
| 15 | 27 | 10 | 57 | 31 | 61 | 92 | H33941 N00 | | 1 |
| 15 | 37 | 10 | 47 | 41 | 51 | 92 | H33942 N00 | | 1 |
| 15 | 37 | 10 | 51 | 41 | 55 | 96 | H33981 N00 | | 1 |
| 15 | 41 | 10 | 47 | 45 | 51 | 96 | H33982 N00 | | 1 |
| 15 | 31 | 10 | 57 | 35 | 61 | 96 | H33983 N00 | | 1 |
| 15 | 41 | 10 | 51 | 45 | 55 | 100 | H33020 N00 | | 1 |
| 15 | 27 | 10 | 67 | 31 | 71 | 102 | H33041 N00 | | 1 |
| 15 | 37 | 10 | 57 | 41 | 61 | 102 | H33042 N00 | | 1 |
| 15 | 47 | 10 | 47 | 51 | 51 | 102 | H33043 N00 | | 1 |
| 15 | 27 | 10 | 77 | 31 | 81 | 112 | H33141 N00 | | 1 |
| 15 | 37 | 10 | 67 | 41 | 71 | 112 | H33142 N00 | | 1 |
| 15 | 47 | 10 | 57 | 51 | 61 | 112 | H33143 N00 | | 1 |
| 15 | 47 | 10 | 67 | 51 | 71 | 122 | H33243 N00 | | 1 |

con 5 chiavi with 5 keys

..... N50

frizionato frictioned

..... NOX

Mezzo cilindro con taglio e camma regolabile in 8 posizioni
Half cylinder with cut and adjustable cam in 8 position



HS

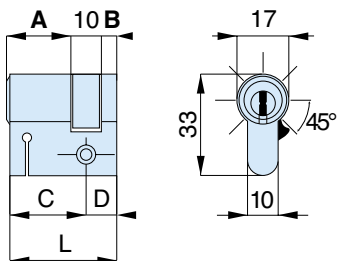

| ↓ | A | B | C | D | L | codice code | euro | ✎ | 📦 |
|----|----|----|---|----|----|----------------|------------|---|---|
| 15 | 27 | 10 | 5 | 31 | 10 | 41 | H34420 N00 | | 1 |
| 15 | 31 | 10 | 5 | 35 | 10 | 45 | H34460 N00 | | 1 |
| 15 | 37 | 10 | 5 | 41 | 10 | 51 | H34520 N00 | | 1 |
| 15 | 41 | 10 | 5 | 45 | 10 | 55 | H34560 N00 | | 1 |
| 15 | 47 | 10 | 5 | 51 | 10 | 61 | H34620 N00 | | 1 |
| 15 | 57 | 10 | 5 | 61 | 10 | 71 | H34720 N00 | | 1 |
| 15 | 67 | 10 | 5 | 71 | 10 | 81 | H34820 N00 | | 1 |
| 15 | 77 | 10 | 5 | 81 | 10 | 91 | H34920 N00 | | 1 |

con 5 chiavi with 5 keys

..... N50

Doppio cilindro con pomolo ottone nichelato opaco con rinforzo e taglio
 Double cylinder with matt nickel-plated brass knob with reinforce and cut

HS

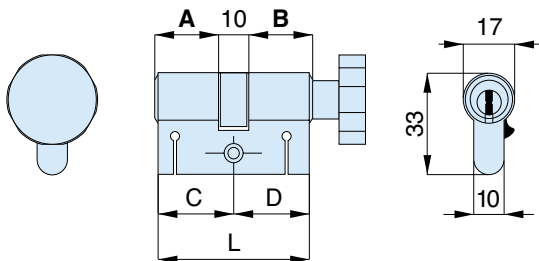

| ▽ | A | B | C | D | L | codice code | euro | |
|----|----|----|----|----|----|----------------|------------|---|
| 15 | 27 | 10 | 27 | 31 | 31 | 62 | H39640 NOR | 1 |
| 15 | 27 | 10 | 31 | 31 | 35 | 66 | H39681 NOR | 1 |
| 15 | 31 | 10 | 27 | 35 | 31 | 66 | H39682 NOR | 1 |
| 15 | 31 | 10 | 31 | 35 | 35 | 70 | H39720 NOR | 1 |
| 15 | 27 | 10 | 37 | 31 | 41 | 72 | H39741 NOR | 1 |
| 15 | 37 | 10 | 27 | 41 | 31 | 72 | H39742 NOR | 1 |
| 15 | 27 | 10 | 41 | 31 | 45 | 76 | H39781 NOR | 1 |
| 15 | 41 | 10 | 27 | 45 | 31 | 76 | H39782 NOR | 1 |
| 15 | 31 | 10 | 37 | 35 | 41 | 76 | H39783 NOR | 1 |
| 15 | 37 | 10 | 31 | 41 | 35 | 76 | H39784 NOR | 1 |
| 15 | 31 | 10 | 41 | 35 | 45 | 80 | H39821 NOR | 1 |
| 15 | 41 | 10 | 31 | 45 | 35 | 80 | H39822 NOR | 1 |
| 15 | 27 | 10 | 47 | 31 | 51 | 82 | H39841 NOR | 1 |
| 15 | 47 | 10 | 27 | 51 | 31 | 82 | H39842 NOR | 1 |
| 15 | 37 | 10 | 37 | 41 | 41 | 82 | H39843 NOR | 1 |
| 15 | 27 | 10 | 51 | 31 | 55 | 86 | H39881 NOR | 1 |
| 15 | 31 | 10 | 47 | 35 | 51 | 86 | H39882 NOR | 1 |
| 15 | 37 | 10 | 41 | 41 | 45 | 86 | H39883 NOR | 1 |
| 15 | 41 | 10 | 37 | 45 | 41 | 86 | H39884 NOR | 1 |
| 15 | 31 | 10 | 51 | 35 | 55 | 90 | H39921 NOR | 1 |
| 15 | 41 | 10 | 41 | 45 | 45 | 90 | H39922 NOR | 1 |
| 15 | 27 | 10 | 57 | 31 | 61 | 92 | H39941 NOR | 1 |
| 15 | 37 | 10 | 47 | 41 | 51 | 92 | H39942 NOR | 1 |
| 15 | 37 | 10 | 51 | 41 | 55 | 96 | H39981 NOR | 1 |
| 15 | 41 | 10 | 47 | 45 | 51 | 96 | H39982 NOR | 1 |
| 15 | 41 | 10 | 51 | 45 | 55 | 100 | H39020 NOR | 1 |
| 15 | 27 | 10 | 67 | 31 | 71 | 102 | H39041 NOR | 1 |
| 15 | 37 | 10 | 57 | 41 | 61 | 102 | H39042 NOR | 1 |
| 15 | 47 | 10 | 47 | 51 | 51 | 102 | H39043 NOR | 1 |
| 15 | 27 | 10 | 77 | 31 | 81 | 112 | H39141 NOR | 1 |
| 15 | 37 | 10 | 67 | 41 | 71 | 112 | H39142 NOR | 1 |
| 15 | 47 | 10 | 57 | 51 | 61 | 112 | H39143 NOR | 1 |

con 5 chiavi with 5 keys

..... N5R

CILINDRI DI SICUREZZA DA INFILARE
 security mortice cylinders





Doppio cilindro con pomolo ottone nichelato opaco con rinforzo e taglio
Double cylinder with matt nickel-plated brass knob with reinforce and cut



HS

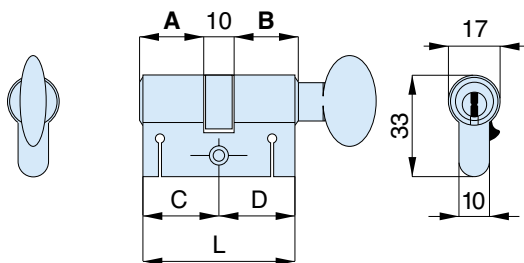

| | A | B | C | D | L | codice code | euro | | |
|----|----|----|----|----|----|----------------|--------|-----|---|
| 15 | 27 | 10 | 27 | 31 | 31 | 62 | H39640 | N0F | 1 |
| 15 | 27 | 10 | 31 | 31 | 35 | 66 | H39681 | N0F | 1 |
| 15 | 31 | 10 | 27 | 35 | 31 | 66 | H39682 | N0F | 1 |
| 15 | 31 | 10 | 31 | 35 | 35 | 70 | H39720 | N0F | 1 |
| 15 | 27 | 10 | 37 | 31 | 41 | 72 | H39741 | N0F | 1 |
| 15 | 37 | 10 | 27 | 41 | 31 | 72 | H39742 | N0F | 1 |
| 15 | 27 | 10 | 41 | 31 | 45 | 76 | H39781 | N0F | 1 |
| 15 | 41 | 10 | 27 | 45 | 31 | 76 | H39782 | N0F | 1 |
| 15 | 31 | 10 | 37 | 35 | 41 | 76 | H39783 | N0F | 1 |
| 15 | 37 | 10 | 31 | 41 | 35 | 76 | H39784 | N0F | 1 |
| 15 | 31 | 10 | 41 | 35 | 45 | 80 | H39821 | N0F | 1 |
| 15 | 41 | 10 | 31 | 45 | 35 | 80 | H39822 | N0F | 1 |
| 15 | 27 | 10 | 47 | 31 | 51 | 82 | H39841 | N0F | 1 |
| 15 | 47 | 10 | 27 | 51 | 31 | 82 | H39842 | N0F | 1 |
| 15 | 37 | 10 | 37 | 41 | 41 | 82 | H39843 | N0F | 1 |
| 15 | 27 | 10 | 51 | 31 | 55 | 86 | H39881 | N0F | 1 |
| 15 | 31 | 10 | 47 | 35 | 51 | 86 | H39882 | N0F | 1 |
| 15 | 37 | 10 | 41 | 41 | 45 | 86 | H39883 | N0F | 1 |
| 15 | 41 | 10 | 37 | 45 | 41 | 86 | H39884 | N0F | 1 |
| 15 | 31 | 10 | 51 | 35 | 55 | 90 | H39921 | N0F | 1 |
| 15 | 41 | 10 | 41 | 45 | 45 | 90 | H39922 | N0F | 1 |
| 15 | 27 | 10 | 57 | 31 | 61 | 92 | H39941 | N0F | 1 |
| 15 | 37 | 10 | 47 | 41 | 51 | 92 | H39942 | N0F | 1 |
| 15 | 37 | 10 | 51 | 41 | 55 | 96 | H39981 | N0F | 1 |
| 15 | 41 | 10 | 47 | 45 | 51 | 96 | H39982 | N0F | 1 |
| 15 | 41 | 10 | 51 | 45 | 55 | 100 | H39020 | N0F | 1 |
| 15 | 27 | 10 | 67 | 31 | 71 | 102 | H39041 | N0F | 1 |
| 15 | 37 | 10 | 57 | 41 | 61 | 102 | H39042 | N0F | 1 |
| 15 | 47 | 10 | 47 | 51 | 51 | 102 | H39043 | N0F | 1 |
| 15 | 27 | 10 | 77 | 31 | 81 | 112 | H39141 | N0F | 1 |
| 15 | 37 | 10 | 67 | 41 | 71 | 112 | H39142 | N0F | 1 |
| 15 | 47 | 10 | 57 | 51 | 61 | 112 | H39143 | N0F | 1 |

con 5 chiavi with 5 keys

..... N5F

Doppio cilindro predisposto pomolo con rinforzo e taglio
 Double cylinder with knob provision with reinforce and cut



HS

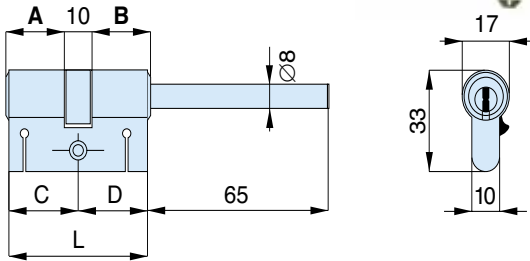

| ▽ | A | B | C | D | L | codice code | euro | |
|----|----|----|----|----|----|-------------|------------|---|
| 15 | 27 | 10 | 27 | 31 | 31 | 62 | H39640 NOL | 1 |
| 15 | 31 | 10 | 27 | 35 | 31 | 66 | H39680 NOL | 1 |
| 15 | 37 | 10 | 27 | 41 | 31 | 72 | H39740 NOL | 1 |
| 15 | 41 | 10 | 27 | 45 | 31 | 76 | H39780 NOL | 1 |
| 15 | 47 | 10 | 27 | 51 | 31 | 82 | H39840 NOL | 1 |
| 15 | 51 | 10 | 27 | 55 | 31 | 86 | H39880 NOL | 1 |
| 15 | 57 | 10 | 27 | 61 | 31 | 92 | H39940 NOL | 1 |
| 15 | 67 | 10 | 27 | 71 | 31 | 102 | H39040 NOL | 1 |
| 15 | 77 | 10 | 27 | 81 | 31 | 112 | H39140 NOL | 1 |

con 5 chiavi with 5 keys

..... N5L

Doppio cilindro predisposto pomolo con rinforzo e taglio
 Double cylinder with knob provision with reinforce and cut



HS

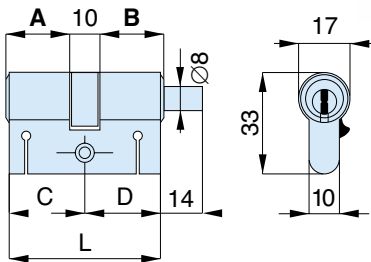

| ▽ | A | B | C | D | L | codice code | euro | |
|----|----|----|----|----|----|-------------|------------|---|
| 15 | 27 | 10 | 27 | 31 | 31 | 62 | H39640 NOC | 1 |
| 15 | 27 | 10 | 31 | 31 | 35 | 66 | H39681 NOC | 1 |
| 15 | 31 | 10 | 27 | 35 | 31 | 66 | H39682 NOC | 1 |
| 15 | 31 | 10 | 31 | 35 | 35 | 70 | H39720 NOC | 1 |
| 15 | 27 | 10 | 37 | 31 | 41 | 72 | H39741 NOC | 1 |
| 15 | 37 | 10 | 27 | 41 | 31 | 72 | H39742 NOC | 1 |
| 15 | 27 | 10 | 41 | 31 | 45 | 76 | H39781 NOC | 1 |
| 15 | 41 | 10 | 27 | 45 | 31 | 76 | H39782 NOC | 1 |
| 15 | 31 | 10 | 37 | 35 | 41 | 76 | H39783 NOC | 1 |
| 15 | 37 | 10 | 31 | 41 | 35 | 76 | H39784 NOC | 1 |
| 15 | 31 | 10 | 41 | 35 | 45 | 80 | H39821 NOC | 1 |
| 15 | 41 | 10 | 31 | 45 | 35 | 80 | H39822 NOC | 1 |
| 15 | 27 | 10 | 47 | 31 | 51 | 82 | H39841 NOC | 1 |
| 15 | 47 | 10 | 27 | 51 | 31 | 82 | H39842 NOC | 1 |
| 15 | 37 | 10 | 37 | 41 | 41 | 82 | H39843 NOC | 1 |
| 15 | 27 | 10 | 51 | 31 | 55 | 86 | H39881 NOC | 1 |
| 15 | 31 | 10 | 47 | 35 | 51 | 86 | H39882 NOC | 1 |
| 15 | 37 | 10 | 41 | 41 | 45 | 86 | H39883 NOC | 1 |
| 15 | 41 | 10 | 37 | 45 | 41 | 86 | H39884 NOC | 1 |
| 15 | 31 | 10 | 51 | 35 | 55 | 90 | H39921 NOC | 1 |
| 15 | 41 | 10 | 41 | 45 | 45 | 90 | H39922 NOC | 1 |
| 15 | 27 | 10 | 57 | 31 | 61 | 92 | H39941 NOC | 1 |
| 15 | 37 | 10 | 47 | 41 | 51 | 92 | H39942 NOC | 1 |
| 15 | 37 | 10 | 51 | 41 | 55 | 96 | H39981 NOC | 1 |
| 15 | 41 | 10 | 47 | 45 | 51 | 96 | H39982 NOC | 1 |
| 15 | 41 | 10 | 51 | 45 | 55 | 100 | H39020 NOC | 1 |
| 15 | 27 | 10 | 67 | 31 | 71 | 102 | H39041 NOC | 1 |
| 15 | 37 | 10 | 57 | 41 | 61 | 102 | H39042 NOC | 1 |
| 15 | 47 | 10 | 47 | 51 | 51 | 102 | H39043 NOC | 1 |
| 15 | 27 | 10 | 77 | 31 | 81 | 112 | H39141 NOC | 1 |
| 15 | 37 | 10 | 67 | 41 | 71 | 112 | H39142 NOC | 1 |
| 15 | 47 | 10 | 57 | 51 | 61 | 112 | H39143 NOC | 1 |

con 5 chiavi with 5 keys

..... N5C





Doppio cilindro ovale
Double oval cylinder



HS

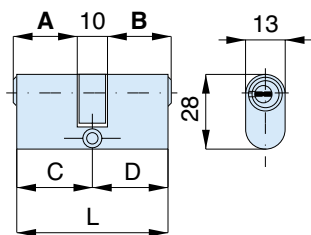

Per cilindri H18 sono previsti solo impianti a chiave uguale
For the cylinders H18 are foreseen just key alike systems

| | A | B | C | D | L | codice code | euro | |
|---|----|----|----|----|----|-------------|------------|---|
| 5 | 27 | 10 | 27 | 31 | 31 | 62 | H18640 N00 | 1 |
| | | | | | | | N50 | |

con 5 chiavi with 5 keys

Doppio cilindro Ø 26
Double cylinder Ø 26



HS

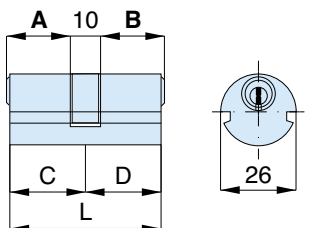

| | A | B | C | D | L | codice code | euro | |
|----|----|----|----|----|----|-------------|------------|---|
| 15 | 27 | 10 | 27 | 31 | 31 | 62 | H19640 N00 | 1 |
| 15 | 27 | 10 | 47 | 31 | 51 | 82 | H19841 N00 | 1 |
| | | | | | | | N50 | |

con 5 chiavi with 5 keys

Doppio cilindro Ø 22
Double cylinder Ø 22



HS

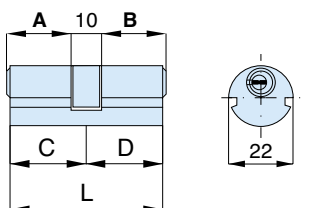

| | A | B | C | D | L | codice code | euro | |
|---|----|----|----|----|----|-------------|------------|---|
| 5 | 27 | 10 | 27 | 31 | 31 | 62 | H20640 N00 | 1 |
| | | | | | | | N50 | |

con 5 chiavi with 5 keys

Per cilindri H20 sono previsti solo impianti a chiave uguale
For the cylinders H20 are foreseen just key alike systems

■ **CILINDRI DA APPLICARE**
RIM CYLINDERS



P. 51

■ **CILINDRI DA INFILARE**
MORTICE CYLINDERS



P. 52

■ **CILINDRI DA INFILARE CON RINFORZO E
TAGLIO ANTITORSIONE BREVETTATO**
MORTICE CYLINDERS WITH PATENTED
REINFORCE AND CUT AGAINST BREAKING



P. 56

■ **CILINDRI DA INFILARE MODULARI CON
TAGLIO ANTITORSIONE BREVETTATO**
MODULAR MORTICE CYLINDERS WITH
PATENTED CUT AGAINST BREAKING



P. 60

■ **CILINDRI OVALI (SOLO 5 PERNI)**
OVAL CYLINDERS (ONLY 5 PINS)



P. 64

■ **CILINDRI Ø 26 (15 PERNI)**
Ø 26 CYLINDERS (15 PINS)



P. 64

■ **CILINDRI Ø 22 (SOLO 5 PERNI)**
Ø 22 CYLINDERS (ONLY 5 PINS)



P. 64

SISTEMA BREVETTATO: CHIAVE CON ELEMENTO MOBILE PATENTED SYSTEM: KEY WITH MOBILE ELEMENT

- ✓ **Sistema a 15 perni attivi**
System with 15 active pins
- ✓ **Corpo in ottone nichelato**
Nickel plated brass body
- ✓ **Perni in acciaio temprato**
Hardened steel pins
- ✓ **Controperni in acciaio inox**
Stainless steel top pins
- ✓ **Molle in acciaio inox**
Stainless steel springs
- ✓ **Camma DIN 30° (cilindri da infilare)**
DIN 30° cam (mortice cylinders)
- ✓ **3 chiavi reversibili in alpaca con impugnatura rivestita in plastica, collo lungo e numerazione a codice indiretto sulla testa**
3 reversible keys in nickel silver with plastic-coated grip, long neck numbered on key head
- ✓ **Security card**
Security card
- ✓ **Vite di fissaggio**
Fixing screw

Brevetto Europeo
Scadenza 2022

European Patent
Date filed 2022

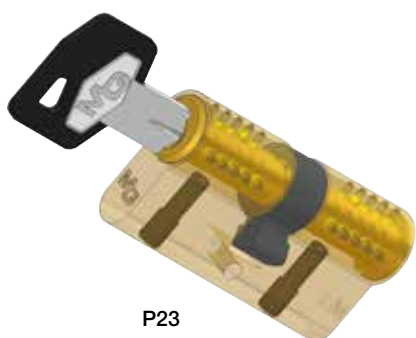

P23

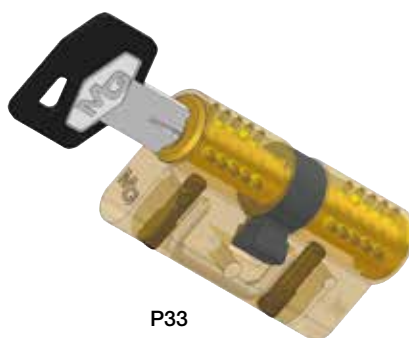

P33

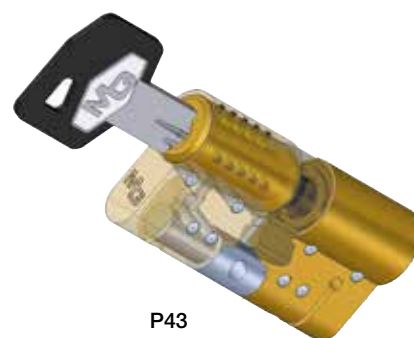

P43

Cilindro per art. 711
Cylinder for art. 711

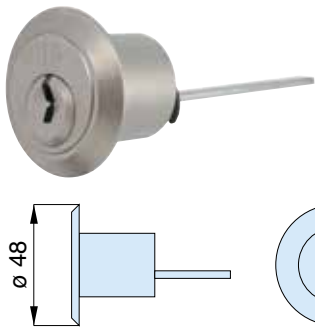

HSP



| | A | B | C | D | L | codice code | euro | |
|----|--------------------------|---|---|---|---|-------------------|-----------|---|
| 15 | | | | | | P11000 N00 | | 1 |
| | con 5 chiavi with 5 keys | | | | | | N50 | |

Cilindro per art. 712
Cylinder for art. 712

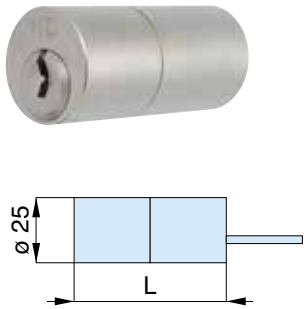

HSP



| | A | B | C | D | L | codice code | euro | |
|----|--------------------------|---|---|---|----|-------------------|-----------|---|
| 15 | | | | | 50 | P12500 N00 | | 1 |
| | con 5 chiavi with 5 keys | | | | | | N50 | |

Coppia cilindri
Double rim cylinder

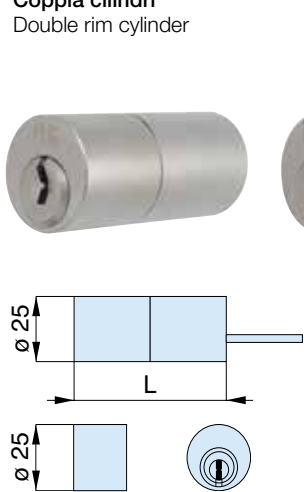

HSP



| | A | B | C | D | L | codice code | euro | |
|----|--------------------------|---|---|---|----|-------------------|-----------|---|
| 15 | | | | | 50 | P14500 N00 | | 1 |
| | con 5 chiavi with 5 keys | | | | | | N50 | |

Coppia cilindri
Double rim cylinder

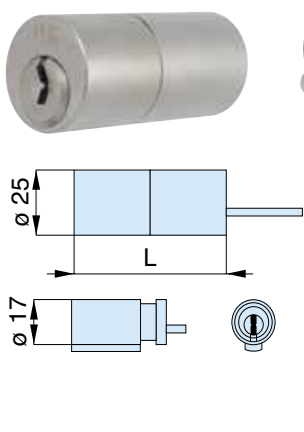

HSP



| | A | B | C | D | L | codice code | euro | |
|----|--------------------------|---|---|---|----|-------------------|-----------|---|
| 15 | | | | | 50 | P14501 N00 | | 1 |
| | con 5 chiavi with 5 keys | | | | | | N50 | |



CILINDRI DI SICUREZZA DA APPLICARE
security rim cylinders



Doppio cilindro
Double cylinder



HSP

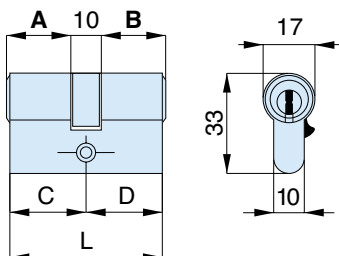

| ↓ | A | B | C | D | L | codice code | euro | 📄 |
|----|----|----|----|----|----|----------------|------------|---|
| 15 | 27 | 10 | 27 | 31 | 31 | 62 | P23640 N00 | 1 |
| 15 | 27 | 10 | 31 | 31 | 35 | 66 | P23680 N00 | 1 |
| 15 | 31 | 10 | 31 | 35 | 35 | 70 | P23720 N00 | 1 |
| 15 | 27 | 10 | 37 | 31 | 41 | 72 | P23740 N00 | 1 |
| 15 | 27 | 10 | 41 | 31 | 45 | 76 | P23781 N00 | 1 |
| 15 | 31 | 10 | 37 | 35 | 41 | 76 | P23782 N00 | 1 |
| 15 | 31 | 10 | 41 | 35 | 45 | 80 | P23820 N00 | 1 |
| 15 | 27 | 10 | 47 | 31 | 51 | 82 | P23841 N00 | 1 |
| 15 | 37 | 10 | 37 | 41 | 41 | 82 | P23842 N00 | 1 |
| 15 | 27 | 10 | 51 | 31 | 55 | 86 | P23881 N00 | 1 |
| 15 | 31 | 10 | 47 | 35 | 51 | 86 | P23882 N00 | 1 |
| 15 | 37 | 10 | 41 | 41 | 45 | 86 | P23883 N00 | 1 |
| 15 | 31 | 10 | 51 | 35 | 55 | 90 | P23921 N00 | 1 |
| 15 | 41 | 10 | 41 | 45 | 45 | 90 | P23922 N00 | 1 |
| 15 | 27 | 10 | 57 | 31 | 61 | 92 | P23941 N00 | 1 |
| 15 | 37 | 10 | 47 | 41 | 51 | 92 | P23942 N00 | 1 |
| 15 | 37 | 10 | 51 | 41 | 55 | 96 | P23981 N00 | 1 |
| 15 | 41 | 10 | 47 | 45 | 51 | 96 | P23982 N00 | 1 |
| 15 | 31 | 10 | 57 | 35 | 61 | 96 | P23983 N00 | 1 |
| 15 | 41 | 10 | 51 | 45 | 55 | 100 | P23020 N00 | 1 |
| 15 | 27 | 10 | 67 | 31 | 71 | 102 | P23041 N00 | 1 |
| 15 | 37 | 10 | 57 | 41 | 61 | 102 | P23042 N00 | 1 |
| 15 | 47 | 10 | 47 | 51 | 51 | 102 | P23043 N00 | 1 |
| 15 | 27 | 10 | 77 | 31 | 81 | 112 | P23141 N00 | 1 |
| 15 | 37 | 10 | 67 | 41 | 71 | 112 | P23142 N00 | 1 |
| 15 | 47 | 10 | 57 | 51 | 61 | 112 | P23143 N00 | 1 |
| 15 | 47 | 10 | 67 | 51 | 71 | 112 | P23243 N00 | 1 |

con 5 chiavi with 5 keys

..... N50

frizionato frictioned

..... NOX

Mezzo cilindro con camma regolabile in 8 posizioni
Half cylinder with adjustable cam in 8 positions



HSP

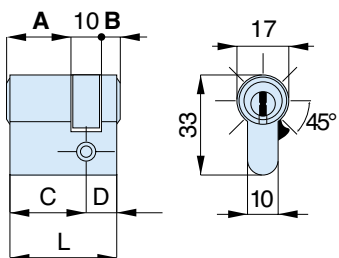

| ↓ | A | B | C | D | L | codice code | euro | 📄 |
|----|----|----|---|----|----|----------------|------------|---|
| 15 | 27 | 10 | 5 | 31 | 10 | 41 | P24420 N00 | 1 |
| 15 | 31 | 10 | 5 | 35 | 10 | 45 | P24460 N00 | 1 |
| 15 | 37 | 10 | 5 | 41 | 10 | 51 | P24520 N00 | 1 |
| 15 | 41 | 10 | 5 | 45 | 10 | 55 | P24560 N00 | 1 |
| 15 | 47 | 10 | 5 | 51 | 10 | 61 | P24620 N00 | 1 |
| 15 | 57 | 10 | 5 | 61 | 10 | 71 | P24720 N00 | 1 |
| 15 | 67 | 10 | 5 | 71 | 10 | 81 | P24820 N00 | 1 |
| 15 | 77 | 10 | 5 | 81 | 10 | 91 | P24920 N00 | 1 |

con 5 chiavi with 5 keys

..... N50

Mezzo cilindro per lucchetto di sicurezza P92 - nickel opaco
Half cylinder for security padlock P92 - matt nickel

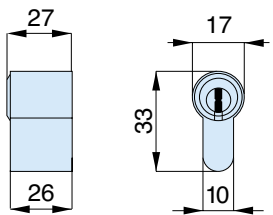

HSP

| | A | B | C | D | L | codice code | euro | |
|----|---|---|---|---|---|-------------------|------|---|
| 15 | | | | | | P24270 N00 | | 1 |
| | | | | | | N50 | | |

con 5 chiavi with 5 keys

Doppio cilindro con pomolo ottone nichelato opaco
Double cylinder with matt nickel-plated brass knob

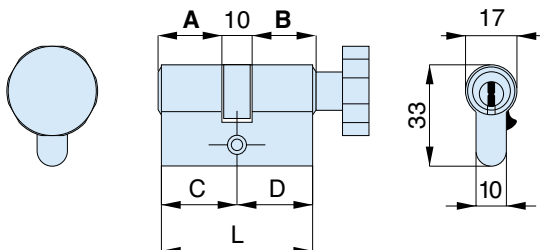

HSP

| | A | B | C | D | L | codice code | euro | |
|----|----|----|----|----|----|----------------|-------------------|---|
| 15 | 27 | 10 | 27 | 31 | 31 | 62 | P29640 NOR | 1 |
| 15 | 27 | 10 | 31 | 31 | 35 | 66 | P29681 NOR | 1 |
| 15 | 31 | 10 | 27 | 35 | 31 | 66 | P29682 NOR | 1 |
| 15 | 31 | 10 | 31 | 35 | 35 | 70 | P29720 NOR | 1 |
| 15 | 27 | 10 | 37 | 31 | 41 | 72 | P29741 NOR | 1 |
| 15 | 37 | 10 | 27 | 41 | 31 | 72 | P29742 NOR | 1 |
| 15 | 27 | 10 | 41 | 31 | 45 | 76 | P29781 NOR | 1 |
| 15 | 41 | 10 | 27 | 45 | 31 | 76 | P29782 NOR | 1 |
| 15 | 31 | 10 | 37 | 35 | 41 | 76 | P29783 NOR | 1 |
| 15 | 37 | 10 | 31 | 41 | 35 | 76 | P29784 NOR | 1 |
| 15 | 31 | 10 | 41 | 35 | 45 | 80 | P29821 NOR | 1 |
| 15 | 41 | 10 | 31 | 45 | 35 | 80 | P29822 NOR | 1 |
| 15 | 27 | 10 | 47 | 31 | 51 | 82 | P29841 NOR | 1 |
| 15 | 47 | 10 | 27 | 51 | 31 | 82 | P29842 NOR | 1 |
| 15 | 37 | 10 | 37 | 41 | 41 | 82 | P29843 NOR | 1 |
| 15 | 27 | 10 | 51 | 31 | 55 | 86 | P29881 NOR | 1 |
| 15 | 31 | 10 | 47 | 35 | 51 | 86 | P29882 NOR | 1 |
| 15 | 37 | 10 | 41 | 41 | 45 | 86 | P29883 NOR | 1 |
| 15 | 41 | 10 | 37 | 45 | 41 | 86 | P29884 NOR | 1 |
| 15 | 31 | 10 | 51 | 35 | 55 | 90 | P29921 NOR | 1 |
| 15 | 41 | 10 | 41 | 45 | 45 | 90 | P29922 NOR | 1 |
| 15 | 27 | 10 | 57 | 31 | 61 | 92 | P29941 NOR | 1 |
| 15 | 37 | 10 | 47 | 41 | 51 | 92 | P29942 NOR | 1 |
| 15 | 37 | 10 | 51 | 41 | 55 | 96 | P29981 NOR | 1 |
| 15 | 41 | 10 | 47 | 45 | 51 | 96 | P29982 NOR | 1 |
| 15 | 41 | 10 | 51 | 45 | 55 | 100 | P29020 NOR | 1 |
| 15 | 27 | 10 | 67 | 31 | 71 | 102 | P29041 NOR | 1 |
| 15 | 37 | 10 | 57 | 41 | 61 | 102 | P29042 NOR | 1 |
| 15 | 47 | 10 | 47 | 51 | 51 | 102 | P29043 NOR | 1 |
| 15 | 27 | 10 | 77 | 31 | 81 | 112 | P29141 NOR | 1 |
| 15 | 37 | 10 | 67 | 41 | 71 | 112 | P29142 NOR | 1 |
| 15 | 47 | 10 | 57 | 51 | 61 | 112 | P29143 NOR | 1 |

con 5 chiavi with 5 keys

..... N5R

CILINDRI DI SICUREZZA DA INFILARE
security mortice cylinders



Doppio cilindro con pomolo ottone nichelato opaco
Double cylinder with matt nickel-plated brass knob



HSP

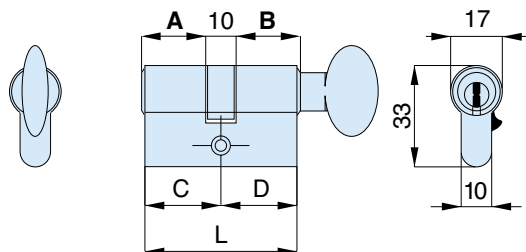

| | A | B | C | D | L | codice code | euro | | |
|----|----|----|----|----|----|----------------|--------|-----|---|
| 15 | 27 | 10 | 27 | 31 | 31 | 62 | P29640 | N0F | 1 |
| 15 | 27 | 10 | 31 | 31 | 35 | 66 | P29681 | N0F | 1 |
| 15 | 31 | 10 | 27 | 35 | 31 | 66 | P29682 | N0F | 1 |
| 15 | 31 | 10 | 31 | 35 | 35 | 70 | P29720 | N0F | 1 |
| 15 | 27 | 10 | 37 | 31 | 41 | 72 | P29741 | N0F | 1 |
| 15 | 37 | 10 | 27 | 41 | 31 | 72 | P29742 | N0F | 1 |
| 15 | 27 | 10 | 41 | 31 | 45 | 76 | P29781 | N0F | 1 |
| 15 | 41 | 10 | 27 | 45 | 31 | 76 | P29782 | N0F | 1 |
| 15 | 31 | 10 | 37 | 35 | 41 | 76 | P29783 | N0F | 1 |
| 15 | 37 | 10 | 31 | 41 | 35 | 76 | P29784 | N0F | 1 |
| 15 | 31 | 10 | 41 | 35 | 45 | 80 | P29821 | N0F | 1 |
| 15 | 41 | 10 | 31 | 45 | 35 | 80 | P29822 | N0F | 1 |
| 15 | 27 | 10 | 47 | 31 | 51 | 82 | P29841 | N0F | 1 |
| 15 | 47 | 10 | 27 | 51 | 31 | 82 | P29842 | N0F | 1 |
| 15 | 37 | 10 | 37 | 41 | 41 | 82 | P29843 | N0F | 1 |
| 15 | 27 | 10 | 51 | 31 | 55 | 86 | P29881 | N0F | 1 |
| 15 | 31 | 10 | 47 | 35 | 51 | 86 | P29882 | N0F | 1 |
| 15 | 37 | 10 | 41 | 41 | 45 | 86 | P29883 | N0F | 1 |
| 15 | 41 | 10 | 37 | 45 | 41 | 86 | P29884 | N0F | 1 |
| 15 | 31 | 10 | 51 | 35 | 55 | 90 | P29921 | N0F | 1 |
| 15 | 41 | 10 | 41 | 45 | 45 | 90 | P29922 | N0F | 1 |
| 15 | 27 | 10 | 57 | 31 | 61 | 92 | P29941 | N0F | 1 |
| 15 | 37 | 10 | 47 | 41 | 51 | 92 | P29942 | N0F | 1 |
| 15 | 37 | 10 | 51 | 41 | 55 | 96 | P29981 | N0F | 1 |
| 15 | 41 | 10 | 47 | 45 | 51 | 96 | P29982 | N0F | 1 |
| 15 | 41 | 10 | 51 | 45 | 55 | 100 | P29020 | N0F | 1 |
| 15 | 27 | 10 | 67 | 31 | 71 | 102 | P29041 | N0F | 1 |
| 15 | 37 | 10 | 57 | 41 | 61 | 102 | P29042 | N0F | 1 |
| 15 | 47 | 10 | 47 | 51 | 51 | 102 | P29043 | N0F | 1 |
| 15 | 27 | 10 | 77 | 31 | 81 | 112 | P29141 | N0F | 1 |
| 15 | 37 | 10 | 67 | 41 | 71 | 112 | P29142 | N0F | 1 |
| 15 | 47 | 10 | 57 | 51 | 61 | 112 | P29143 | N0F | 1 |

con 5 chiavi with 5 keys

..... N5F

Doppio cilindro predisposto pomolo
Double cylinder with knob provision



HSP

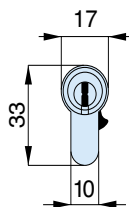
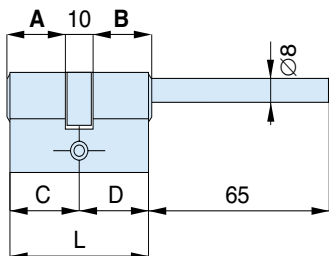

| ▽ | A | B | C | D | L | codice code | euro | | |
|----|----|----|----|----|----|----------------|--------|-----|---|
| 15 | 27 | 10 | 27 | 31 | 31 | 62 | P29640 | N0L | 1 |
| 15 | 31 | 10 | 27 | 35 | 31 | 66 | P29680 | N0L | 1 |
| 15 | 37 | 10 | 27 | 41 | 31 | 72 | P29740 | N0L | 1 |
| 15 | 41 | 10 | 27 | 45 | 31 | 76 | P29780 | N0L | 1 |
| 15 | 47 | 10 | 27 | 51 | 31 | 82 | P29840 | N0L | 1 |
| 15 | 51 | 10 | 27 | 55 | 31 | 86 | P29880 | N0L | 1 |
| 15 | 57 | 10 | 27 | 61 | 31 | 92 | P29940 | N0L | 1 |
| 15 | 67 | 10 | 27 | 71 | 31 | 102 | P29040 | N0L | 1 |
| 15 | 77 | 10 | 27 | 81 | 31 | 112 | P29140 | N0L | 1 |

con 5 chiavi with 5 keys

..... N5L

Doppio cilindro predisposto pomolo
Double cylinder with knob provision



HSP

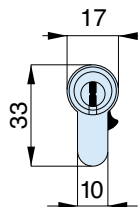
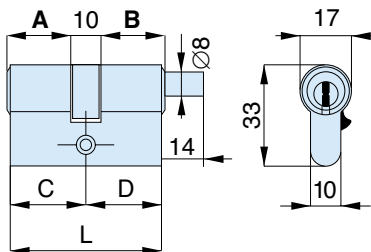

| ▽ | A | B | C | D | L | codice code | euro | | |
|----|----|----|----|----|----|----------------|--------|-----|---|
| 15 | 27 | 10 | 27 | 31 | 31 | 62 | P29640 | N0C | 1 |
| 15 | 27 | 10 | 31 | 31 | 35 | 66 | P29681 | N0C | 1 |
| 15 | 31 | 10 | 27 | 35 | 31 | 66 | P29682 | N0C | 1 |
| 15 | 31 | 10 | 31 | 35 | 35 | 70 | P29720 | N0C | 1 |
| 15 | 27 | 10 | 37 | 31 | 41 | 72 | P29741 | N0C | 1 |
| 15 | 37 | 10 | 27 | 41 | 31 | 72 | P29742 | N0C | 1 |
| 15 | 27 | 10 | 41 | 31 | 45 | 76 | P29781 | N0C | 1 |
| 15 | 41 | 10 | 27 | 45 | 31 | 76 | P29782 | N0C | 1 |
| 15 | 31 | 10 | 37 | 35 | 41 | 76 | P29783 | N0C | 1 |
| 15 | 37 | 10 | 31 | 41 | 35 | 76 | P29784 | N0C | 1 |
| 15 | 31 | 10 | 41 | 35 | 45 | 80 | P29821 | N0C | 1 |
| 15 | 41 | 10 | 31 | 45 | 35 | 80 | P29822 | N0C | 1 |
| 15 | 27 | 10 | 47 | 31 | 51 | 82 | P29841 | N0C | 1 |
| 15 | 47 | 10 | 27 | 51 | 31 | 82 | P29842 | N0C | 1 |
| 15 | 37 | 10 | 37 | 41 | 41 | 82 | P29843 | N0C | 1 |
| 15 | 27 | 10 | 51 | 31 | 55 | 86 | P29881 | N0C | 1 |
| 15 | 31 | 10 | 47 | 35 | 51 | 86 | P29882 | N0C | 1 |
| 15 | 37 | 10 | 41 | 41 | 45 | 86 | P29883 | N0C | 1 |
| 15 | 41 | 10 | 37 | 45 | 41 | 86 | P29884 | N0C | 1 |
| 15 | 31 | 10 | 51 | 35 | 55 | 90 | P29921 | N0C | 1 |
| 15 | 41 | 10 | 41 | 45 | 45 | 90 | P29922 | N0C | 1 |
| 15 | 27 | 10 | 57 | 31 | 61 | 92 | P29941 | N0C | 1 |
| 15 | 37 | 10 | 47 | 41 | 51 | 92 | P29942 | N0C | 1 |
| 15 | 37 | 10 | 51 | 41 | 55 | 96 | P29981 | N0C | 1 |
| 15 | 41 | 10 | 47 | 45 | 51 | 96 | P29982 | N0C | 1 |
| 15 | 41 | 10 | 51 | 45 | 55 | 100 | P29020 | N0C | 1 |
| 15 | 27 | 10 | 67 | 31 | 71 | 102 | P29041 | N0C | 1 |
| 15 | 37 | 10 | 57 | 41 | 61 | 102 | P29042 | N0C | 1 |
| 15 | 47 | 10 | 47 | 51 | 51 | 102 | P29043 | N0C | 1 |
| 15 | 27 | 10 | 77 | 31 | 81 | 112 | P29141 | N0C | 1 |
| 15 | 37 | 10 | 67 | 41 | 71 | 112 | P29142 | N0C | 1 |
| 15 | 47 | 10 | 57 | 51 | 61 | 112 | P29143 | N0C | 1 |

con 5 chiavi with 5 keys

..... N5C

CILINDRI DI SICUREZZA DA INFILARE
security mortice cylinders





Doppio cilindro con rinforzo e taglio
Double cylinder with reinforce and cut



HSP

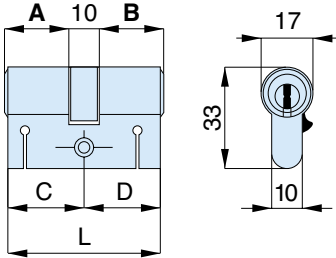

| ↓ | A | B | C | D | L | codice code | euro | ✎ | 📦 |
|----|----|----|----|----|----|----------------|------------|---|---|
| 15 | 27 | 10 | 27 | 31 | 31 | 62 | P33640 N00 | | 1 |
| 15 | 27 | 10 | 31 | 31 | 35 | 66 | P33680 N00 | | 1 |
| 15 | 31 | 10 | 31 | 35 | 35 | 70 | P33720 N00 | | 1 |
| 15 | 27 | 10 | 37 | 31 | 41 | 72 | P33740 N00 | | 1 |
| 15 | 27 | 10 | 41 | 31 | 45 | 76 | P33781 N00 | | 1 |
| 15 | 31 | 10 | 37 | 35 | 41 | 76 | P33782 N00 | | 1 |
| 15 | 31 | 10 | 41 | 35 | 45 | 80 | P33820 N00 | | 1 |
| 15 | 27 | 10 | 47 | 31 | 51 | 82 | P33841 N00 | | 1 |
| 15 | 37 | 10 | 37 | 41 | 41 | 82 | P33842 N00 | | 1 |
| 15 | 27 | 10 | 51 | 31 | 55 | 86 | P33881 N00 | | 1 |
| 15 | 31 | 10 | 47 | 35 | 51 | 86 | P33882 N00 | | 1 |
| 15 | 37 | 10 | 41 | 41 | 45 | 86 | P33883 N00 | | 1 |
| 15 | 31 | 10 | 51 | 35 | 55 | 90 | P33921 N00 | | 1 |
| 15 | 41 | 10 | 41 | 45 | 45 | 90 | P33922 N00 | | 1 |
| 15 | 27 | 10 | 57 | 31 | 61 | 92 | P33941 N00 | | 1 |
| 15 | 37 | 10 | 47 | 41 | 51 | 92 | P33942 N00 | | 1 |
| 15 | 37 | 10 | 51 | 41 | 55 | 96 | P33981 N00 | | 1 |
| 15 | 41 | 10 | 47 | 45 | 51 | 96 | P33982 N00 | | 1 |
| 15 | 31 | 10 | 57 | 35 | 61 | 96 | P33983 N00 | | 1 |
| 15 | 41 | 10 | 51 | 45 | 55 | 100 | P33020 N00 | | 1 |
| 15 | 27 | 10 | 67 | 31 | 71 | 102 | P33041 N00 | | 1 |
| 15 | 37 | 10 | 57 | 41 | 61 | 102 | P33042 N00 | | 1 |
| 15 | 47 | 10 | 47 | 51 | 51 | 102 | P33043 N00 | | 1 |
| 15 | 27 | 10 | 77 | 31 | 81 | 112 | P33141 N00 | | 1 |
| 15 | 37 | 10 | 67 | 41 | 71 | 112 | P33142 N00 | | 1 |
| 15 | 47 | 10 | 57 | 51 | 61 | 112 | P33143 N00 | | 1 |
| 15 | 47 | 10 | 67 | 51 | 71 | 122 | P33243 N00 | | 1 |

con 5 chiavi with 5 keys

..... N50

frizionato frictioned

..... NOX

Mezzo cilindro con taglio e camma regolabile in 8 posizioni
Half cylinder with cut and adjustable cam in 8 positions



HSP

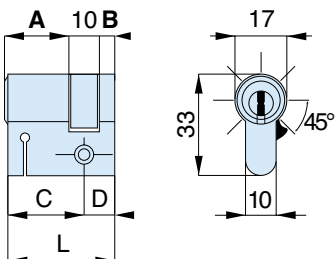

| ↓ | A | B | C | D | L | codice code | euro | ✎ | 📦 |
|----|----|----|---|----|----|----------------|------------|---|---|
| 15 | 27 | 10 | 5 | 31 | 10 | 41 | P34420 N00 | | 1 |
| 15 | 31 | 10 | 5 | 35 | 10 | 45 | P34460 N00 | | 1 |
| 15 | 37 | 10 | 5 | 41 | 10 | 51 | P34520 N00 | | 1 |
| 15 | 41 | 10 | 5 | 45 | 10 | 55 | P34560 N00 | | 1 |
| 15 | 47 | 10 | 5 | 51 | 10 | 61 | P34620 N00 | | 1 |
| 15 | 57 | 10 | 5 | 61 | 10 | 71 | P34720 N00 | | 1 |
| 15 | 67 | 10 | 5 | 71 | 10 | 81 | P34820 N00 | | 1 |
| 15 | 77 | 10 | 5 | 81 | 10 | 91 | P34920 N00 | | 1 |

con 5 chiavi with 5 keys

..... N50

Doppio cilindro con pomolo ottone nichelato opaco con rinforzo e taglio
 Double cylinder with matt nickel-plated brass knob with reinforce and cut

HSP

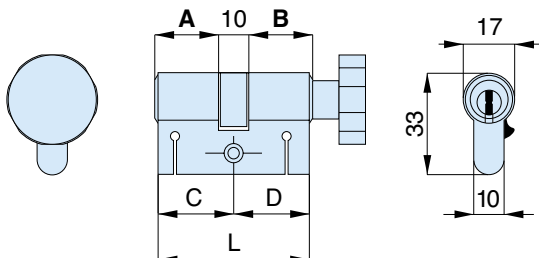

| ▽ | A | B | C | D | L | codice code | euro | |
|----|----|----|----|----|----|----------------|------------|---|
| 15 | 27 | 10 | 27 | 31 | 31 | 62 | P39640 NOR | 1 |
| 15 | 27 | 10 | 31 | 31 | 35 | 66 | P39681 NOR | 1 |
| 15 | 31 | 10 | 27 | 35 | 31 | 66 | P39682 NOR | 1 |
| 15 | 31 | 10 | 31 | 35 | 35 | 70 | P39720 NOR | 1 |
| 15 | 27 | 10 | 37 | 31 | 41 | 72 | P39741 NOR | 1 |
| 15 | 37 | 10 | 27 | 41 | 31 | 72 | P39742 NOR | 1 |
| 15 | 27 | 10 | 41 | 31 | 45 | 76 | P39781 NOR | 1 |
| 15 | 41 | 10 | 27 | 45 | 31 | 76 | P39782 NOR | 1 |
| 15 | 31 | 10 | 37 | 35 | 41 | 76 | P39783 NOR | 1 |
| 15 | 37 | 10 | 31 | 41 | 35 | 76 | P39784 NOR | 1 |
| 15 | 31 | 10 | 41 | 35 | 45 | 80 | P39821 NOR | 1 |
| 15 | 41 | 10 | 31 | 45 | 35 | 80 | P39822 NOR | 1 |
| 15 | 27 | 10 | 47 | 31 | 51 | 82 | P39841 NOR | 1 |
| 15 | 47 | 10 | 27 | 51 | 31 | 82 | P39842 NOR | 1 |
| 15 | 37 | 10 | 37 | 41 | 41 | 82 | P39843 NOR | 1 |
| 15 | 27 | 10 | 51 | 31 | 55 | 86 | P39881 NOR | 1 |
| 15 | 31 | 10 | 47 | 35 | 51 | 86 | P39882 NOR | 1 |
| 15 | 37 | 10 | 41 | 41 | 45 | 86 | P39883 NOR | 1 |
| 15 | 41 | 10 | 37 | 45 | 41 | 86 | P39884 NOR | 1 |
| 15 | 31 | 10 | 51 | 35 | 55 | 90 | P39921 NOR | 1 |
| 15 | 41 | 10 | 41 | 45 | 45 | 90 | P39922 NOR | 1 |
| 15 | 27 | 10 | 57 | 31 | 61 | 92 | P39941 NOR | 1 |
| 15 | 37 | 10 | 47 | 41 | 51 | 92 | P39942 NOR | 1 |
| 15 | 37 | 10 | 51 | 41 | 55 | 96 | P39981 NOR | 1 |
| 15 | 41 | 10 | 47 | 45 | 51 | 96 | P39982 NOR | 1 |
| 15 | 41 | 10 | 51 | 45 | 55 | 100 | P39020 NOR | 1 |
| 15 | 27 | 10 | 67 | 31 | 71 | 102 | P39041 NOR | 1 |
| 15 | 37 | 10 | 57 | 41 | 61 | 102 | P39042 NOR | 1 |
| 15 | 47 | 10 | 47 | 51 | 51 | 102 | P39043 NOR | 1 |
| 15 | 27 | 10 | 77 | 31 | 81 | 112 | P39141 NOR | 1 |
| 15 | 37 | 10 | 67 | 41 | 71 | 112 | P39142 NOR | 1 |
| 15 | 47 | 10 | 57 | 51 | 61 | 112 | P39143 NOR | 1 |

con 5 chiavi with 5 keys

..... N5R





Doppio cilindro con pomolo ottone nichelato opaco con rinforzo e taglio
Double cylinder with matt nickel-plated brass knob with reinforce and cut



HSP

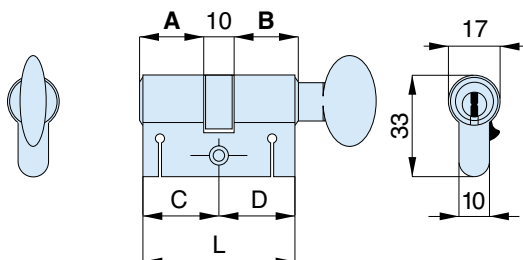

| | A | B | C | D | L | codice code | euro | | |
|----|----|----|----|----|----|----------------|--------|-----|---|
| 15 | 27 | 10 | 27 | 31 | 31 | 62 | P39640 | N0F | 1 |
| 15 | 27 | 10 | 31 | 31 | 35 | 66 | P39681 | N0F | 1 |
| 15 | 31 | 10 | 27 | 35 | 31 | 66 | P39682 | N0F | 1 |
| 15 | 31 | 10 | 31 | 35 | 35 | 70 | P39720 | N0F | 1 |
| 15 | 27 | 10 | 37 | 31 | 41 | 72 | P39741 | N0F | 1 |
| 15 | 37 | 10 | 27 | 41 | 31 | 72 | P39742 | N0F | 1 |
| 15 | 27 | 10 | 41 | 31 | 45 | 76 | P39781 | N0F | 1 |
| 15 | 41 | 10 | 27 | 45 | 31 | 76 | P39782 | N0F | 1 |
| 15 | 31 | 10 | 37 | 35 | 41 | 76 | P39783 | N0F | 1 |
| 15 | 37 | 10 | 31 | 41 | 35 | 76 | P39784 | N0F | 1 |
| 15 | 31 | 10 | 41 | 35 | 45 | 80 | P39821 | N0F | 1 |
| 15 | 41 | 10 | 31 | 45 | 35 | 80 | P39822 | N0F | 1 |
| 15 | 27 | 10 | 47 | 31 | 51 | 82 | P39841 | N0F | 1 |
| 15 | 47 | 10 | 27 | 51 | 31 | 82 | P39842 | N0F | 1 |
| 15 | 37 | 10 | 37 | 41 | 41 | 82 | P39843 | N0F | 1 |
| 15 | 27 | 10 | 51 | 31 | 55 | 86 | P39881 | N0F | 1 |
| 15 | 31 | 10 | 47 | 35 | 51 | 86 | P39882 | N0F | 1 |
| 15 | 37 | 10 | 41 | 41 | 45 | 86 | P39883 | N0F | 1 |
| 15 | 41 | 10 | 37 | 45 | 41 | 86 | P39884 | N0F | 1 |
| 15 | 31 | 10 | 51 | 35 | 55 | 90 | P39921 | N0F | 1 |
| 15 | 41 | 10 | 41 | 45 | 45 | 90 | P39922 | N0F | 1 |
| 15 | 27 | 10 | 57 | 31 | 61 | 92 | P39941 | N0F | 1 |
| 15 | 37 | 10 | 47 | 41 | 51 | 92 | P39942 | N0F | 1 |
| 15 | 37 | 10 | 51 | 41 | 55 | 96 | P39981 | N0F | 1 |
| 15 | 41 | 10 | 47 | 45 | 51 | 96 | P39982 | N0F | 1 |
| 15 | 41 | 10 | 51 | 45 | 55 | 100 | P39020 | N0F | 1 |
| 15 | 27 | 10 | 67 | 31 | 71 | 102 | P39041 | N0F | 1 |
| 15 | 37 | 10 | 57 | 41 | 61 | 102 | P39042 | N0F | 1 |
| 15 | 47 | 10 | 47 | 51 | 51 | 102 | P39043 | N0F | 1 |
| 15 | 27 | 10 | 77 | 31 | 81 | 112 | P39141 | N0F | 1 |
| 15 | 37 | 10 | 67 | 41 | 71 | 112 | P39142 | N0F | 1 |
| 15 | 47 | 10 | 57 | 51 | 61 | 112 | P39143 | N0F | 1 |

con 5 chiavi with 5 keys

..... N5F

Doppio cilindro predisposto pomolo con rinforzo e taglio
 Double cylinder with knob provision with reinforce and cut

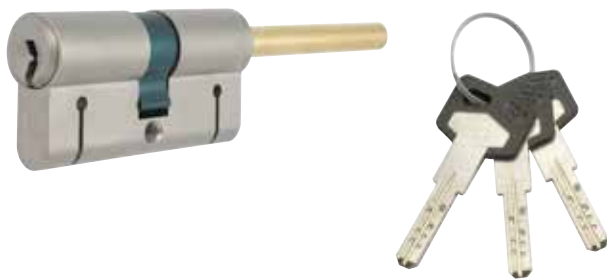

HSP

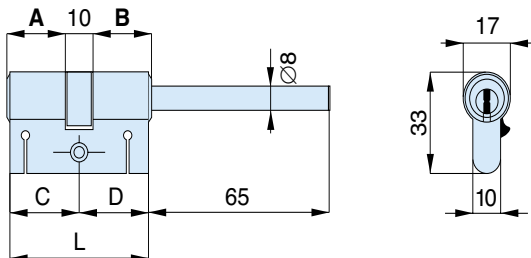

| ▽ | A | B | C | D | L | codice code | euro | |
|----|----|----|----|----|----|-------------|------------|---|
| 15 | 27 | 10 | 27 | 31 | 31 | 62 | P39640 N0L | 1 |
| 15 | 31 | 10 | 27 | 35 | 31 | 66 | P39680 N0L | 1 |
| 15 | 37 | 10 | 27 | 41 | 31 | 72 | P39740 N0L | 1 |
| 15 | 41 | 10 | 27 | 45 | 31 | 76 | P39780 N0L | 1 |
| 15 | 47 | 10 | 27 | 51 | 31 | 82 | P39840 N0L | 1 |
| 15 | 51 | 10 | 27 | 55 | 31 | 86 | P39880 N0L | 1 |
| 15 | 57 | 10 | 27 | 61 | 31 | 92 | P39940 N0L | 1 |
| 15 | 67 | 10 | 27 | 71 | 31 | 102 | P39040 N0L | 1 |
| 15 | 77 | 10 | 27 | 81 | 31 | 112 | P39140 N0L | 1 |

con 5 chiavi with 5 keys

..... N5L

Doppio cilindro predisposto pomolo con rinforzo e taglio
 Double cylinder with knob provision with reinforce and cut

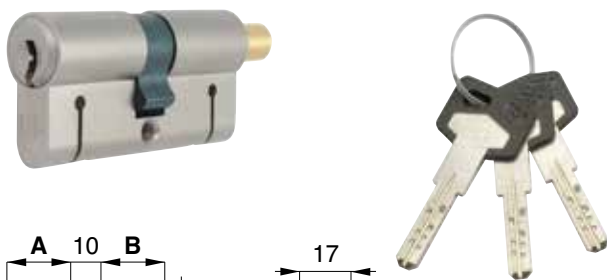

HSP

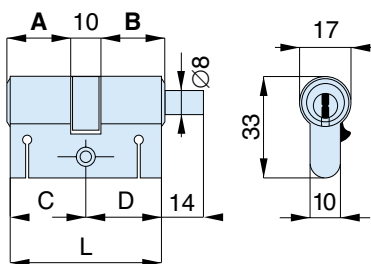

| ▽ | A | B | C | D | L | codice code | euro | |
|----|----|----|----|----|----|-------------|------------|---|
| 15 | 27 | 10 | 27 | 31 | 31 | 62 | P39640 N0C | 1 |
| 15 | 27 | 10 | 31 | 31 | 35 | 66 | P39681 N0C | 1 |
| 15 | 31 | 10 | 27 | 35 | 31 | 66 | P39682 N0C | 1 |
| 15 | 31 | 10 | 31 | 35 | 35 | 70 | P39720 N0C | 1 |
| 15 | 27 | 10 | 37 | 31 | 41 | 72 | P39741 N0C | 1 |
| 15 | 37 | 10 | 27 | 41 | 31 | 72 | P39742 N0C | 1 |
| 15 | 27 | 10 | 41 | 31 | 45 | 76 | P39781 N0C | 1 |
| 15 | 41 | 10 | 27 | 45 | 31 | 76 | P39782 N0C | 1 |
| 15 | 31 | 10 | 37 | 35 | 41 | 76 | P39783 N0C | 1 |
| 15 | 37 | 10 | 31 | 41 | 35 | 76 | P39784 N0C | 1 |
| 15 | 31 | 10 | 41 | 35 | 45 | 80 | P39821 N0C | 1 |
| 15 | 41 | 10 | 31 | 45 | 35 | 80 | P39822 N0C | 1 |
| 15 | 27 | 10 | 47 | 31 | 51 | 82 | P39841 N0C | 1 |
| 15 | 47 | 10 | 27 | 51 | 31 | 82 | P39842 N0C | 1 |
| 15 | 37 | 10 | 37 | 41 | 41 | 82 | P39843 N0C | 1 |
| 15 | 27 | 10 | 51 | 31 | 55 | 86 | P39881 N0C | 1 |
| 15 | 31 | 10 | 47 | 35 | 51 | 86 | P39882 N0C | 1 |
| 15 | 37 | 10 | 41 | 41 | 45 | 86 | P39883 N0C | 1 |
| 15 | 41 | 10 | 37 | 45 | 41 | 86 | P39884 N0C | 1 |
| 15 | 31 | 10 | 51 | 35 | 55 | 90 | P39921 N0C | 1 |
| 15 | 41 | 10 | 41 | 45 | 45 | 90 | P39922 N0C | 1 |
| 15 | 27 | 10 | 57 | 31 | 61 | 92 | P39941 N0C | 1 |
| 15 | 37 | 10 | 47 | 41 | 51 | 92 | P39942 N0C | 1 |
| 15 | 37 | 10 | 51 | 41 | 55 | 96 | P39981 N0C | 1 |
| 15 | 41 | 10 | 47 | 45 | 51 | 96 | P39982 N0C | 1 |
| 15 | 41 | 10 | 51 | 45 | 55 | 100 | P39020 N0C | 1 |
| 15 | 27 | 10 | 67 | 31 | 71 | 102 | P39041 N0C | 1 |
| 15 | 37 | 10 | 57 | 41 | 61 | 102 | P39042 N0C | 1 |
| 15 | 47 | 10 | 47 | 51 | 51 | 102 | P39043 N0C | 1 |
| 15 | 27 | 10 | 77 | 31 | 81 | 112 | P39141 N0C | 1 |
| 15 | 37 | 10 | 67 | 41 | 71 | 112 | P39142 N0C | 1 |
| 15 | 47 | 10 | 57 | 51 | 61 | 112 | P39143 N0C | 1 |

con 5 chiavi with 5 keys

..... N5C

CILINDRI DI SICUREZZA DA INFILARE
 security mortice cylinders





Doppio cilindro MODULARE con taglio
MODULAR double cylinder with cut



HSP

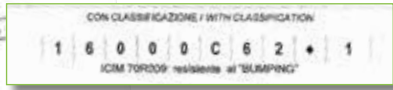
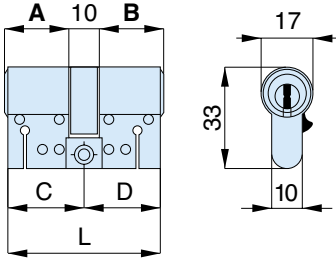

Cilindro valutato in base alla norma Europea EN 1303:05
Cylinder measured by means of the EN 1303:05 standard

| ↓ | A | B | C | D | L | codice code | euro | 📄 |
|----|----|----|----|----|----|----------------|------------|---|
| 15 | 27 | 10 | 27 | 31 | 31 | 62 | P43640 N00 | 1 |
| 15 | 27 | 10 | 31 | 31 | 35 | 66 | P43680 N00 | 1 |
| 15 | 31 | 10 | 31 | 35 | 35 | 70 | P43720 N00 | 1 |
| 15 | 27 | 10 | 37 | 31 | 41 | 72 | P43740 N00 | 1 |
| 15 | 27 | 10 | 41 | 31 | 45 | 76 | P43781 N00 | 1 |
| 15 | 31 | 10 | 37 | 35 | 41 | 76 | P43782 N00 | 1 |
| 15 | 31 | 10 | 41 | 35 | 45 | 80 | P43820 N00 | 1 |
| 15 | 27 | 10 | 47 | 31 | 51 | 82 | P43841 N00 | 1 |
| 15 | 37 | 10 | 37 | 41 | 41 | 82 | P43842 N00 | 1 |
| 15 | 27 | 10 | 51 | 31 | 55 | 86 | P43881 N00 | 1 |
| 15 | 31 | 10 | 47 | 35 | 51 | 86 | P43882 N00 | 1 |
| 15 | 37 | 10 | 41 | 41 | 45 | 86 | P43883 N00 | 1 |
| 15 | 31 | 10 | 51 | 35 | 55 | 90 | P43921 N00 | 1 |
| 15 | 41 | 10 | 41 | 45 | 45 | 90 | P43922 N00 | 1 |
| 15 | 27 | 10 | 57 | 31 | 61 | 92 | P43941 N00 | 1 |
| 15 | 37 | 10 | 47 | 41 | 51 | 92 | P43942 N00 | 1 |
| 15 | 37 | 10 | 51 | 41 | 55 | 96 | P43981 N00 | 1 |
| 15 | 41 | 10 | 47 | 45 | 51 | 96 | P43982 N00 | 1 |
| 15 | 31 | 10 | 57 | 35 | 61 | 96 | P43983 N00 | 1 |
| 15 | 41 | 10 | 51 | 45 | 55 | 100 | P43020 N00 | 1 |
| 15 | 27 | 10 | 67 | 31 | 71 | 102 | P43041 N00 | 1 |
| 15 | 37 | 10 | 57 | 41 | 61 | 102 | P43042 N00 | 1 |
| 15 | 47 | 10 | 47 | 51 | 51 | 102 | P43043 N00 | 1 |
| 15 | 27 | 10 | 77 | 31 | 81 | 112 | P43141 N00 | 1 |
| 15 | 37 | 10 | 67 | 41 | 71 | 112 | P43142 N00 | 1 |
| 15 | 47 | 10 | 57 | 51 | 61 | 112 | P43143 N00 | 1 |
| 15 | 47 | 10 | 67 | 51 | 71 | 122 | P43243 N00 | 1 |

con 5 chiavi with 5 keys

..... N50

frizionato frictioned

..... NOX

Con la versione modulare si possono produrre cilindri fino alla lunghezza totale di 212 mm. (121-91)
With the modular version, it's possible to realize cylinders till the following total length: 212 mm (121-91)

Mezzo cilindro MODULARE con taglio e camma regolabile in 8 posizioni
MODULAR half cylinder with cut and adjustable cam in 8 positions



HSP

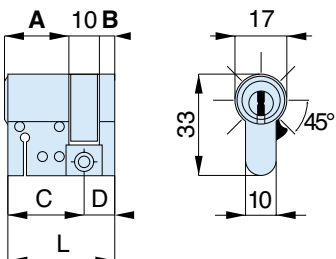

| ↓ | A | B | C | D | L | codice code | euro | 📄 |
|----|----|----|---|----|----|----------------|------------|---|
| 15 | 27 | 10 | 5 | 31 | 10 | 41 | P44420 N00 | 1 |
| 15 | 31 | 10 | 5 | 35 | 10 | 45 | P44460 N00 | 1 |
| 15 | 37 | 10 | 5 | 41 | 10 | 51 | P44520 N00 | 1 |
| 15 | 41 | 10 | 5 | 45 | 10 | 55 | P44560 N00 | 1 |
| 15 | 47 | 10 | 5 | 51 | 10 | 61 | P44620 N00 | 1 |
| 15 | 57 | 10 | 5 | 61 | 10 | 71 | P44720 N00 | 1 |
| 15 | 67 | 10 | 5 | 71 | 10 | 81 | P44820 N00 | 1 |
| 15 | 77 | 10 | 5 | 81 | 10 | 91 | P44920 N00 | 1 |

con 5 chiavi with 5 keys

..... N50

Doppio cilindro MODULARE con pomolo ottone nichelato opaco con taglio
 MODULAR double cylinder with matt nickel-plated brass knob with cut

HSP

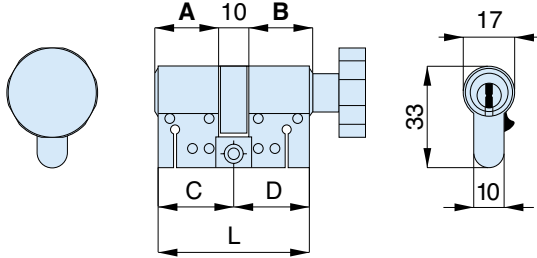

| ▽ | A | B | C | D | L | codice code | euro | |
|----|----|----|----|----|----|----------------|------------|---|
| 15 | 27 | 10 | 27 | 31 | 31 | 62 | P49640 NOR | 1 |
| 15 | 27 | 10 | 31 | 31 | 35 | 66 | P49681 NOR | 1 |
| 15 | 31 | 10 | 27 | 35 | 31 | 66 | P49682 NOR | 1 |
| 15 | 31 | 10 | 31 | 35 | 35 | 70 | P49720 NOR | 1 |
| 15 | 27 | 10 | 37 | 31 | 41 | 72 | P49741 NOR | 1 |
| 15 | 37 | 10 | 27 | 41 | 31 | 72 | P49742 NOR | 1 |
| 15 | 27 | 10 | 41 | 31 | 45 | 76 | P49781 NOR | 1 |
| 15 | 41 | 10 | 27 | 45 | 31 | 76 | P49782 NOR | 1 |
| 15 | 31 | 10 | 37 | 35 | 41 | 76 | P49783 NOR | 1 |
| 15 | 37 | 10 | 31 | 41 | 35 | 76 | P49784 NOR | 1 |
| 15 | 31 | 10 | 41 | 35 | 45 | 80 | P49821 NOR | 1 |
| 15 | 41 | 10 | 31 | 45 | 35 | 80 | P49822 NOR | 1 |
| 15 | 27 | 10 | 47 | 31 | 51 | 82 | P49841 NOR | 1 |
| 15 | 47 | 10 | 27 | 51 | 31 | 82 | P49842 NOR | 1 |
| 15 | 37 | 10 | 37 | 41 | 41 | 82 | P49843 NOR | 1 |
| 15 | 27 | 10 | 51 | 31 | 55 | 86 | P49881 NOR | 1 |
| 15 | 31 | 10 | 47 | 35 | 51 | 86 | P49882 NOR | 1 |
| 15 | 37 | 10 | 41 | 41 | 45 | 86 | P49883 NOR | 1 |
| 15 | 41 | 10 | 37 | 45 | 41 | 86 | P49884 NOR | 1 |
| 15 | 31 | 10 | 51 | 35 | 55 | 90 | P49921 NOR | 1 |
| 15 | 41 | 10 | 41 | 45 | 45 | 90 | P49922 NOR | 1 |
| 15 | 27 | 10 | 57 | 31 | 61 | 92 | P49941 NOR | 1 |
| 15 | 37 | 10 | 47 | 41 | 51 | 92 | P49942 NOR | 1 |
| 15 | 37 | 10 | 51 | 41 | 55 | 96 | P49981 NOR | 1 |
| 15 | 41 | 10 | 47 | 45 | 51 | 96 | P49982 NOR | 1 |
| 15 | 41 | 10 | 51 | 45 | 55 | 100 | P49020 NOR | 1 |
| 15 | 27 | 10 | 67 | 31 | 71 | 102 | P49041 NOR | 1 |
| 15 | 37 | 10 | 57 | 41 | 61 | 102 | P49042 NOR | 1 |
| 15 | 47 | 10 | 47 | 51 | 51 | 102 | P49043 NOR | 1 |
| 15 | 27 | 10 | 77 | 31 | 81 | 112 | P49141 NOR | 1 |
| 15 | 37 | 10 | 67 | 41 | 71 | 112 | P49142 NOR | 1 |
| 15 | 47 | 10 | 57 | 51 | 61 | 112 | P49143 NOR | 1 |

con 5 chiavi with 5 keys

..... N5R

CILINDRI DI SICUREZZA DA INFILARE
 security mortice cylinders



Doppio cilindro MODULARE con pomolo ottone nichelato opaco con taglio
MODULAR double cylinder with matt nickel-plated brass knob with cut



HSP

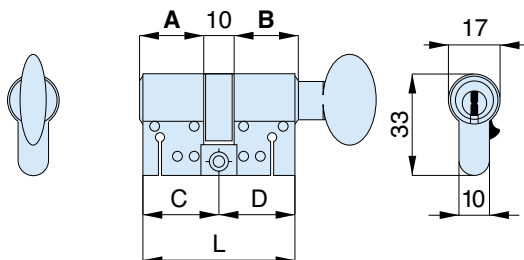

| | A | B | C | D | L | codice code | euro | | |
|----|----|----|----|----|----|----------------|--------|-----|---|
| 15 | 27 | 10 | 27 | 31 | 31 | 62 | P49640 | N0F | 1 |
| 15 | 27 | 10 | 31 | 31 | 35 | 66 | P49681 | N0F | 1 |
| 15 | 31 | 10 | 27 | 35 | 31 | 66 | P49682 | N0F | 1 |
| 15 | 31 | 10 | 31 | 35 | 35 | 70 | P49720 | N0F | 1 |
| 15 | 27 | 10 | 37 | 31 | 41 | 72 | P49741 | N0F | 1 |
| 15 | 37 | 10 | 27 | 41 | 31 | 72 | P49742 | N0F | 1 |
| 15 | 27 | 10 | 41 | 31 | 45 | 76 | P49781 | N0F | 1 |
| 15 | 41 | 10 | 27 | 45 | 31 | 76 | P49782 | N0F | 1 |
| 15 | 31 | 10 | 37 | 35 | 41 | 76 | P49783 | N0F | 1 |
| 15 | 37 | 10 | 31 | 41 | 35 | 76 | P49784 | N0F | 1 |
| 15 | 31 | 10 | 41 | 35 | 45 | 80 | P49821 | N0F | 1 |
| 15 | 41 | 10 | 31 | 45 | 35 | 80 | P49822 | N0F | 1 |
| 15 | 27 | 10 | 47 | 31 | 51 | 82 | P49841 | N0F | 1 |
| 15 | 47 | 10 | 27 | 51 | 31 | 82 | P49842 | N0F | 1 |
| 15 | 37 | 10 | 37 | 41 | 41 | 82 | P49843 | N0F | 1 |
| 15 | 27 | 10 | 51 | 31 | 55 | 86 | P49881 | N0F | 1 |
| 15 | 31 | 10 | 47 | 35 | 51 | 86 | P49882 | N0F | 1 |
| 15 | 37 | 10 | 41 | 41 | 45 | 86 | P49883 | N0F | 1 |
| 15 | 41 | 10 | 37 | 45 | 41 | 86 | P49884 | N0F | 1 |
| 15 | 31 | 10 | 51 | 35 | 55 | 90 | P49921 | N0F | 1 |
| 15 | 41 | 10 | 41 | 45 | 45 | 90 | P49922 | N0F | 1 |
| 15 | 27 | 10 | 57 | 31 | 61 | 92 | P49941 | N0F | 1 |
| 15 | 37 | 10 | 47 | 41 | 51 | 92 | P49942 | N0F | 1 |
| 15 | 37 | 10 | 51 | 41 | 55 | 96 | P49981 | N0F | 1 |
| 15 | 41 | 10 | 47 | 45 | 51 | 96 | P49982 | N0F | 1 |
| 15 | 41 | 10 | 51 | 45 | 55 | 100 | P49020 | N0F | 1 |
| 15 | 27 | 10 | 67 | 31 | 71 | 102 | P49041 | N0F | 1 |
| 15 | 37 | 10 | 57 | 41 | 61 | 102 | P49042 | N0F | 1 |
| 15 | 47 | 10 | 47 | 51 | 51 | 102 | P49043 | N0F | 1 |
| 15 | 27 | 10 | 77 | 31 | 81 | 112 | P49141 | N0F | 1 |
| 15 | 37 | 10 | 67 | 41 | 71 | 112 | P49142 | N0F | 1 |
| 15 | 47 | 10 | 57 | 51 | 61 | 112 | P49143 | N0F | 1 |

con 5 chiavi with 5 keys

..... N5F

Doppio cilindro MODULARE predisposto pomolo con taglio
 MODULAR double cylinder with knob provision with cut



HSP

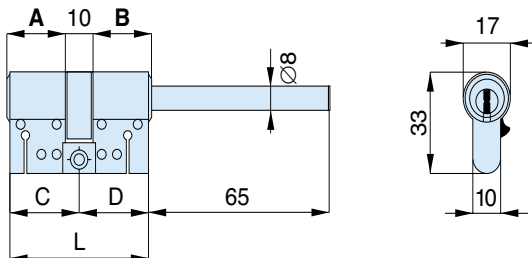

| ▽ | A | B | C | D | L | codice code | euro | | |
|----|----|----|----|----|----|-------------|--------|-----|---|
| 15 | 27 | 10 | 27 | 31 | 31 | 62 | P49640 | N0L | 1 |
| 15 | 31 | 10 | 27 | 35 | 31 | 66 | P49680 | N0L | 1 |
| 15 | 37 | 10 | 27 | 41 | 31 | 72 | P49740 | N0L | 1 |
| 15 | 41 | 10 | 27 | 45 | 31 | 76 | P49780 | N0L | 1 |
| 15 | 47 | 10 | 27 | 51 | 31 | 82 | P49840 | N0L | 1 |
| 15 | 51 | 10 | 27 | 55 | 31 | 86 | P49880 | N0L | 1 |
| 15 | 57 | 10 | 27 | 61 | 31 | 92 | P49940 | N0L | 1 |
| 15 | 67 | 10 | 27 | 71 | 31 | 102 | P49040 | N0L | 1 |
| 15 | 77 | 10 | 27 | 81 | 31 | 112 | P49140 | N0L | 1 |

con 5 chiavi with 5 keys

..... N5L

Doppio cilindro MODULARE predisposto pomolo con taglio
 MODULAR double cylinder with knob provision with cut

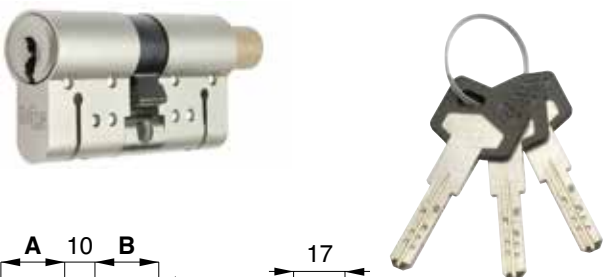

HSP

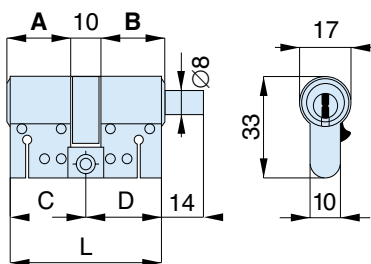

| ▽ | A | B | C | D | L | codice code | euro | | |
|----|----|----|----|----|----|-------------|--------|-----|---|
| 15 | 27 | 10 | 27 | 31 | 31 | 62 | P49640 | N0C | 1 |
| 15 | 27 | 10 | 31 | 31 | 35 | 66 | P49681 | N0C | 1 |
| 15 | 31 | 10 | 27 | 35 | 31 | 66 | P49682 | N0C | 1 |
| 15 | 31 | 10 | 31 | 35 | 35 | 70 | P49720 | N0C | 1 |
| 15 | 27 | 10 | 37 | 31 | 41 | 72 | P49741 | N0C | 1 |
| 15 | 37 | 10 | 27 | 41 | 31 | 72 | P49742 | N0C | 1 |
| 15 | 27 | 10 | 41 | 31 | 45 | 76 | P49781 | N0C | 1 |
| 15 | 41 | 10 | 27 | 45 | 31 | 76 | P49782 | N0C | 1 |
| 15 | 31 | 10 | 37 | 35 | 41 | 76 | P49783 | N0C | 1 |
| 15 | 37 | 10 | 31 | 41 | 35 | 76 | P49784 | N0C | 1 |
| 15 | 31 | 10 | 41 | 35 | 45 | 80 | P49821 | N0C | 1 |
| 15 | 41 | 10 | 31 | 45 | 35 | 80 | P49822 | N0C | 1 |
| 15 | 27 | 10 | 47 | 31 | 51 | 82 | P49841 | N0C | 1 |
| 15 | 47 | 10 | 27 | 51 | 31 | 82 | P49842 | N0C | 1 |
| 15 | 37 | 10 | 37 | 41 | 41 | 82 | P49843 | N0C | 1 |
| 15 | 27 | 10 | 51 | 31 | 55 | 86 | P49881 | N0C | 1 |
| 15 | 31 | 10 | 47 | 35 | 51 | 86 | P49882 | N0C | 1 |
| 15 | 37 | 10 | 41 | 41 | 45 | 86 | P49883 | N0C | 1 |
| 15 | 41 | 10 | 37 | 45 | 41 | 86 | P49884 | N0C | 1 |
| 15 | 31 | 10 | 51 | 35 | 55 | 90 | P49921 | N0C | 1 |
| 15 | 41 | 10 | 41 | 45 | 45 | 90 | P49922 | N0C | 1 |
| 15 | 27 | 10 | 57 | 31 | 61 | 92 | P49941 | N0C | 1 |
| 15 | 37 | 10 | 47 | 41 | 51 | 92 | P49942 | N0C | 1 |
| 15 | 37 | 10 | 51 | 41 | 55 | 96 | P49981 | N0C | 1 |
| 15 | 41 | 10 | 47 | 45 | 51 | 96 | P49982 | N0C | 1 |
| 15 | 41 | 10 | 51 | 45 | 55 | 100 | P49020 | N0C | 1 |
| 15 | 27 | 10 | 67 | 31 | 71 | 102 | P49041 | N0C | 1 |
| 15 | 37 | 10 | 57 | 41 | 61 | 102 | P49042 | N0C | 1 |
| 15 | 47 | 10 | 47 | 51 | 51 | 102 | P49043 | N0C | 1 |
| 15 | 27 | 10 | 77 | 31 | 81 | 112 | P49141 | N0C | 1 |
| 15 | 37 | 10 | 67 | 41 | 71 | 112 | P49142 | N0C | 1 |
| 15 | 47 | 10 | 57 | 51 | 61 | 112 | P49143 | N0C | 1 |

con 5 chiavi with 5 keys

..... N5C

CILINDRI DI SICUREZZA DA INFILARE
 security mortice cylinders





Doppio cilindro ovale
Double oval cylinder



HSP

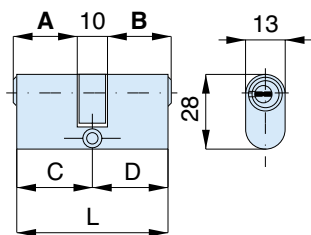

Per cilindri P18 sono previsti solo impianti a chiave uguale
For the cylinders P18 are foreseen just key alike systems

| | A | B | C | D | L | codice code | euro | | | |
|---|----|----|----|----|----|-------------|-------------------|------------|---|--|
| 5 | 27 | 10 | 27 | 31 | 31 | 62 | P18640 N00 | | 1 | |
| | | | | | | | | N50 | | |

con 5 chiavi with 5 keys

Doppio cilindro Ø 26
Double cylinder Ø 26



HSP

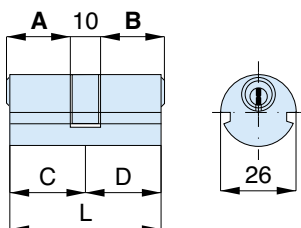

| | A | B | C | D | L | codice code | euro | | | |
|----|----|----|----|----|----|-------------|-------------------|------------|---|--|
| 15 | 27 | 10 | 27 | 31 | 31 | 62 | P19640 N00 | | 1 | |
| 15 | 27 | 10 | 47 | 31 | 51 | 82 | P19841 N00 | | 1 | |
| | | | | | | | | N50 | | |

con 5 chiavi with 5 keys

Doppio cilindro Ø 22
Double cylinder Ø 22



HSP

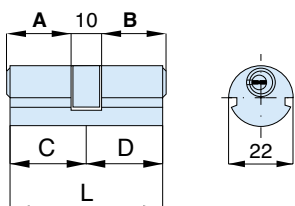

| | A | B | C | D | L | codice code | euro | | | |
|---|----|----|----|----|----|-------------|-------------------|------------|---|--|
| 5 | 27 | 10 | 27 | 31 | 31 | 62 | P20640 N00 | | 1 | |
| | | | | | | | | N50 | | |

con 5 chiavi with 5 keys

Per cilindri P20 sono previsti solo impianti a chiave uguale
For the cylinders P20 are foreseen just key alike systems

Pomolo piatto foro Ø 8 - ottone
Flat knob hole Ø 8 - brass

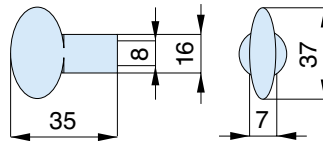

| finiture finishing | codice code | euro |   |
|--|-------------------|------|---|
| Ottone lucido Polished brass | OTS079/8 L | 10 | |
| Nickel opaco Matt nickel | OTS079/8 N | 10 | |
| Cromo lucido Polished chrome | OTS079/8 C | 10 | |
| Cromo satinato Satin chrome | OTS079/8 S | 10 | |
| Bronzato Bronzed | OTS079/8 B | 10 | |

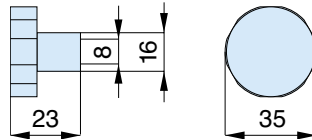

Pomolo foro Ø 8 - ottone
Knob hole Ø 8 - brass

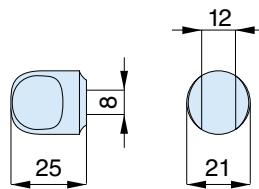

| finiture finishing | codice code | euro |   |
|--|-------------------|------|---|
| Ottone lucido Polished brass | OTS080/8 L | 10 | |
| Nickel opaco Matt nickel | OTS080/8 N | 10 | |
| Cromo lucido Polished chrome | OTS080/8 C | 10 | |
| Cromo satinato Satin chrome | OTS080/8 S | 10 | |
| Bronzato Bronzed | OTS080/8 B | 10 | |

Pomolo foro Ø 8 - ottone
Knob hole Ø 8 - brass



| finiture finishing | codice code | euro |   |
|--|-------------------|------|---|
| Ottone lucido Polished brass | OTS082/8 L | 10 | |
| Nickel opaco Matt nickel | OTS082/8 N | 10 | |



POMOLI
knobs

- LUCCHETTO AD ARCO
PADLOCK WITH SHACKLE



P. 68

- LUCCHETTO DI SICUREZZA
SECURITY PADLOCK



P. 69



Lucchetto per MEZZO CILINDRO a PROFILO EUROPEO
Padlock for HALF EUROPEAN CYLINDER

- corpo in ottone
- brass body
- arco in acciaio temprato
- hardened steel shackle

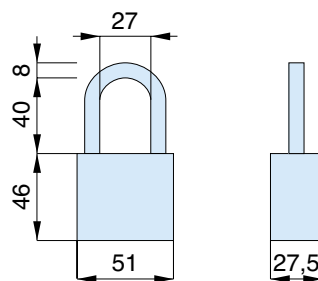

| | | | | |
|---|--------------------|------|--|---|
| senza mezzo cilindro without half cylinder | codice code ENT | euro | | |
| | 090080 080 | | | 1 |



| | | | | |
|---|--------------------|------|--|---|
| con cilindro with cylinder 017.42.0 | codice code ENT | euro | | |
| | 090000 000 | | | 1 |



X8

| | | | | |
|---|--------------------|------|--|---|
| con cilindro with cylinder X81.42.0 | codice code ENT | euro | | |
| | X90000 000 | | | 1 |
| con 5 chiavi with 5 keys | 050 | | | |



HS

| | | | | |
|---|--------------------|------|--|---|
| con cilindro with cylinder H24.42.0 | codice code ENT | euro | | |
| | H90000 000 | | | 1 |
| con 5 chiavi with 5 keys | 050 | | | |



HSP

| | | | | |
|---|--------------------|------|--|---|
| con cilindro with cylinder P24.42.0 | codice code ENT | euro | | |
| | P90000 000 | | | 1 |
| con 5 chiavi with 5 keys | 050 | | | |

Lucchetto di sicurezza

Security padlock

- corpo in acciaio carbonitrurato, finitura cromo
- carbonitured steel body, chrome finishing
- stelo e piastrino in acciaio carbonitrurato, finitura cromo
- stem and key-guide in carbonitured steel, chrome finishing

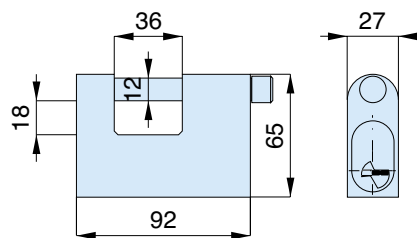

LUCCHETTI
padlocks



X8

| | | | |
|-------------------------------|--------------------|------|--|
| con cilindro with cylinder | codice code ENT | euro | |
| X81.27.0 | X92000 N | 1 | |
| con 5 chiavi with 5 keys | N50 | | |



HS

| | | | |
|-------------------------------|--------------------|------|--|
| con cilindro with cylinder | codice code ENT | euro | |
| H24.27.0 | H92000 N | 1 | |
| con 5 chiavi with 5 keys | N50 | | |



HSP

| | | | |
|-------------------------------|--------------------|------|--|
| con cilindro with cylinder | codice code ENT | euro | |
| P24.27.0 | P92000 N | 1 | |
| con 5 chiavi with 5 keys | N50 | | |

1. PREMESSA

- 1.1 Qualsiasi contratto tra MG Serrature S.p.A. (di seguito il "Venditore") ed il cliente ("Acquirente") avente sede nel territorio italiano ed avente ad oggetto la vendita di prodotti realizzati dal Venditore (di seguito i "Prodotti") sarà disciplinato dalle presenti Condizioni Generali di Vendita che sostituiscono le precedenti condizioni generali di vendita del Venditore, nonché tutti i precedenti accordi fra il Venditore l'Acquirente.
- 1.2 Ciascun contratto di vendita s'intenderà perfezionato con la ricezione da parte del Venditore della propria conferma d'ordine allegata alle presenti Condizioni, debitamente sottoscritte dall'Acquirente ovvero, qualora il Venditore non riceva tale documentazione, decorsi 15 giorni dall'invio da parte del Venditore della conferma d'ordine, a mezzo di raccomandata con ricevuta di ritorno, unitamente alle presenti Condizioni.

2. PREZZI

- 2.1 I prezzi dei Prodotti sono quelli indicati nel listino prezzi del Venditore vigente al momento dell'ordine e possono variare in qualsiasi momento a discrezione del Venditore. Tali prezzi si intendono al netto dell'IVA, di tasse, diritti doganali e qualsivoglia altro onere o imposta eventualmente gravante sui Prodotti nel paese dell'Acquirente.
- 2.2 Per ordini di importo inferiore ad euro 300,00 verranno addebitati all'Acquirente euro 15,00 per spese fisse.
- 2.3 Le spese di imballo ordinario sono comprese nel prezzo.

3. TERMINI DI PAGAMENTO

- 3.1 I termini di pagamento saranno decisi di volta in volta fra le parti. In caso di ritardo nel pagamento l'Acquirente sarà tenuto a pagare gli interessi moratori calcolati ai sensi dell'art. 5 del D.Lgs 9 ottobre 2002, n. 231.
- 3.2 Il Venditore si riserva il diritto di sospendere l'esecuzione di qualsiasi ordine o consegna in caso di ritardo dell'Acquirente nel pagamento.

4. CONSEGNA E PASSAGGIO DEL RISCHIO

- 4.1 Franco destino per spedizioni di valore superiore a euro 1.000,00 imponibile, con imprese di trasporto scelte dal Venditore.
Franco destino con addebito all'Acquirente delle spese di trasporto per spedizioni di valore inferiore a euro 1.000,00 imponibile, con imprese di trasporto scelte dal il Venditore.
In ogni caso, il rischio di perimento dei prodotti si trasferisce in capo all'Acquirente con la consegna dei Prodotti al vettore incaricato del trasporto dal Venditore.
- 4.2 I termini di consegna indicati nell'ordine e/o conferme d'ordine si intendono puramente indicativi. In ogni caso, il Venditore non sarà considerato in alcun modo responsabile in ipotesi di ritardo nella consegna dovuto a cause di forza maggiore come incendi, scioperi, atti della pubblica autorità, ritardi dei mezzi di trasporto pubblici o qualsiasi evento che non possa essere ragionevolmente previsto od al quale non sia possibile rimediare con l'ordinaria diligenza.

5. RECLAMI

- 5.1 L'Acquirente dovrà informare per iscritto il Venditore di eventuali vizi apparenti rilevabili dall'esame esteriore dei Prodotti o dei relativi imballaggi, mediante lettera raccomandata R/R, a pena di decadenza entro 10 giorni lavorativi dalla data di ricevimento dei Prodotti stessi.
- 5.2 I reclami relativi a difetti dei Prodotti non individuabili mediante un diligente controllo al momento del ricevimento (vizi occulti), dovranno essere comunicati al Venditore, mediante lettera raccomandata R/R, a pena di decadenza entro 10 giorni lavorativi dalla data della scoperta.
- 5.3 Qualora l'Acquirente abbia presentato tempestivo reclamo, la garanzia del Venditore si limiterà alla sostituzione dei Prodotti difettosi o non conformi alle specifiche tecniche riportate nel Listino Prezzi del Venditore ovvero consegnate all'Acquirente unitamente ai Prodotti stessi, previa restituzione dei Prodotti difettosi o non conformi al Venditore stesso. I costi ed i rischi di trasporto, di rimozione e di installazione dei Prodotti, così come qualsiasi altro costo indirettamente correlato alla riparazione di questi, non sono coperti da garanzia e restano a carico dell'Acquirente.
- 5.4 In pendenza di un reclamo, l'Acquirente non avrà diritto di sospendere o comunque ritardare i pagamenti dei Prodotti oggetto di contestazione. La denuncia di un vizio, a prescindere dalla sua natura apparente od occulta, non costituisce inadempimento di notevole importanza ai sensi dell'art. 1455 cod. civ..

6. GARANZIA

- 6.1 Il Venditore garantisce all'Acquirente per la durata di un (1) anno, decorrente dalla data di emissione della fattura, che i Prodotti forniti sono conformi alle specifiche tecniche indicate nel Listino Prezzi del Venditore ovvero consegnate all'Acquirente unitamente ai Prodotti stessi.
- 6.2 La garanzia sarà esclusa in caso di (i) uso dei Prodotti non conforme alle specifiche tecniche; (ii) danni derivati ai Prodotti per fatto non imputabile direttamente al Venditore; (iii) trasporto o stoccaggio dei Prodotti effettuato a cura dell'Acquirente con mezzi inadeguati; (iv) manomissione dei Prodotti; (v) danni causati da installazione impropria.
- 6.3 Qualora l'Acquirente abbia subito una perdita o un danno a causa di Prodotti viziati o non conformi a quanto concordato, la responsabilità del Venditore non potrà eccedere il valore dei Prodotti al momento della vendita.
- 6.4 Il Venditore non potrà essere ritenuto responsabile di perdite o danni subiti dall'Acquirente conseguentemente a cancellazioni di ordini da parte dei propri clienti, ritardate consegne ai clienti, nonché per qualsivoglia altro danno inerente ai rapporti dell'Acquirente con i propri clienti.
- 6.5 Il Venditore non potrà altresì essere ritenuto responsabile di perdite o danni subiti dall'Acquirente in conseguenza di diritti esercitati da propri clienti sulla base delle norme a tutela dei consumatori in materia di garanzia di conformità dei Prodotti, restando inteso che all'Acquirente non sarà in ogni caso consentito l'esercizio nei confronti del Venditore dell'azione di regresso prevista dall'art. 131 del D.lgs 206/2005 oltre i termini garanzia di cui al presente articolo.

7. LEGGE APPLICABILE

- 7.1 Le presenti Condizioni Generali di Vendita sono disciplinate dalla legge Italiana.

8. RISOLUZIONE DELLE CONTROVERSIE

- 8.1 Qualsiasi controversia, a qualunque titolo connessa ai contratti di vendita e/o alle presenti Condizioni Generali, che dovesse insorgere tra le parti, sarà sottoposta al tentativo di conciliazione previsto dal Regolamento di Conciliazione della Camera Arbitrale di Milano.
- 8.2 Nel caso in cui il suddetto tentativo fallisca, la controversia sarà devoluta alla competenza esclusiva del Tribunale di Milano.

1. PREAMBLE

- 1.1 These Terms and Conditions of Sale shall apply to any sale transaction between MG Serrature S.p.A. (hereinafter the "Seller") and the customer (the "Buyer") located outside the territory of Italy and with regard to the sale of products manufactured by the Seller (the "Products"). These Terms and Conditions shall supersede all and any previous terms and conditions of sale of the Seller, as well as any other agreement between the Seller and the Buyer.

- 1.2 Each sale agreement shall be considered as agreed upon receipt by the Seller of his own order confirmation together with this Terms and Conditions, both duly executed by the Buyer or, if such a document is not received by the Seller, within 15 days from the date of dispatch by the Seller of the order confirmation together with this Terms and Conditions by return receipt registered mail.

2. PRICES

- 2.1 The prices of the Products are those indicated in the price list of the Seller in use at the date of the purchase order and may vary from time to time at Seller's discretion. Such prices shall not include VAT, taxes, custom taxes, as well as any other cost or expense that could be eventually applicable to the Products in the country of the Buyer.
- 2.2 An additional charge of euro 15,00 for fixed expenses shall be paid by the Buyer, should the order's amount be not in excess of euro 300,00.
- 2.3 The prices indicated in the price list of the Seller include the ordinary packaging of the Products for transportation.

3. PAYMENT TERMS

- 3.1 The payments terms shall be agreed upon each time between the Seller and the Buyer. Should the Buyer fail to pay within the due terms, the Buyer shall be bound to pay an interest calculated in accordance with the provisions of art. 5 of Italian Legislative Decree October 9, 2002, n. 231.
- 3.2 The Seller shall not be bound to execute any order or delivery, should the Buyer delay the payments.

4. DELIVERY AND TRANSFER OF RISK

- 4.1 Save a different agreement between the Seller and the Buyer, deliveries of the Products shall be made CPT (Incoterms 2000). The Seller shall pay the cost of carriage necessary to bring the Products to the agreed destination.
- 4.2 In any case, the Buyer shall bear all risks of loss or of damage to the Products from the time they have been delivered to the carrier appointed by the Seller.
- 4.3 The delivery date stated on the orders and/or orders confirmations is purely indicative. In any case, the Buyer shall not be held responsible in case of delay in delivering the Products due to force majeure causes such as fire, strike, acts of public authorities, or delays or default caused by public carriers or for any other action or event which cannot reasonably forecast and which cannot be overcome with the ordinary due diligence.

5. CLAIMS

- 5.1 The Buyer shall communicate in writing (by means of a registered letter with return receipt) to the Seller the defects detectable by an external survey of the Products or of its packages, within not later than 10 (ten) working days from the receipt of the Products.
- 5.2 The claims concerning those defects of the Products that are not detectable by a diligent survey at the time of the delivery (hidden defects) shall be communicated to the Seller through a registered letter with return receipt, within 10 (ten) working days from their discovery.
- 5.3 Should the Buyer timely make the claim, the Seller's guarantee shall be limited to the substitution of the Products defective or not consistent with the technical specifications provided for by the Seller's Price List or delivered to the Buyer together with the Products. Such a guarantee is conditional on the restitution of the defective or non consistent Products to the Seller. The costs and the risks of transportation, removal and installation of the Products or of the parts of the Products, as well as any other cost indirectly correlated to their reparation, shall be not covered by the warranty and be intended at Buyer's charge.
- 5.4 Pending a claim, the Buyer shall have no right to suspend or delay the payments of the Products. The complaint of a defect, both apparent and hidden, shall not represent an important contractual breach according to art. 1455 of Italian Civil Code. Any right of termination of the agreement by the Buyer shall be also excluded.

6. WARRANTY

- 6.1 The Seller warrants to the Buyer that the Products shall meet the technical specifications provided for by the Seller's Price List or delivered to the Buyer together with the Products for 1 year starting from the issuance of the invoice.
- 6.2 The warranty shall be excluded in case of (i) damages caused by an usage of the Products inconsistent with the technical specifications (ii) damages occurred to the Products due to a fact not directly ascribable to the Seller, (iii) transportation or stockpiling of the Products carried out by the Buyer by means to be considered as inadequate for the Seller, (iv) damages due to an improper keeping or maintenance of the Products, (v) damages due to an improper installation.
- 6.3 Should the Buyer incur in a loss or damage due to defective or non consistent Products, the Seller's liability shall not exceed the value of the defective Products at the date of their sale.
- 6.4 In particular, the Seller shall not be liable in case of loss or damage suffered by the Buyer for cancellation of clients' orders, penalties for delayed deliveries to clients, and for any other damage, penalty or reimbursement due in connection with the commercial relationship between the Buyer and its clients.
- 6.5 The Seller shall not be liable also in case of loss or damage suffered by the Buyer for end-users' claims in connection with defective Products, being understood that the Buyer hereby waives and shall not be entitled to exercise the right of recover vi-à-vis the Seller after the expiration of the term of the guarantee sets forth above.

7. GOVERNING LAW

- 7.1 These General Conditions shall be governed by the United Nations Convention On Contracts For The International Sale Of Goods (Vienna, 1980). In the event a specific matter is not regulated by said Convention, the law of the State of the Seller shall apply.

8. DISPUTE RESOLUTION

- 8.1 All disputes arising out of any sale agreement between the Seller and the Buyer, including any question regarding its existence, validity, interpretation or termination, shall be submitted to the mediation attempt provided by the mediation service of the Chamber of Arbitration of Milan.
- 8.2 If the attempt fails, the dispute shall be settled by arbitration under the Rules of the Chamber of National and International Arbitration of Milan. The Arbitral Tribunal shall consist of a sole arbitrator appointed pursuant to those Rules. The Arbitral Tribunal shall decide in accordance with the laws of Italy. The seat of the arbitration shall be Milan and the language shall be English.
Alternatively, if the attempt fails, the dispute shall be exclusively referred to the jurisdiction of the Court of Milan, Italy.

MG SERRATURE S.p.a.

Via Monte Rosa, 29/31 - 20824 Lazzate (MB)

Tel. +39 02 96720008 - 96320160 - Fax +39 02 96329155

e-mail vendite@mg serrature.it - www.mg serrature.it



ISO 9001:2008
Cert. n° 0922



ISO 14001:2004
Cert. n° 0428A