







- **CILINDRI DA APPLICARE**  
RIM CYLINDERS  P. 41
- **CILINDRI DA INFILARE CON RINFORZO E TAGLIO ANTITORSIONE BREVETTATO**  
MORTICE CYLINDERS WITH PATENTED REINFORCE AND CUT AGAINST BREAKING  P. 42
- **CILINDRI OVALI (SOLO 5 PERNI)**  
OVAL CYLINDERS (ONLY 5 PINS)  P. 45
- **CILINDRI Ø 26 (15 PERNI)**  
Ø 26 CYLINDERS (15 PINS)  P. 45
- **CILINDRI Ø 22 (SOLO 5 PERNI)**  
Ø 22 CYLINDERS (ONLY 5 PINS)  P. 45
- **COMPONENTI DI CIFRATURE**  
PER CILINDRI HS  
SPARE PARTS FOR HS CYLINDERS  P. 46

- ✓ **Sistema a 15 perni attivi**  
System with 15 active pins
- ✓ **Corpo in ottone nichelato**  
Nickel plated brass body
- ✓ **Perni antitrapano**  
Anti drilling steel pins
- ✓ **Taglio anti-rottura**  
Anti-breakage cut
- ✓ **Perni e controperni in acciaio inox**  
Stainless steel pins and top pins
- ✓ **Molle in acciaio inox**  
Stainless steel springs
- ✓ **Camma DIN 30° (cilindri da infilare)**  
DIN 30° cam (mortice cylinders)
- ✓ **3 chiavi reversibili in alpacca con impugnatura rivestita in plastica, collo lungo e numerazione a codice indiretto sulla testa**  
3 reversible keys in nickel silver with plastic-coated grip, long neck numbered on key head
- ✓ **Code card**  
Code card
- ✓ **Vite di fissaggio**  
Fixing screw



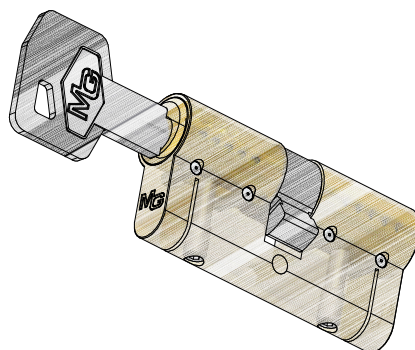

CILINDRI DI SICUREZZA DA APPLICARE  
security rim cylinders

Cilindro per art. 711  
Cylinder for art. 711

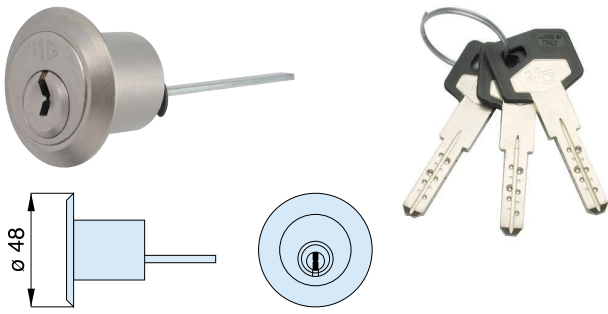

HS

15	A		B		C	D	L	codice	1
	code		code					H11000 N00	
con 5 chiavi with 5 keys								..... N50	

Cilindro per art. 712  
Cylinder for art. 712

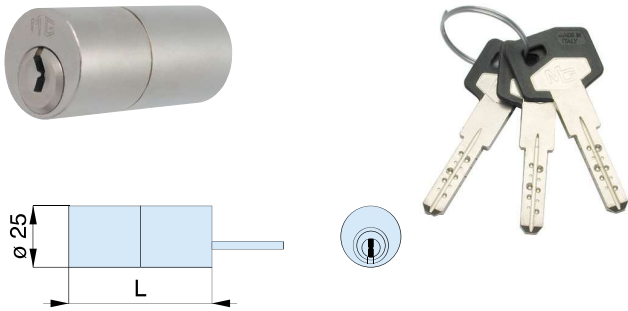

HS

15	A		B		C	D	L	codice	1
	code		code					H12500 N00	
con 5 chiavi with 5 keys								..... N50	

Coppia cilindri  
Double rim cylinders

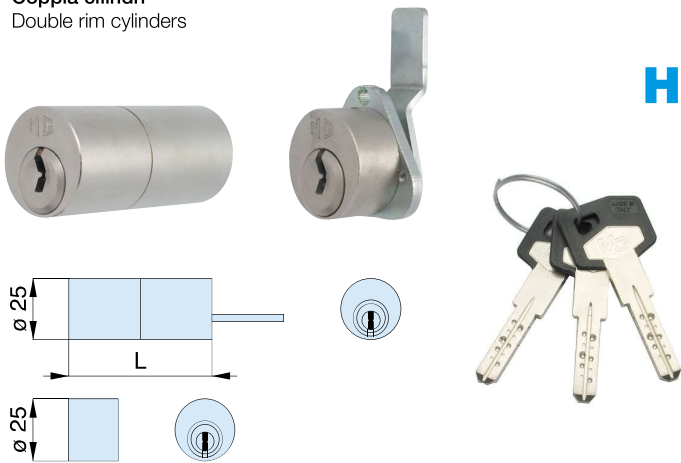

HS

15	A		B		C	D	L	codice	1
	code		code					H14500 N00	
con 5 chiavi with 5 keys								..... N50	

Coppia cilindri  
Double rim cylinders

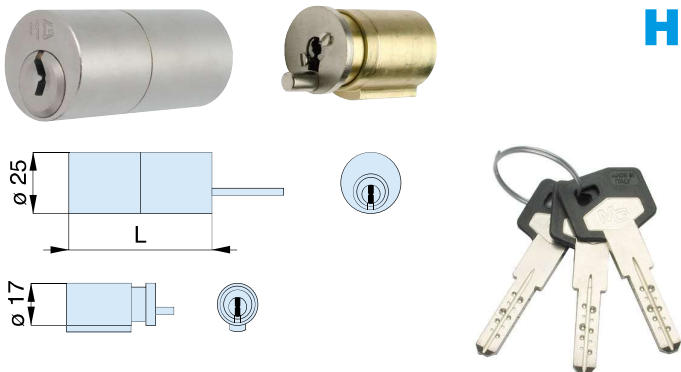

HS

15	A		B		C	D	L	codice	1
	code		code					H14501 N00	
con 5 chiavi with 5 keys								..... N50	



**Doppio cilindro**  
Double cylinder



HS

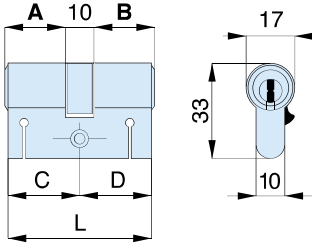

↓	A	B	C	D	L	codice code	📄 📄	
15	27	10	27	31	31	62	H33640 N00	1
15	27	10	31	31	35	66	H33680 N00	1
15	31	10	31	35	35	70	H33720 N00	1
15	27	10	37	31	41	72	H33740 N00	1
15	27	10	41	31	45	76	H33781 N00	1
15	31	10	37	35	41	76	H33782 N00	1
15	31	10	41	35	45	80	H33820 N00	1
15	27	10	47	31	51	82	H33841 N00	1
15	37	10	37	41	41	82	H33842 N00	1
15	27	10	51	31	55	86	H33881 N00	1
15	31	10	47	35	51	86	H33882 N00	1
15	37	10	41	41	45	86	H33883 N00	1
15	31	10	51	35	55	90	H33921 N00	1
15	41	10	41	45	45	90	H33922 N00	1
15	27	10	57	31	61	92	H33941 N00	1
15	37	10	47	41	51	92	H33942 N00	1
15	37	10	51	41	55	96	H33981 N00	1
15	41	10	47	45	51	96	H33982 N00	1
15	31	10	57	35	61	96	H33983 N00	1
15	41	10	51	45	55	100	H33020 N00	1
15	27	10	67	31	71	102	H33041 N00	1
15	37	10	57	41	61	102	H33042 N00	1
15	47	10	47	51	51	102	H33043 N00	1
15	37	10	67	41	71	112	H33142 N00	1
15	47	10	57	51	61	112	H33143 N00	1
15	47	10	67	51	71	122	H33243 N00	1

con 5 chiavi with 5 keys ..... N50  
frizionato frictioned ..... NOX

**Mezzo cilindro e camma regolabile in 8 posizioni**  
Half cylinder and adjustable cam in 8 position



HS

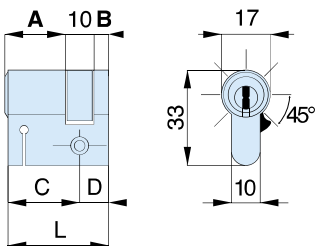

↓	A	B	C	D	L	codice code	📄 📄	
15	27	10	5	31	10	41	H34420 N00	1
15	31	10	5	35	10	45	H34460 N00	1
15	37	10	5	41	10	51	H34520 N00	1
15	41	10	5	45	10	55	H34560 N00	1
15	47	10	5	51	10	61	H34620 N00	1
15	57	10	5	61	10	71	H34720 N00	1
15	67	10	5	71	10	81	H34820 N00	1

con 5 chiavi with 5 keys ..... N50

**Doppio cilindro con pomolo ottone nichelato opaco**  
 Double cylinder with matt nickel-plated brass knob



**HS**

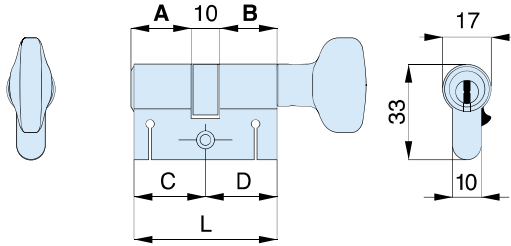

Shield	A	B	C	D	L	codice code	Icon	
15	27	10	27	31	31	62	H39640 N0F	1
15	27	10	31	31	35	66	H39681 N0F	1
15	31	10	27	35	31	66	H39682 N0F	1
15	31	10	31	35	35	70	H39720 N0F	1
15	27	10	37	31	41	72	H39741 N0F	1
15	37	10	27	41	31	72	H39742 N0F	1
15	27	10	41	31	45	76	H39781 N0F	1
15	41	10	27	45	31	76	H39782 N0F	1
15	31	10	37	35	41	76	H39783 N0F	1
15	37	10	31	41	35	76	H39784 N0F	1
15	31	10	41	35	45	80	H39821 N0F	1
15	41	10	31	45	35	80	H39822 N0F	1
15	27	10	47	31	51	82	H39841 N0F	1
15	47	10	27	51	31	82	H39842 N0F	1
15	37	10	37	41	41	82	H39843 N0F	1
15	27	10	51	31	55	86	H39881 N0F	1
15	31	10	47	35	51	86	H39882 N0F	1
15	37	10	41	41	45	86	H39883 N0F	1
15	41	10	37	45	41	86	H39884 N0F	1
15	31	10	51	35	55	90	H39921 N0F	1
15	41	10	41	45	45	90	H39922 N0F	1
15	27	10	57	31	61	92	H39941 N0F	1
15	37	10	47	41	51	92	H39942 N0F	1
15	37	10	51	41	55	96	H39981 N0F	1
15	41	10	47	45	51	96	H39982 N0F	1
15	41	10	51	45	55	100	H39020 N0F	1
15	27	10	67	31	71	102	H39041 N0F	1
15	37	10	57	41	61	102	H39042 N0F	1
15	47	10	47	51	51	102	H39043 N0F	1
15	37	10	67	41	71	112	H39142 N0F	1
15	47	10	57	51	61	112	H39143 N0F	1

con 5 chiavi with 5 keys ..... N5F

**CILINDRI DI SICUREZZA DA INFILARE**  
 security mortice cylinders

**Mezzo cilindro per lucchetto di sicurezza H92 - nickel opaco**  
 Half cylinder for security padlock H92 - matt nickel



**HS**

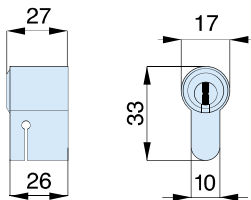

Shield	A	B	C	D	L	codice code	Icon
15						H34270 N00	1

con 5 chiavi with 5 keys ..... N50



**Doppio cilindro predisposto pomolo**  
Double cylinder with knob provision



HS

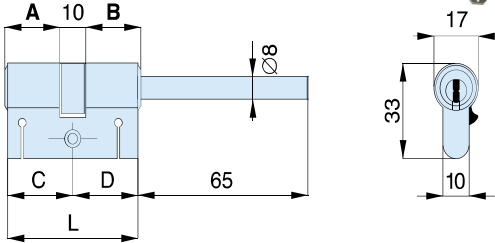

↓	A	B	C	D	L	codice code	📄	
15	27	10	27	31	31	62	H39640 NOL	1
15	31	10	27	35	31	66	H39680 NOL	1
15	37	10	27	41	31	72	H39740 NOL	1
15	41	10	27	45	31	76	H39780 NOL	1
15	47	10	27	51	31	82	H39840 NOL	1
15	51	10	27	55	31	86	H39880 NOL	1
15	57	10	27	61	31	92	H39940 NOL	1
15	67	10	27	71	31	102	H39040 NOL	1

con 5 chiavi with 5 keys

..... N5L

**Doppio cilindro predisposto pomolo**  
Double cylinder with knob provision



HS

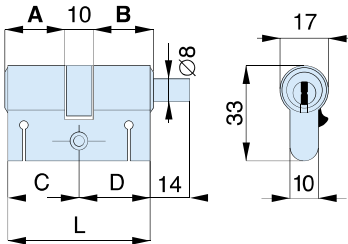

↓	A	B	C	D	L	codice code	📄	
15	27	10	27	31	31	62	H39640 NOC	1
15	27	10	31	31	35	66	H39681 NOC	1
15	31	10	27	35	31	66	H39682 NOC	1
15	31	10	31	35	35	70	H39720 NOC	1
15	27	10	37	31	41	72	H39741 NOC	1
15	37	10	27	41	31	72	H39742 NOC	1
15	27	10	41	31	45	76	H39781 NOC	1
15	41	10	27	45	31	76	H39782 NOC	1
15	31	10	37	35	41	76	H39783 NOC	1
15	37	10	31	41	35	76	H39784 NOC	1
15	31	10	41	35	45	80	H39821 NOC	1
15	41	10	31	45	35	80	H39822 NOC	1
15	27	10	47	31	51	82	H39841 NOC	1
15	47	10	27	51	31	82	H39842 NOC	1
15	37	10	37	41	41	82	H39843 NOC	1
15	27	10	51	31	55	86	H39881 NOC	1
15	31	10	47	35	51	86	H39882 NOC	1
15	37	10	41	41	45	86	H39883 NOC	1
15	41	10	37	45	41	86	H39884 NOC	1
15	31	10	51	35	55	90	H39921 NOC	1
15	41	10	41	45	45	90	H39922 NOC	1
15	27	10	57	31	61	92	H39941 NOC	1
15	37	10	47	41	51	92	H39942 NOC	1
15	37	10	51	41	55	96	H39981 NOC	1
15	41	10	47	45	51	96	H39982 NOC	1
15	41	10	51	45	55	100	H39020 NOC	1
15	27	10	67	31	71	102	H39041 NOC	1
15	37	10	57	41	61	102	H39042 NOC	1
15	47	10	47	51	51	102	H39043 NOC	1
15	37	10	67	41	71	112	H39142 NOC	1
15	47	10	57	51	61	112	H39143 NOC	1

con 5 chiavi with 5 keys

..... N5C



**Doppio cilindro ovale**  
Double oval cylinder



**HS**

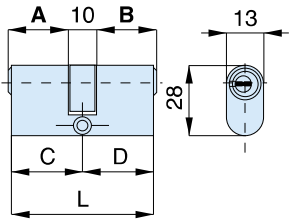

Per cilindri H18 sono previsti solo impianti a chiave uguale  
For the cylinders H18 only key-alike systems are available

	A	B	C	D	L	codice code		
5	27	10	27	31	31	62	<b>H18640 N00</b>	1
	con 5 chiavi with 5 keys					.....	N50	

**Doppio cilindro Ø 26**  
Double cylinder Ø 26



**HS**

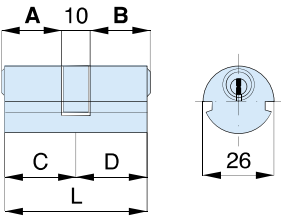

	A	B	C	D	L	codice code		
15	27	10	27	31	31	62	<b>H19640 N00</b>	1
15	27	10	47	31	51	82	<b>H19841 N00</b>	1
	con 5 chiavi with 5 keys					.....	N50	

**Doppio cilindro Ø 22**  
Double cylinder Ø 22



**HS**

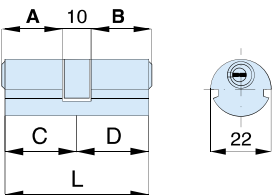

	A	B	C	D	L	codice code		
5	27	10	27	31	31	62	<b>H20640 N00</b>	1
	con 5 chiavi with 5 keys					.....	N50	

Per cilindri H20 sono previsti solo impianti a chiave uguale  
For the cylinders H20 only key-alike systems are available



**Caricatore per cifrature cilindri HS**  
Cylinder pinning tool for cylinders HS



codice code			
ATT00	1		1

**Attrezzo premi molle per cilindri HS**  
Pressing springs tool for cylinders HS



codice code			
ATT00	2		1

**Bussola per cilindri HS**  
Chamber for cylinders HS



codice code			
ATT00	3		2

**Spintore per cilindri HS**  
Spintore per cilindri HS



codice code			
ATT00	4		1

**Controperni in acciaio inox per cilindri HS e HSP2**  
Stainless steel top pins for cylinders HS and HSP2



SPN2514



SPN2514/2

Ø 2,5 x 1,4 per cilindro art. HS-HSP2

Ø 2,5 x 1,4 for cylinder art. HS-HSP2

codice code			
SPN25	14		500
SPN25	14/2		500

Ø 2,5 x 2 per cilindro art. HS-HSP2

Ø 2,5 x 2 for cylinder art. HS-HSP2

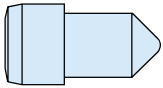
**Perni in acciaio temperato (5 lunghezze) per cilindri HS e HSP2**  
 Hardened steel pins (5 lengths) for cylinders HS and HSP2

	codice code	
<b>Ø 2,5 x 2,85 per cilindro art. HS-HSP2</b> Ø 2,5 x 2,85 for cylinder art. HS-HSP2	<b>SPN25 20/1</b>	100
<b>Ø 2,5 x 3,25 per cilindro art. HS-HSP2</b> Ø 2,5 x 3,25 for cylinder art. HS-HSP2	<b>SPN25 20/2</b>	100
<b>Ø 2,5 x 3,85 per cilindro art. HS-HSP2</b> Ø 2,5 x 3,85 for cylinder art. HS-HSP2	<b>SPN25 20/3</b>	100
<b>Ø 2,5 x 4,25 per cilindro art. HS-HSP2</b> Ø 2,5 x 4,25 for cylinder art. HS-HSP2	<b>SPN25 20/4</b>	100
<b>Ø 2,5 x 4,65 per cilindro art. HS-HSP2</b> Ø 2,5 x 4,65 for cylinder art. HS-HSP2	<b>SPN25 20/5</b>	100

**Molla pre-assemblata in acciaio inox per cilindri HS-HSP2 filo 0,13**  
 Stainless steel pre-assembled springs for cylinders HS-HSP2 filo 0,13

	codice code	
	<b>MOL00 9/13</b>	500

**Pinza per apertura anelli**  
 Pliers for rings opening

	codice code	
	<b>PNZ00 1</b>	1

**Pinza per chiusura anelli**  
 Plier for ring closing

	codice code	
<b>per cilindri art. 018-HS</b> for cylinders art. 018-HS	<b>PNZ01 8</b>	1

**Pastiglie per MK in acciaio inox per cilindri HS e HSP2**  
 Stainless steel pins for MK for cylinders HS and HSP2

	codice code	
<b>Ø 2,5 x 0,4 per cil. art. HS-HSP2 MK (pastiglia 1)</b> Ø 2,5 x 0,4 for cyl. art. HS-HSP2 MK (pin 1)	<b>SPN02 /1</b>	500
<b>Ø 2,5 x 0,8 per cil. art. HS-HSP2 MK (pastiglia 2)</b> Ø 2,5 x 0,8 for cyl. art. HS-HSP2 MK (pin 2)	<b>SPN02 /3</b>	500