

■ **CILINDRI DA APPLICARE**
RIM CYLINDERS



P. 51

■ **CILINDRI DA INFILARE CON RINFORZO E TAGLIO ANTITORSIONE BREVETTATO**
MORTICE CYLINDERS WITH PATENTED REINFORCE AND CUT AGAINST BREAKING



P. 52

■ **CILINDRI DA INFILARE MODULARI CON TAGLIO ANTITORSIONE BREVETTATO**
MODULAR MORTICE CYLINDERS WITH PATENTED CUT AGAINST BREAKING



P. 55

■ **CILINDRI OVALI (SOLO 5 PERNI)**
OVAL CYLINDERS (ONLY 5 PINS)



P. 58

■ **CILINDRI Ø 26 (15 PERNI)**
Ø 26 CYLINDERS (15 PINS)



P. 58

■ **CILINDRI Ø 22 (SOLO 5 PERNI)**
Ø 22 CYLINDERS (ONLY 5 PINS)



P. 58

SISTEMA BREVETTATO: CHIAVE CON ELEMENTO MOBILE PATENTED SYSTEM: KEY WITH MOBILE ELEMENT

- ✓ **Sistema a 15 perni attivi**
System with 15 active pins
- ✓ **Corpo in ottone nichelato**
Nickel plated brass body
- ✓ **Perni antitrapano**
Anti drilling steel pins
- ✓ **Taglio anti-rottura**
Anti-breakage cut
- ✓ **Perni e controperni in acciaio inox**
Stainless steel pins and top pins
- ✓ **Molle in acciaio inox**
Stainless steel springs
- ✓ **Camma DIN 30° (cilindri da infilare)**
DIN 30° cam (mortice cylinders)
- ✓ **3 chiavi reversibili in alpacca con impugnatura rivestita in plastica, collo lungo e numerazione a codice indiretto sulla testa**
3 reversible keys in nickel silver with plastic-coated grip, long neck numbered on key head
- ✓ **Security card**
Security card
- ✓ **Vite di fissaggio**
Fixing screw

Brevetto Europeo
Scadenza 2042

European Patent
Exp. date 2042

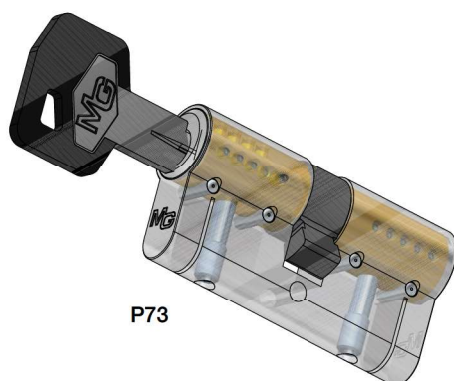

P73

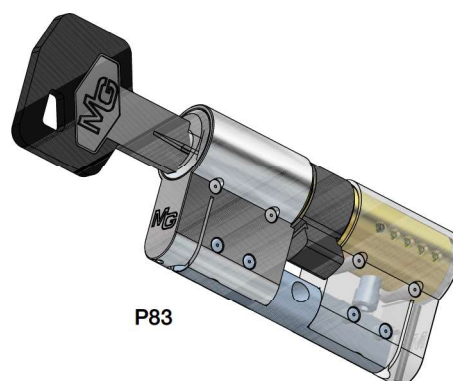

P83

Cilindro per art. 711
Cylinder for art. 711

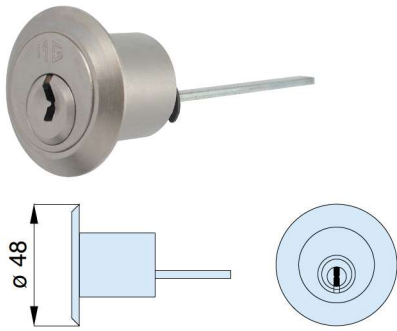

HSP2



▽	A	B	C	D	L	codice code	
15						P51000 N00	1
	con 5 chiavi with 5 keys				 N50	

Cilindro per art. 712
Cylinder for art. 712

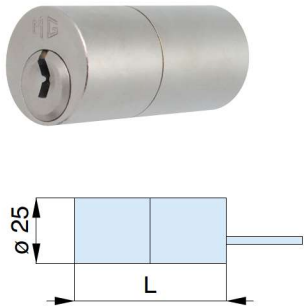

HSP2



▽	A	B	C	D	L	codice code	
15					50	P52500 N00	1
	con 5 chiavi with 5 keys				 N50	

Coppia cilindri
Double rim cylinder

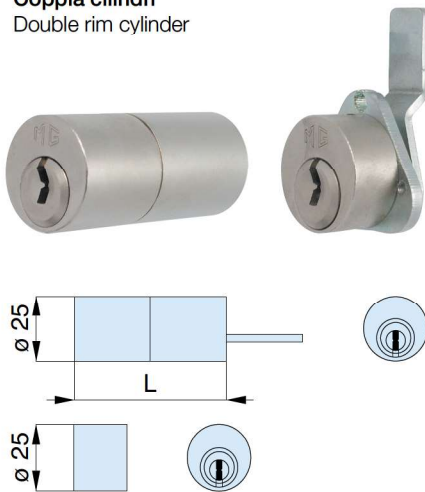

HSP2



▽	A	B	C	D	L	codice code	
15					50	P54500 N00	1
	con 5 chiavi with 5 keys				 N50	

Coppia cilindri
Double rim cylinder

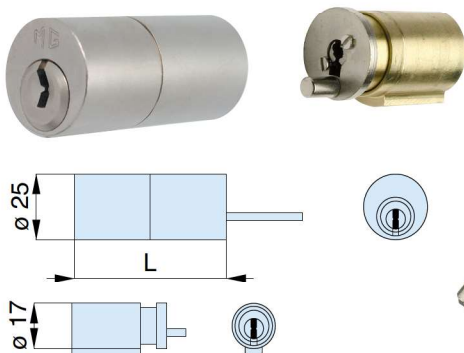

HSP2



▽	A	B	C	D	L	codice code	
15					50	P54501 N00	1
	con 5 chiavi with 5 keys				 N50	





Doppio cilindro
Double cylinder



HSP2

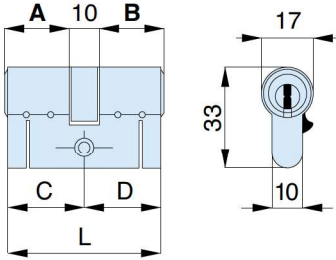

↓	A	B	C	D	L	codice code	↓	
15	27	10	27	31	31	62	P73640 N00	1
15	27	10	31	31	35	66	P73680 N00	1
15	31	10	31	35	35	70	P73720 N00	1
15	27	10	37	31	41	72	P73740 N00	1
15	27	10	41	31	45	76	P73781 N00	1
15	31	10	37	35	41	76	P73782 N00	1
15	31	10	41	35	45	80	P73820 N00	1
15	27	10	47	31	51	82	P73841 N00	1
15	37	10	37	41	41	82	P73842 N00	1
15	27	10	51	31	55	86	P73881 N00	1
15	31	10	47	35	51	86	P73882 N00	1
15	37	10	41	41	45	86	P73883 N00	1
15	31	10	51	35	55	90	P73921 N00	1
15	41	10	41	45	45	90	P73922 N00	1
15	27	10	57	31	61	92	P73941 N00	1
15	37	10	47	41	51	92	P73942 N00	1
15	37	10	51	41	55	96	P73981 N00	1
15	41	10	47	45	51	96	P73982 N00	1
15	31	10	57	35	61	96	P73983 N00	1
15	41	10	51	45	55	100	P73020 N00	1
15	27	10	67	31	71	102	P73041 N00	1
15	37	10	57	41	61	102	P73042 N00	1
15	47	10	47	51	51	102	P73043 N00	1
15	37	10	67	41	71	112	P73142 N00	1
15	47	10	57	51	61	112	P73143 N00	1
15	47	10	67	51	71	122	P73243 N00	1

con 5 chiavi with 5 keys N50
frizionato frictioned NOX

Mezzo cilindro e camma regolabile in 8 posizioni
Half cylinder and adjustable cam in 8 positions



HSP2

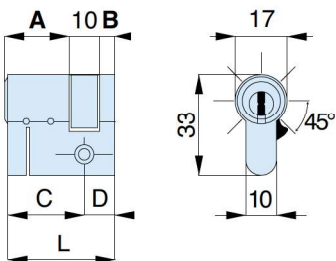

↓	A	B	C	D	L	codice code	↓	
15	27	10	5	31	10	41	P74420 N00	1
15	31	10	5	35	10	45	P74460 N00	1
15	37	10	5	41	10	51	P74520 N00	1
15	41	10	5	45	10	55	P74560 N00	1
15	47	10	5	51	10	61	P74620 N00	1
15	57	10	5	61	10	71	P74720 N00	1
15	67	10	5	71	10	81	P74820 N00	1

con 5 chiavi with 5 keys N50

Doppio cilindro con pomolo ottone nichelato opaco
 Double cylinder with matt nickel-plated brass knob

HSP2

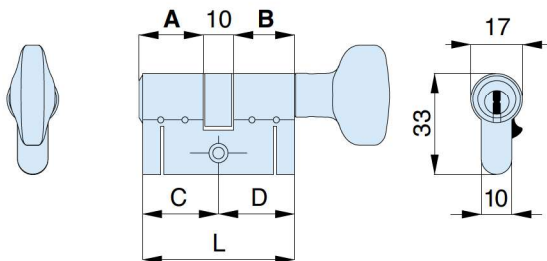

▽	A	B	C	D	L	codice code	1	
15	27	10	27	31	31	62	P79640 N0F	1
15	27	10	31	31	35	66	P79681 N0F	1
15	31	10	27	35	31	66	P79682 N0F	1
15	31	10	31	35	35	70	P79720 N0F	1
15	27	10	37	31	41	72	P79741 N0F	1
15	37	10	27	41	31	72	P79742 N0F	1
15	27	10	41	31	45	76	P79781 N0F	1
15	41	10	27	45	31	76	P79782 N0F	1
15	31	10	37	35	41	76	P79783 N0F	1
15	37	10	31	41	35	76	P79784 N0F	1
15	31	10	41	35	45	80	P79821 N0F	1
15	41	10	31	45	35	80	P79822 N0F	1
15	27	10	47	31	51	82	P79841 N0F	1
15	47	10	27	51	31	82	P79842 N0F	1
15	37	10	37	41	41	82	P79843 N0F	1
15	27	10	51	31	55	86	P79881 N0F	1
15	31	10	47	35	51	86	P79882 N0F	1
15	37	10	41	41	45	86	P79883 N0F	1
15	41	10	37	45	41	86	P79884 N0F	1
15	31	10	51	35	55	90	P79921 N0F	1
15	41	10	41	45	45	90	P79922 N0F	1
15	27	10	57	31	61	92	P79941 N0F	1
15	37	10	47	41	51	92	P79942 N0F	1
15	37	10	51	41	55	96	P79981 N0F	1
15	41	10	47	45	51	96	P79982 N0F	1
15	41	10	51	45	55	100	P79020 N0F	1
15	27	10	67	31	71	102	P79041 N0F	1
15	37	10	57	41	61	102	P79042 N0F	1
15	47	10	47	51	51	102	P79043 N0F	1
15	37	10	67	41	71	112	P79142 N0F	1
15	47	10	57	51	61	112	P79143 N0F	1

con 5 chiavi with 5 keys N5F

Mezzo cilindro per lucchetto di sicurezza P92 - nickel opaco
 Half cylinder for security padlock P92 - matt nickel

HSP2

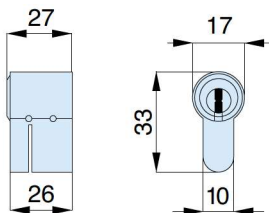

▽	A	B	C	D	L	codice code	1
15						P74270 N00	1

con 5 chiavi with 5 keys N50

CILINDRI DI SICUREZZA DA INFILARE
 security mortice cylinders



Doppio cilindro predisposto pomolo
Double cylinder with knob provision



HSP2

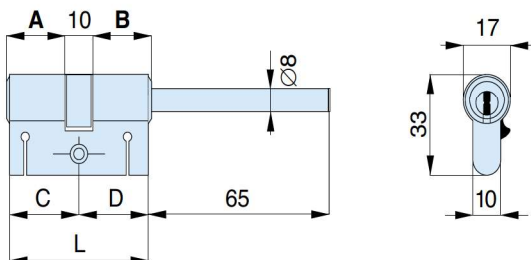

↓	A	B	C	D	L	codice code	↓	
15	27	10	27	31	31	62	P79640 NOL	1
15	31	10	27	35	31	66	P79680 NOL	1
15	37	10	27	41	31	72	P79740 NOL	1
15	41	10	27	45	31	76	P79780 NOL	1
15	47	10	27	51	31	82	P79840 NOL	1
15	51	10	27	55	31	86	P79880 NOL	1
15	57	10	27	61	31	92	P79940 NOL	1
15	67	10	27	71	31	102	P79040 NOL	1

con 5 chiavi with 5 keys N5L

Doppio cilindro predisposto pomolo
Double cylinder with knob provision



HSP2

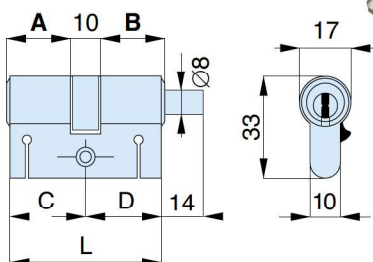

↓	A	B	C	D	L	codice code	↓	
15	27	10	27	31	31	62	P79640 NOC	1
15	27	10	31	31	35	66	P79681 NOC	1
15	31	10	27	35	31	66	P79682 NOC	1
15	31	10	31	35	35	70	P79720 NOC	1
15	27	10	37	31	41	72	P79741 NOC	1
15	37	10	27	41	31	72	P79742 NOC	1
15	27	10	41	31	45	76	P79781 NOC	1
15	41	10	27	45	31	76	P79782 NOC	1
15	31	10	37	35	41	76	P79783 NOC	1
15	37	10	31	41	35	76	P79784 NOC	1
15	31	10	41	35	45	80	P79821 NOC	1
15	41	10	31	45	35	80	P79822 NOC	1
15	27	10	47	31	51	82	P79841 NOC	1
15	47	10	27	51	31	82	P79842 NOC	1
15	37	10	37	41	41	82	P79843 NOC	1
15	27	10	51	31	55	86	P79881 NOC	1
15	31	10	47	35	51	86	P79882 NOC	1
15	37	10	41	41	45	86	P79883 NOC	1
15	41	10	37	45	41	86	P79884 NOC	1
15	31	10	51	35	55	90	P79921 NOC	1
15	41	10	41	45	45	90	P79922 NOC	1
15	27	10	57	31	61	92	P79941 NOC	1
15	37	10	47	41	51	92	P79942 NOC	1
15	37	10	51	41	55	96	P79981 NOC	1
15	41	10	47	45	51	96	P79982 NOC	1
15	41	10	51	45	55	100	P79020 NOC	1
15	27	10	67	31	71	102	P79041 NOC	1
15	37	10	57	41	61	102	P79042 NOC	1
15	47	10	47	51	51	102	P79043 NOC	1
15	37	10	67	41	71	112	P79142 NOC	1
15	47	10	57	51	61	112	P79143 NOC	1

con 5 chiavi with 5 keys N5C

Doppio cilindro MODULARE
MODULAR double cylinder



HSP2

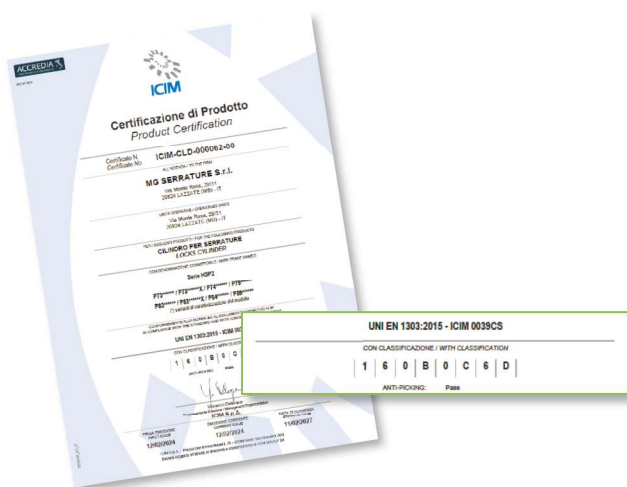
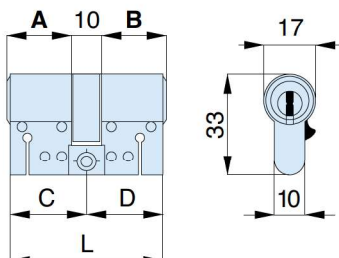

▽	A	B	C	D	L	codice code	1	
15	27	10	27	31	31	62	P83640 N00	1
15	27	10	31	31	35	66	P83680 N00	1
15	31	10	31	35	35	70	P83720 N00	1
15	27	10	37	31	41	72	P83740 N00	1
15	27	10	41	31	45	76	P83781 N00	1
15	31	10	37	35	41	76	P83782 N00	1
15	31	10	41	35	45	80	P83820 N00	1
15	27	10	47	31	51	82	P83841 N00	1
15	37	10	37	41	41	82	P83842 N00	1
15	27	10	51	31	55	86	P83881 N00	1
15	31	10	47	35	51	86	P83882 N00	1
15	37	10	41	41	45	86	P83883 N00	1
15	31	10	51	35	55	90	P83921 N00	1
15	41	10	41	45	45	90	P83922 N00	1
15	27	10	57	31	61	92	P83941 N00	1
15	37	10	47	41	51	92	P83942 N00	1
15	37	10	51	41	55	96	P83981 N00	1
15	41	10	47	45	51	96	P83982 N00	1
15	31	10	57	35	61	96	P83983 N00	1
15	41	10	51	45	55	100	P83020 N00	1
15	27	10	67	31	71	102	P83041 N00	1
15	37	10	57	41	61	102	P83042 N00	1
15	47	10	47	51	51	102	P83043 N00	1
15	27	10	77	31	81	112	P83141 N00	1
15	37	10	67	41	71	112	P83142 N00	1
15	47	10	57	51	61	112	P83143 N00	1
15	47	10	67	51	71	122	P83243 N00	1

con 5 chiavi with 5 keys N50
frizionato frictioned NOX

Cilindro valutato in base alla norma Europea EN 1303:2015
Cylinder measured by means of the EN 1303:2015 standard

Con la versione modulare si possono produrre cilindri fino alla lunghezza totale di 212 mm. (121-91)
With the modular version, it's possible to realize cylinders till the following total length: 212 mm (121-91)

Mezzo cilindro MODULARE con taglio e camma regolabile in 8 posizioni
MODULAR half cylinder with cut and adjustable cam in 8 positions



HSP2

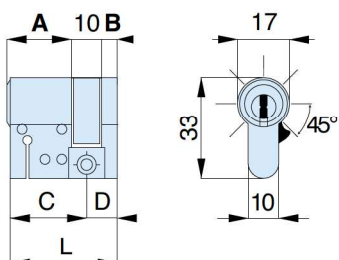

▽	A	B	C	D	L	codice code	1	
15	27	10	5	31	10	41	P84420 N00	1
15	31	10	5	35	10	45	P84460 N00	1
15	37	10	5	41	10	51	P84520 N00	1
15	41	10	5	45	10	55	P84560 N00	1
15	47	10	5	51	10	61	P84620 N00	1
15	57	10	5	61	10	71	P84720 N00	1
15	67	10	5	71	10	81	P84820 N00	1
15	77	10	5	81	10	91	P84920 N00	1

con 5 chiavi with 5 keys N50

CILINDRI DI SICUREZZA DA INFILARE
security mortice cylinders



Doppio cilindro MODULARE con pomolo ottone nichelato opaco con taglio
MODULAR double cylinder with matt nickel-plated brass knob with cut



HSP2

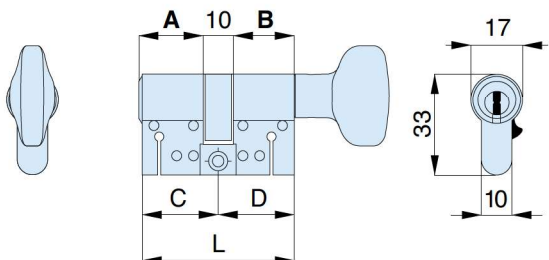

	A	B	C	D	L	codice code	
15 27 10 27	31	31	62			P89640 NOF	1
15 27 10 31	31	35	66			P89681 NOF	1
15 31 10 27	35	31	66			P89682 NOF	1
15 31 10 31	35	35	70			P89720 NOF	1
15 27 10 37	31	41	72			P89741 NOF	1
15 37 10 27	41	31	72			P89742 NOF	1
15 27 10 41	31	45	76			P89781 NOF	1
15 41 10 27	45	31	76			P89782 NOF	1
15 31 10 37	35	41	76			P89783 NOF	1
15 37 10 31	41	35	76			P89784 NOF	1
15 31 10 41	35	45	80			P89821 NOF	1
15 41 10 31	45	35	80			P89822 NOF	1
15 27 10 47	31	51	82			P89841 NOF	1
15 47 10 27	51	31	82			P89842 NOF	1
15 37 10 37	41	41	82			P89843 NOF	1
15 27 10 51	31	55	86			P89881 NOF	1
15 31 10 47	35	51	86			P89882 NOF	1
15 37 10 41	41	45	86			P89883 NOF	1
15 41 10 37	45	41	86			P89884 NOF	1
15 31 10 51	35	55	90			P89921 NOF	1
15 41 10 41	45	45	90			P89922 NOF	1
15 27 10 57	31	61	92			P89941 NOF	1
15 37 10 47	41	51	92			P89942 NOF	1
15 37 10 51	41	55	96			P89981 NOF	1
15 41 10 47	45	51	96			P89982 NOF	1
15 41 10 51	45	55	100			P89020 NOF	1
15 27 10 67	31	71	102			P89041 NOF	1
15 37 10 57	41	61	102			P89042 NOF	1
15 47 10 47	51	51	102			P89043 NOF	1
15 27 10 77	31	81	112			P89141 NOF	1
15 37 10 67	41	71	112			P89142 NOF	1
15 47 10 57	51	61	112			P89143 NOF	1
					 N5F	

con 5 chiavi with 5 keys

..... N5F

Doppio cilindro MODULARE predisposto pomolo con taglio
MODULAR double cylinder with knob provision with cut



HSP2

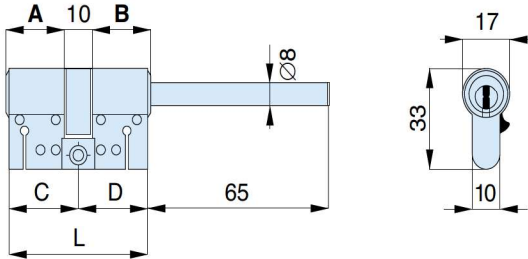

▽	A	B	C	D	L	codice code		
15	27	10	27	31	31	62	P89640 NOL	1
15	31	10	27	35	31	66	P89680 NOL	1
15	37	10	27	41	31	72	P89740 NOL	1
15	41	10	27	45	31	76	P89780 NOL	1
15	47	10	27	51	31	82	P89840 NOL	1
15	51	10	27	55	31	86	P89880 NOL	1
15	57	10	27	61	31	92	P89940 NOL	1
15	67	10	27	71	31	102	P89040 NOL	1
15	77	10	27	81	31	112	P89140 NOL	1

con 5 chiavi with 5 keys N5L

Doppio cilindro MODULARE predisposto pomolo con taglio
MODULAR double cylinder with knob provision with cut



HSP2

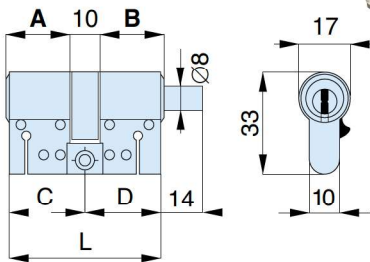

▽	A	B	C	D	L	codice code		
15	27	10	27	31	31	62	P89640 NOC	1
15	27	10	31	31	35	66	P89681 NOC	1
15	31	10	27	35	31	66	P89682 NOC	1
15	31	10	31	35	35	70	P89720 NOC	1
15	27	10	37	31	41	72	P89741 NOC	1
15	37	10	27	41	31	72	P89742 NOC	1
15	27	10	41	31	45	76	P89781 NOC	1
15	41	10	27	45	31	76	P89782 NOC	1
15	31	10	37	35	41	76	P89783 NOC	1
15	37	10	31	41	35	76	P89784 NOC	1
15	31	10	41	35	45	80	P89821 NOC	1
15	41	10	31	45	35	80	P89822 NOC	1
15	27	10	47	31	51	82	P89841 NOC	1
15	47	10	27	51	31	82	P89842 NOC	1
15	37	10	37	41	41	82	P89843 NOC	1
15	27	10	51	31	55	86	P89881 NOC	1
15	31	10	47	35	51	86	P89882 NOC	1
15	37	10	41	41	45	86	P89883 NOC	1
15	41	10	37	45	41	86	P89884 NOC	1
15	31	10	51	35	55	90	P89921 NOC	1
15	41	10	41	45	45	90	P89922 NOC	1
15	27	10	57	31	61	92	P89941 NOC	1
15	37	10	47	41	51	92	P89942 NOC	1
15	37	10	51	41	55	96	P89981 NOC	1
15	41	10	47	45	51	96	P89982 NOC	1
15	41	10	51	45	55	100	P89020 NOC	1
15	27	10	67	31	71	102	P89041 NOC	1
15	37	10	57	41	61	102	P89042 NOC	1
15	47	10	47	51	51	102	P89043 NOC	1
15	27	10	77	31	81	112	P89141 NOC	1
15	37	10	67	41	71	112	P89142 NOC	1
15	47	10	57	51	61	112	P89143 NOC	1

con 5 chiavi with 5 keys N5C



Doppio cilindro ovale
Double oval cylinder



HSP2

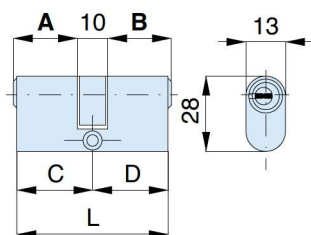

Per cilindri P58 sono previsti solo impianti a chiave uguale
For the cylinders P58 only key-alike systems are available

	A	B	C	D	L	codice code		
5	27	10	27	31	31	62	P58640 N00	1

con 5 chiavi with 5 keys

..... N50

Doppio cilindro Ø 26
Double cylinder Ø 26



HSP2

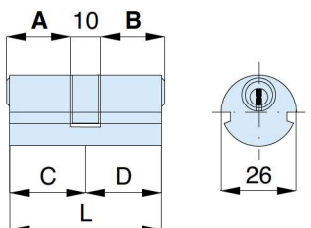

	A	B	C	D	L	codice code		
15	27	10	27	31	31	62	P59640 N00	1
15	27	10	47	31	51	82	P59841 N00	1

con 5 chiavi with 5 keys

..... N50

Doppio cilindro Ø 22
Double cylinder Ø 22



HSP2

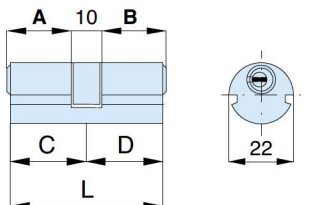

	A	B	C	D	L	codice code		
5	27	10	27	31	31	62	P60640 N00	1

con 5 chiavi with 5 keys

..... N50

Per cilindri P60 sono previsti solo impianti a chiave uguale
For the cylinders P60 only key-alike systems are available