

■ FERROGLIETTI
MULTI THROW LOCKS



P. 100

■ SERRATURE DA INFILARE
MORTICE LOCKS



P. 102

4 mandate - pomolo interno - catenaccio in acciaio zincato

4 throws - inside knob - zinc plated steel deadbolt

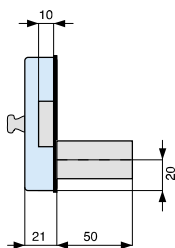
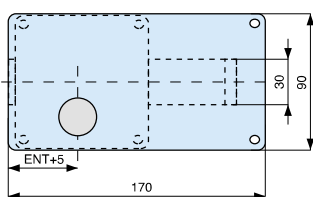
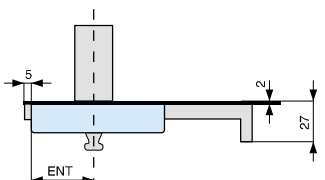

Complete di contropiastra e borchia in ottone
Provided with striking plate and brass rose

con cilindro
with cylinder

codice code

ENT

euro



011.00.0



701400 000

2 24

701500 000

2 24

012.35.0

702403 000

2 24

012.40.0

702404 000

2 24

012.50.0

702405 000

2 24

012.60.0

702406 000

2 24

012.70.0

702407 000

2 24

012.35.0

702503 000

2 24

012.40.0

702504 000

2 24

012.50.0

702505 000

2 24

012.60.0

702506 000

2 24

012.70.0

702507 000

2 24

versione "industriale" con borchia senza contropiastra
industrial type with rose without striking plate

012.50.0

702505 006

24

6 mandate - pomolo interno - catenaccio in acciaio zincato

6 throws - inside knob - zinc plated steel deadbolt

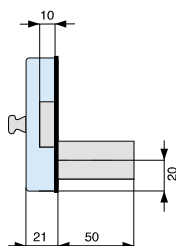
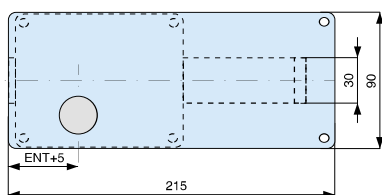
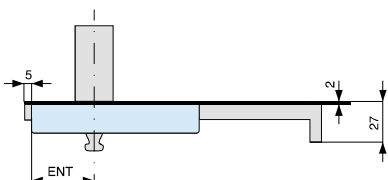

Complete di contropiastra e borchia in ottone
Provided with striking plate and brass rose

con cilindro
with cylinder

codice code

ENT

euro



011.00.0



711400 000

2 24

711500 000

2 24

711600 000

2 24

012.35.0

712403 000

2 24

012.40.0

712404 000

2 24

012.50.0

712405 000

2 24

012.60.0

712406 000

2 24

012.70.0

712407 000

2 24

012.35.0

712503 000

2 24

012.40.0

712504 000

2 24

012.50.0

712505 000

2 24

012.60.0

712506 000

2 24

012.70.0

712507 000

2 24

012.35.0

712603 000

2 24

012.40.0

712604 000

2 24

012.50.0

712605 000

2 24

012.60.0

712606 000

2 24

012.70.0

712607 000

2 24

versione "industriale" con borchia senza contropiastra
industrial type with rose without striking plate

012.50.0

712505 006

24

6 mandate - cil. interno 010.18.0 cil. esterno 012.50.0 - cat. in acciaio zincato
 6 throws - inside cylinder 010.18.0 outside cyl. 012.50.0 - zinc plated steel deadbolt



Complete di contropiastra e borchia in ottone
 Provided with striking plate and brass rose

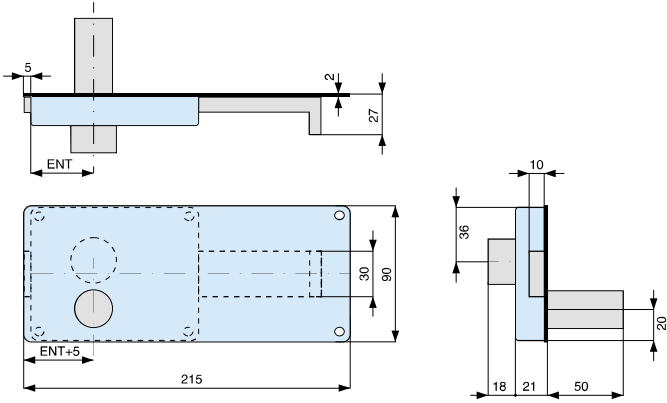

con cilindro
with cylinder



codice code

ENT

euro



713505 000

2 24

713605 000

2 24

5 1/2 mandate - pomolo interno - catenaccio in acciaio zincato
 5 1/2 throws - inside knob - zinc plated steel deadbolt



Complete di contropiastra e borchia in ottone
 Provided with striking plate and brass rose

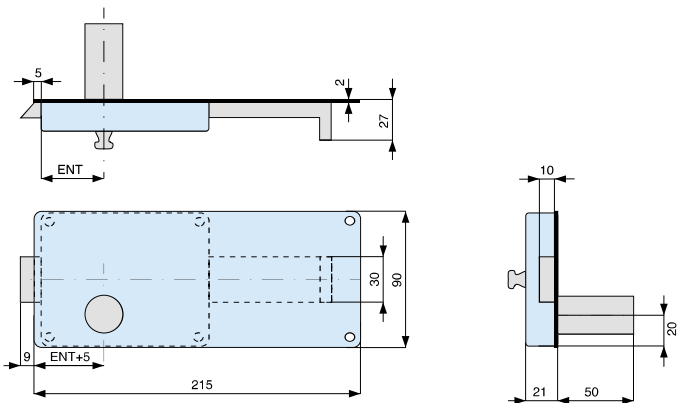

con cilindro
with cylinder

011.00.0



codice code

ENT

euro



714500 000

2 24

714600 000

2 24



012.50.0

715505 000

2 24

012.50.0

715605 000

2 24

FERROGLIETTI DA APPLICARE
 multi throw rim locks

2 mandate e scrocco reversibile - catenacci in ottone
2 throws and reversible latch bolt - brass deadbolts

■ mm. 8

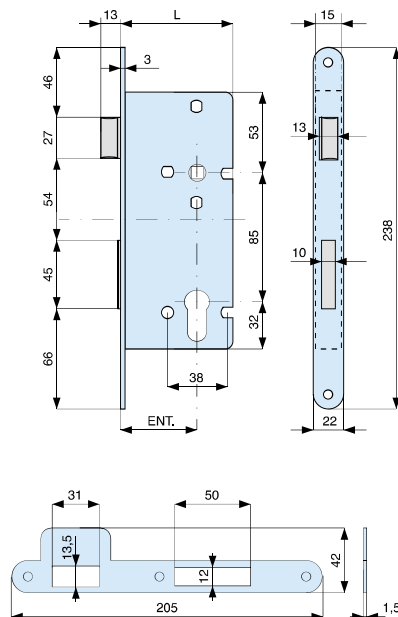

ENT.	40	45	50	60	70	80
L	64	69	74	84	94	104

frontale
forend

codice code
ENT

euro

frontale forend	codice code ENT	euro
cilindro da ordinare a parte cylinder to be ordered separately	acc. ott. vern. brass pl. steel	
	740401 AL1	1 40
	740451 AL1	1 40
	740501 AL1	1 40
	740601 AL1	1 40
	740701 AL1	1 40
	740801 AL1	1 40
acc. nichelato nickel pl. steel	740 AN1	1 40
acc. inox stainless steel	740 AX1	1 40
ottone luc. vern. polished brass	740 LV1	1 40
ottone cromo luc. pol. chr. brass	740 CL1	1 40
ottone cromo sat. satin chr. brass	740 CS1	1 40
ottone bronzato bronze brass	740 LB1	1 40

2 mandate e scrocco reversibile - catenacci in ottone
2 throws and reversible latch bol - brass deadbolts

■ mm. 8

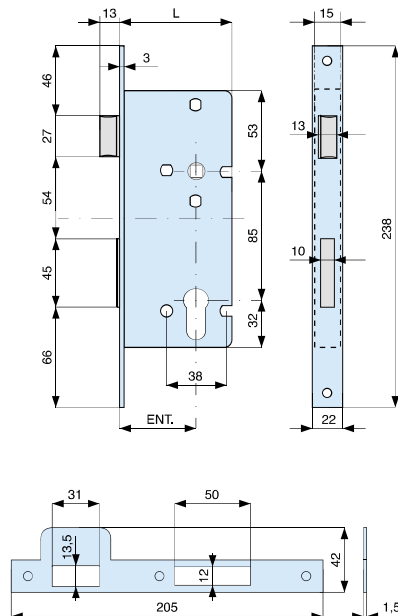

ENT.	40	45	50	60	70	80
L	64	69	74	84	94	104

frontale
forend

codice code
ENT

euro

frontale forend	codice code ENT	euro
cilindro da ordinare a parte cylinder to be ordered separately	acc. ott. vern. brass pl. steel	
	740402 AL1	1 40
	740452 AL1	1 40
	740502 AL1	1 40
	740602 AL1	1 40
	740702 AL1	1 40
	740802 AL1	1 40
acc. nichelato nickel pl. steel	740 AN1	1 40
acc. inox stainless steel	740 AX1	1 40
ottone luc. vern. polished brass	740 LV1	1 40
ottone cromo luc. pol. chr. brass	740 CL1	1 40
ottone cromo sat. satin chr. brass	740 CS1	1 40
ottone bronzato bronze brass	740 LB1	1 40

2 mandate e rullo separato - catenacci in ottone
2 throws and separate roller bolt - brass deadbolts

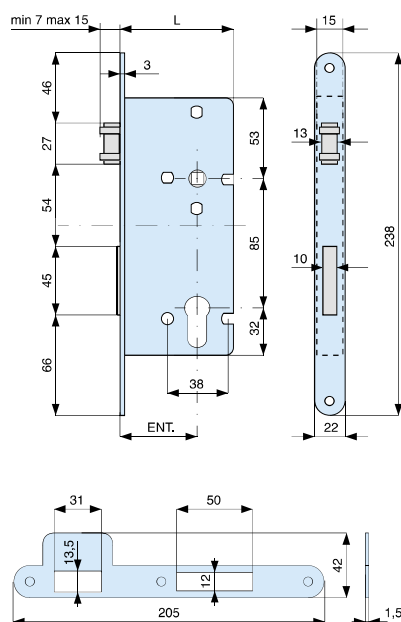

ENT.	40	45	50	60	70	80
L	64	69	74	84	94	104

2 mandate e rullo separato - catenacci in ottone
2 throws and separate roller bolt - brass deadbolts

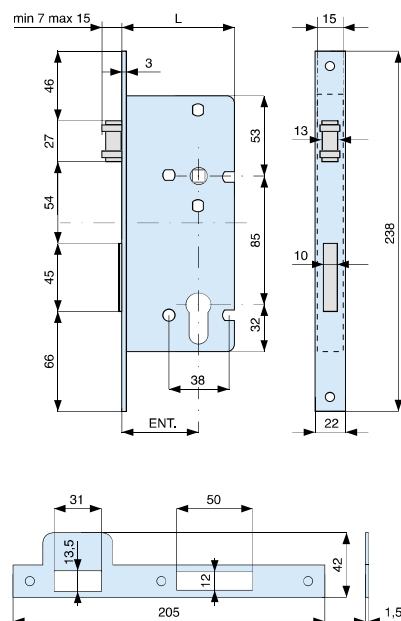

ENT.	40	45	50	60	70	80
L	64	69	74	84	94	104

frontale forend	codice code ENT		euro	
cilindro da ordinare a parte cylinder to be ordered separately	acc. ott. vern. brass pl. steel			
		741401 AL1	1	40
		741451 AL1	1	40
		741501 AL1	1	40
		741601 AL1	1	40
		741701 AL1	1	40
		741801 AL1	1	40
acc. nichelato nickel pl. steel	741	AN1	1	40
acc. inox stainless steel	741	AX1	1	40
ottone luc. vern. polished brass	741	LV1	1	40
ottone cromo luc. pol. chr. brass	741	CL1	1	40
ottone cromo sat. satin chr. brass	741	CS1	1	40
ottone bronzato bronze brass	741	LB1	1	40

frontale forend	codice code ENT		euro	
cilindro da ordinare a parte cylinder to be ordered separately	acc. ott. vern. brass pl. steel			
		741402 AL1	1	40
		741452 AL1	1	40
		741502 AL1	1	40
		741602 AL1	1	40
		741702 AL1	1	40
		741802 AL1	1	40
acc. nichelato nickel pl. steel	741	AN1	1	40
acc. inox stainless steel	741	AX1	1	40
ottone luc. vern. polished brass	741	LV1	1	40
ottone cromo luc. pol. chr. brass	741	CL1	1	40
ottone cromo sat. satin chr. brass	741	CS1	1	40
ottone bronzato bronze brass	741	LB1	1	40



1 mandata e scrocco reversibile - catenacci in ottone

1 throw and reversible latch bolt - brass deadbolts

Doppio quadro ■ mm. 8 per bagno

Double square hole ■ mm. 8 for bathroom

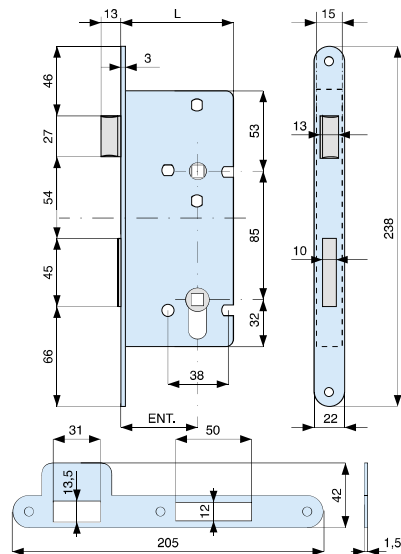

ENT.	40	45	50	60	70	80
L	64	69	74	84	94	104

frontale
forend

codice code
ENT

euro



cilindro da ordinare a parte cylinder to be ordered separately	acc. ott. vern. brass pl. steel			
		742401	AL1	1 40
		742451	AL1	1 40
		742501	AL1	1 40
		742601	AL1	1 40
		742701	AL1	1 40
		742801	AL1	1 40
	acc. nichelato nickel pl. steel	742	AN1	1 40
	acc. inox stainless steel	742	AX1	1 40
	ottone luc. vern. polished brass	742	LV1	1 40
	ottone cromo luc. pol. chr. brass	742	CL1	1 40
	ottone cromo sat. satin chr. brass	742	CS1	1 40
	ottone bronzato bronze brass	742	LB1	1 40

1 mandata e scrocco reversibile - catenacci in ottone

1 throw and reversible latch bolt - brass deadbolts

Doppio quadro ■ mm. 8 per bagno

Double square hole ■ mm. 8 for bathroom

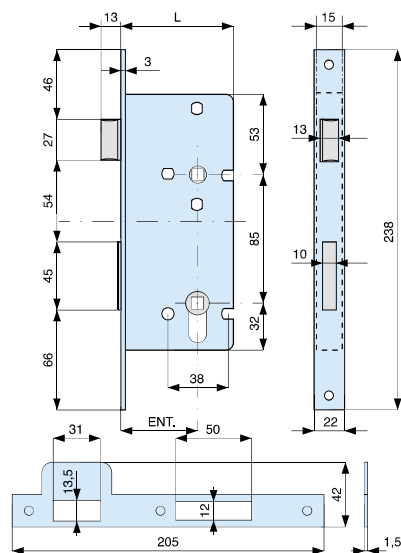

ENT.	40	45	50	60	70	80
L	64	69	74	84	94	104

frontale
forend

codice code
ENT

euro



cilindro da ordinare a parte cylinder to be ordered separately	acc. ott. vern. brass pl. steel			
		742402	AL1	1 40
		742452	AL1	1 40
		742502	AL1	1 40
		742602	AL1	1 40
		742702	AL1	1 40
		742802	AL1	1 40
	acc. nichelato nickel pl. steel	742	AN1	1 40
	acc. inox stainless steel	742	AX1	1 40
	ottone luc. vern. polished brass	742	LV1	1 40
	ottone cromo luc. pol. chr. brass	742	CL1	1 40
	ottone cromo sat. satin chr. brass	742	CS1	1 40
	ottone bronzato bronze brass	742	LB1	1 40